

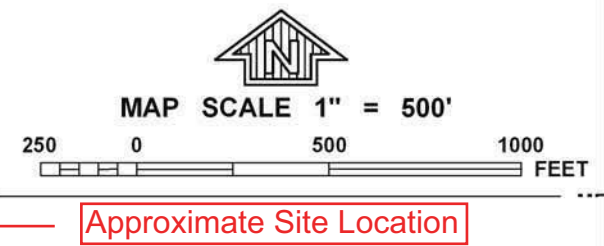

RRE0027856MF - 26
 Ave At Port Imperial,
 Apartment B37, West New
 York Town, New Jersey

Town of
 West New York
 340229



NATIONAL FLOOD INSURANCE PROGRAM

PANEL 0044D

FIRM
 FLOOD INSURANCE RATE MAP

**HUDSON COUNTY,
 NEW JERSEY
 (ALL JURISDICTIONS)**

PANEL 44 OF 118

(SEE MAP INDEX FOR FIRM PANEL LAYOUT)

CONTAINS:

COMMUNITY	NUMBER	PANEL	SUFFIX
HOBOKEN, CITY OF	340222	0044	D
NORTH BERGEN, TOWNSHIP OF	340225	0044	D
WEEHAWKEN, TOWNSHIP OF	340228	0044	D
WEST NEW YORK, TOWN OF	340229	0044	D

Notice to User: The Map Number shown below should be used when placing map orders; the Community Number shown above should be used on insurance applications for the subject community.

**MAP NUMBER
 34017C0044D**

**EFFECTIVE DATE
 AUGUST 16, 2006**

Federal Emergency Management Agency



This is an official copy of a portion of the above referenced flood map. It was extracted using F-MIT On-Line. This map does not reflect changes or amendments which may have been made subsequent to the date on the title block. For the latest product information about National Flood Insurance Program flood maps check the FEMA Flood Map Store at www.msc.fema.gov