



State of New Jersey
Department of Environmental Protection
Geological Survey



Information Disclaimer

The State of New Jersey makes great effort to provide secure, accurate and complete information. However, portions of the information contained here may be incorrect or not current.

The State of New Jersey, its officers, employees or agents shall not be liable for damages or losses of any kind arising out of or in connection with the use or performance of information, including but not limited to, damages or losses caused by reliance upon the accuracy or timeliness of any such information, or damages incurred from the viewing, distributing, or copying of those materials.

The materials and information provided here are provided "as is." No warranty of any kind, implied, expressed, or statutory, including but not limited to the warranties of non-infringement of third party rights, title, merchantability, fitness for a particular purpose, and freedom from computer virus, is given with respect to the contents of this document.

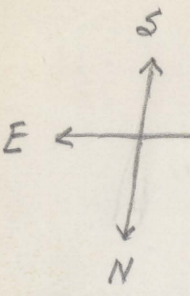

PRESIDENT AND TECHNICAL DIRECTOR
 WALTER HORNBURCH
 VICE PRESIDENT
 CHARLES PERRY
 Associates:
 HUGO HORNBURCH
 WILLIAM DONALD

309 Conland Street
 WEIGHERS, SAMPLERS, ASSAYERS, CHEMISTS
 STANDARD TESTING LABORATORIES, INC.
 Belleville, N. J.



POCHUCK MINE

JULY 10-1942

W.H.

DIAMOND DRILL PROSPECT HOLES - POCHUCK MINE - McAFEE - NEW JERSEY

DRILL HOLE A

DATE DRILLED	LOG	DEPTH	CORE	REMARKS
		0'-0"		SURFACE.
MAR. 17		22'-0"	NONE	Drove casing through soft broken rock. (LIMONITE).
MAR. 18		22'-0"	NONE	TIMBER
		29'-0"	NONE	VOID Chopped & drove casing from 22'-0" to 29'-0"
		31'-0"	NONE	VOID
MAR. 19		36'-0"	NONE	Chopped & drove casing.
		41'-0"	NONE	VOID
		48'-0"	NONE	VOID
MAR. 20		56'-0"	NONE	Chopped & washed. Formation too soft to core.
		68'-0"	NONE	HARD ROCK. (IRON ORE).
MAR. 21		72'-0"	NONE	Drilled soft rock. Hole started to cave.
		75'-0"	NONE	

DRILL HOLE A (Continued)

DATE DRILLED	LOG	DEPTH	CORE	REMARKS
MAR. 24 - 25 - 26		84'-0"	NONE	Like core, couldn't drive casing. Brake off. Surface and broke off again. Put in new string to 88'-0".
MAR. 27		96'-0"	NONE	Drilled & chopped through soft rock. (LIMONITE)
		120'-0"	NONE	
MAR. 29		162'-0"	NONE	Chopped & washed through soft rock.

DRILL HOLE A (Continued)

DATE DRILLED	LOG	DEPTH	CORE	REMARKS
MAR. 30		176'-0"	NONE	Hole caved in. Had to wash from 176'-0"
MAR. 31		200'-0"	NONE	Hole caved in. Had to wash from 175'-0". Hard at 205'-0".
		205'-0"	NONE	Hard Red Rock.
APR. 1		240'-0"	NONE	Drilled soft rock. Too soft to core. More mica in formation from 205'-0".
APR. 2		260'-0"	NONE	Drilled soft rock. Too soft to core.
APR. 3		266'-0"	NONE	Drilled soft rock. To 266'-0" stand at 244'-0". APR. 4. Hole caved from 160'-0". APR. 5. Hole ordered stopped by Mr. Smith.

COMPLETED - TOTAL DEPTH 266'-0"
ORDERED STOPPED BY MR. SMITH APR. 5, 1942.

DRILL HOLE B

DATE DRILLED	LOG	DEPTH	CORE	REMARKS
		0'-0"		SURFACE.
APR. 8		22'-0"	NONE	Drove 4" diameter casing through compact sand & gravel.
APR. 9		20'-0"	NONE	Drove casing through sand & gravel.
APR. 10		42'-0"	NONE	Drilled broken, seamy limestone.
APR. 11		55'-0"	NONE	On Apr. 11th could not drill deeper than 55'-0" so started new hole and drove casing to 66'-0". Drilled with 3" bit bit to 55'-0".
APR. 13		66'-0"	NONE	Drilled seamy white limestone with red intrusions.
APR. 14		85'-0"	NONE	Drilled seamy limestone. Red intrusions.
APR. 15		90'-0"	NONE	Seamy & broken limestone. Red intrusions.
APR. 16		100'-0"	NONE	Seamy & broken limestone. N.B. WATER FLOWS FROM HOLE AT RATE OF 6 GALS. PER MIN. RED INTRUSIONS. BLANKED.
APR. 17		105'-0"	NONE	Seamy & broken limestone. Red intrusions.
APR. 18		112'-0"	NONE	VERY SEAMY LIMESTONE. RED INTRUSIONS. HOLE CAVED.
APR. 19		117'-0"	NONE	VERY SEAMY LIMESTONE. RED INTRUSIONS. BLANKED.
APR. 20		121'-0"	NONE	SEAMY LIMESTONE. FEWER RED INTRUSIONS THAN ABOVE.
APR. 21		131'-0"	NONE	SOFT & SEAMY LIMESTONE. HOLE CAVED BADLY.
APR. 22		147'-0"	NONE	VERY SOFT LIMESTONE. HOLE CAVED BADLY.

Hole ordered stopped by Mr. Smith on Apr. 18, 42. TOTAL DEPTH 158'-0"

DRILL HOLE C

DATE DRILLED	LOG	DEPTH	CORE	REMARKS
		0'-0"		SURFACE.
APRIL 21		10'-0"	NONE	BROWN SAND & CLAY.
APRIL 22		45'-0"	NONE	BROWN SAND & CLAY.
APRIL 23		45'-0"	NONE	SOFT ROCK. DRILLED.
APRIL 24		15'-0"	NONE	HARD ROCK (IRON ORE)
APRIL 25		18'-0"	NONE	SOFT ROCK. DRILLED.
APRIL 26		29'-0"	NONE	SOFT ROCK. DRILLED.
APRIL 27		45'-0"	NONE	SOFT ROCK. DRILLED.
APRIL 28		45'-0"	NONE	SOFT ROCK. DRILLED.
APRIL 29		45'-0"	NONE	SOFT ROCK. DRILLED.

Hole completed. Total depth 95'-0"

DRILL HOLE D

DATE DRILLED	LOG	DEPTH	CORE	REMARKS
APRIL 24		16'-0"	NONE	BROWN SAND & CLAY.
APRIL 25		16'-0"	NONE	BROWN SAND & CLAY.
APRIL 26		16'-0"	NONE	BROWN SAND & CLAY.
APRIL 27		16'-0"	NONE	BROWN SAND & CLAY.
APRIL 28		16'-0"	NONE	BROWN SAND & CLAY.
APRIL 29		16'-0"	NONE	BROWN SAND & CLAY.
APRIL 30		16'-0"	NONE	BROWN SAND & CLAY.
MAY 1		16'-0"	NONE	BROWN SAND & CLAY.
MAY 2		16'-0"	NONE	BROWN SAND & CLAY.
MAY 3		16'-0"	NONE	BROWN SAND & CLAY.
MAY 4		16'-0"	NONE	BROWN SAND & CLAY.
MAY 5		16'-0"	NONE	BROWN SAND & CLAY.
MAY 6		16'-0"	NONE	BROWN SAND & CLAY.
MAY 7		16'-0"	NONE	BROWN SAND & CLAY.
MAY 8		16'-0"	NONE	BROWN SAND & CLAY.
MAY 9		16'-0"	NONE	BROWN SAND & CLAY.
MAY 10		16'-0"	NONE	BROWN SAND & CLAY.
MAY 11		16'-0"	NONE	BROWN SAND & CLAY.
MAY 12		16'-0"	NONE	BROWN SAND & CLAY.
MAY 13		16'-0"	NONE	BROWN SAND & CLAY.
MAY 14		16'-0"	NONE	BROWN SAND & CLAY.
MAY 15		16'-0"	NONE	BROWN SAND & CLAY.
MAY 16		16'-0"	NONE	BROWN SAND & CLAY.
MAY 17		16'-0"	NONE	BROWN SAND & CLAY.
MAY 18		16'-0"	NONE	BROWN SAND & CLAY.
MAY 19		16'-0"	NONE	BROWN SAND & CLAY.
MAY 20		16'-0"	NONE	BROWN SAND & CLAY.
MAY 21		16'-0"	NONE	BROWN SAND & CLAY.
MAY 22		16'-0"	NONE	BROWN SAND & CLAY.
MAY 23		16'-0"	NONE	BROWN SAND & CLAY.
MAY 24		16'-0"	NONE	BROWN SAND & CLAY.
MAY 25		16'-0"	NONE	BROWN SAND & CLAY.
MAY 26		16'-0"	NONE	BROWN SAND & CLAY.
MAY 27		16'-0"	NONE	BROWN SAND & CLAY.
MAY 28		16'-0"	NONE	BROWN SAND & CLAY.
MAY 29		16'-0"	NONE	BROWN SAND & CLAY.
MAY 30		16'-0"	NONE	BROWN SAND & CLAY.
JUN 1		16'-0"	NONE	BROWN SAND & CLAY.
JUN 2		16'-0"	NONE	BROWN SAND & CLAY.
JUN 3		16'-0"	NONE	BROWN SAND & CLAY.
JUN 4		16'-0"	NONE	BROWN SAND & CLAY.
JUN 5		16'-0"	NONE	BROWN SAND & CLAY.
JUN 6		16'-0"	NONE	BROWN SAND & CLAY.
JUN 7		16'-0"	NONE	BROWN SAND & CLAY.
JUN 8		16'-0"	NONE	BROWN SAND & CLAY.
JUN 9		16'-0"	NONE	BROWN SAND & CLAY.
JUN 10		16'-0"	NONE	BROWN SAND & CLAY.
JUN 11		16'-0"	NONE	BROWN SAND & CLAY.
JUN 12		16'-0"	NONE	BROWN SAND & CLAY.
JUN 13		16'-0"	NONE	BROWN SAND & CLAY.
JUN 14		16'-0"	NONE	BROWN SAND & CLAY.
JUN 15		16'-0"	NONE	BROWN SAND & CLAY.
JUN 16		16'-0"	NONE	BROWN SAND & CLAY.
JUN 17		16'-0"	NONE	BROWN SAND & CLAY.
JUN 18		16'-0"	NONE	BROWN SAND & CLAY.
JUN 19		16'-0"	NONE	BROWN SAND & CLAY.
JUN 20		16'-0"	NONE	BROWN SAND & CLAY.
JUN 21		16'-0"	NONE	BROWN SAND & CLAY.
JUN 22		16'-0"	NONE	BROWN SAND & CLAY.
JUN 23		16'-0"	NONE	BROWN SAND & CLAY.
JUN 24		16'-0"	NONE	BROWN SAND & CLAY.
JUN 25		16'-0"	NONE	BROWN SAND & CLAY.
JUN 26		16'-0"	NONE	BROWN SAND & CLAY.
JUN 27		16'-0"	NONE	BROWN SAND & CLAY.
JUN 28		16'-0"	NONE	BROWN SAND & CLAY.
JUN 29		16'-0"	NONE	BROWN SAND & CLAY.
JUN 30		16'-0"	NONE	BROWN SAND & CLAY.

Hole completed. Total depth 94'-0"

NOTE - DIAMETER CORE EXTRACTED 1 3/8". ALL CORE SAMPLES ARE DRYED AND LABELLED FOR READY IDENTIFICATION.

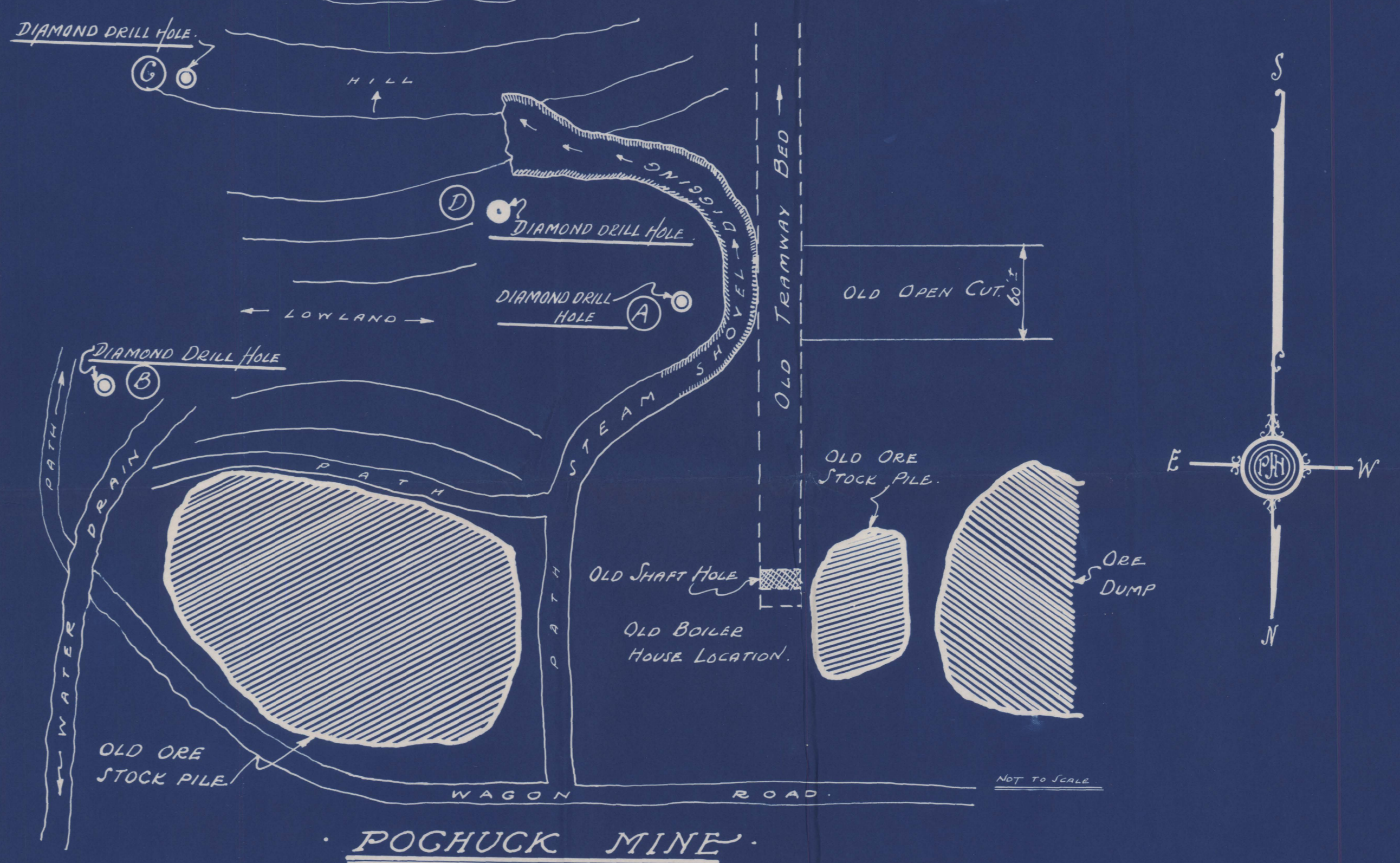

DIAMOND DRILL PROSPECTING
DONE BY
PHILIP J. HEALEY, INC.
CORE DRILL CONTRACTORS
207 BALDWIN AVE. JERSEY CITY • 11 PARK PLACE, N. Y. C.

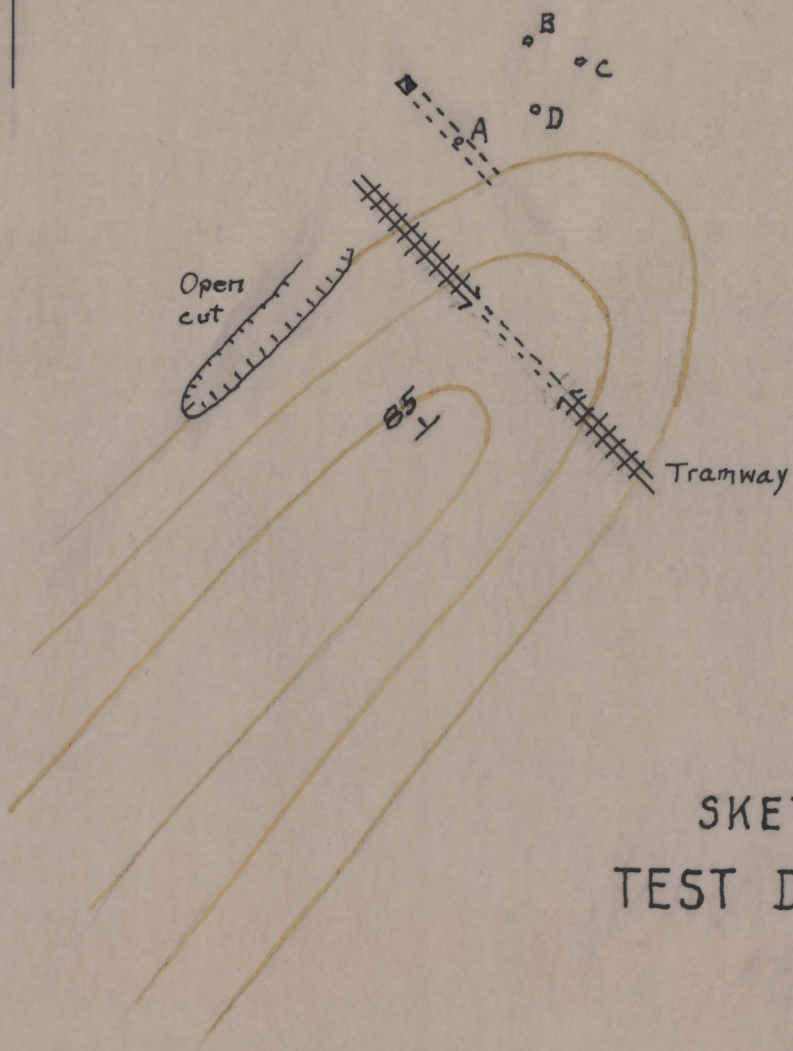

SKETCH TO SHOW POSITION OF
TEST DRILLHOLES AT POCHUCK MINE,
SUSSEX COUNTY, N.J.

4-10-44

MEJ