



State of New Jersey
Department of Environmental Protection
Geological Survey



Information Disclaimer

The State of New Jersey makes great effort to provide secure, accurate and complete information. However, portions of the information contained here may be incorrect or not current.

The State of New Jersey, its officers, employees or agents shall not be liable for damages or losses of any kind arising out of or in connection with the use or performance of information, including but not limited to, damages or losses caused by reliance upon the accuracy or timeliness of any such information, or damages incurred from the viewing, distributing, or copying of those materials.

The materials and information provided here are provided "as is." No warranty of any kind, implied, expressed, or statutory, including but not limited to the warranties of non-infringement of third party rights, title, merchantability, fitness for a particular purpose, and freedom from computer virus, is given with respect to the contents of this document.

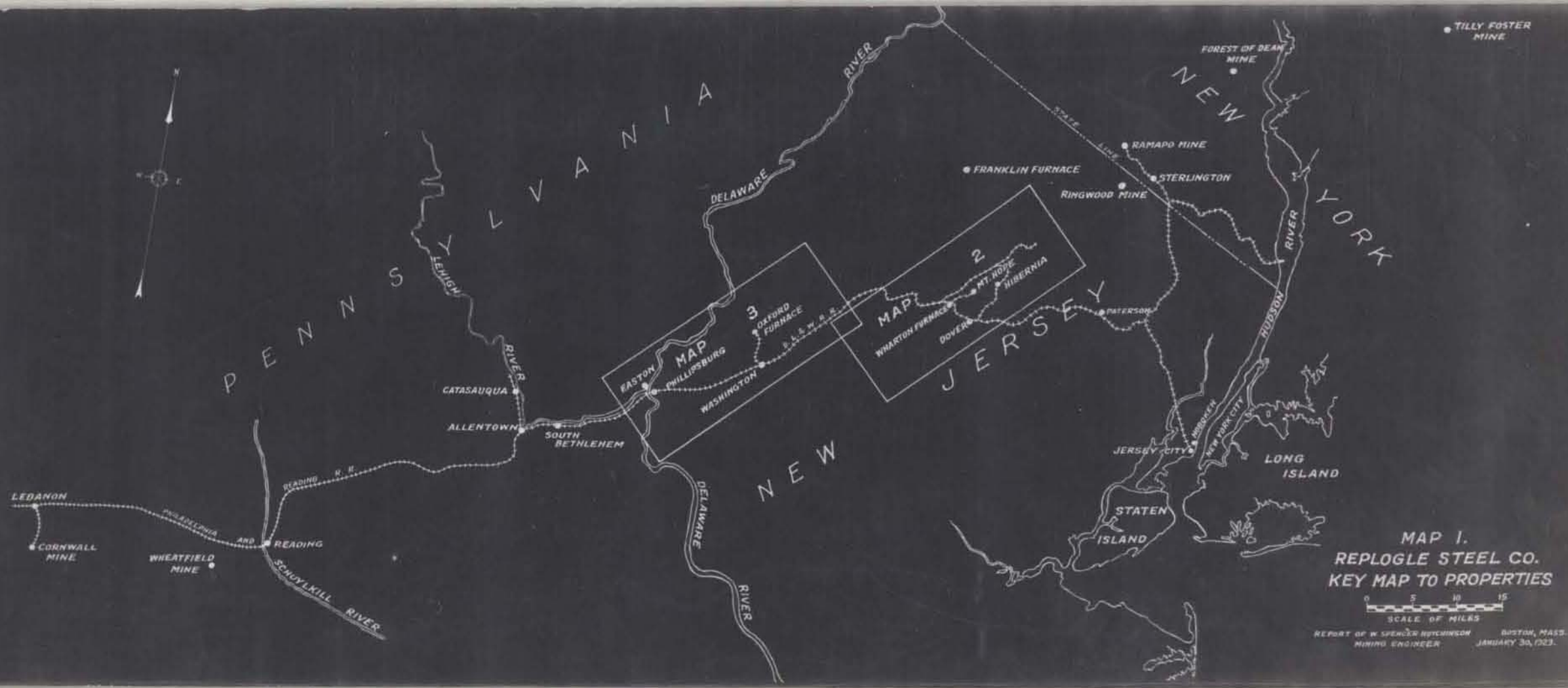

MAP I.
 REPLOGLÉ STEEL CO.
 KEY MAP TO PROPERTIES



REPORT OF W. SPENCER HUTCHINSON
 MINING ENGINEER

BOSTON, MASS.
 JANUARY 30, 1923.

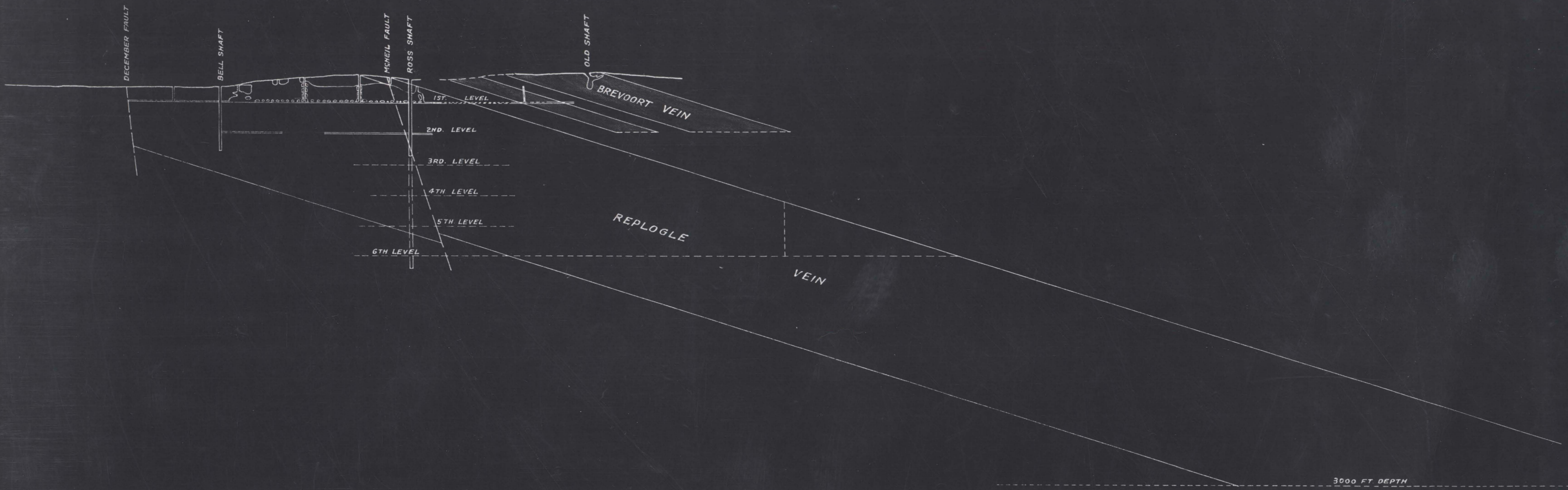

**REPLOGLE MINE
LONGITUDINAL PROJECTION
REPLOGLE AND BREVOORT VEINS**



SCALE OF FEET
REPORT OF W. SPENCER HUTCHINSON
MINING ENGINEER
BOSTON, MASS
JANUARY 30, 1923.

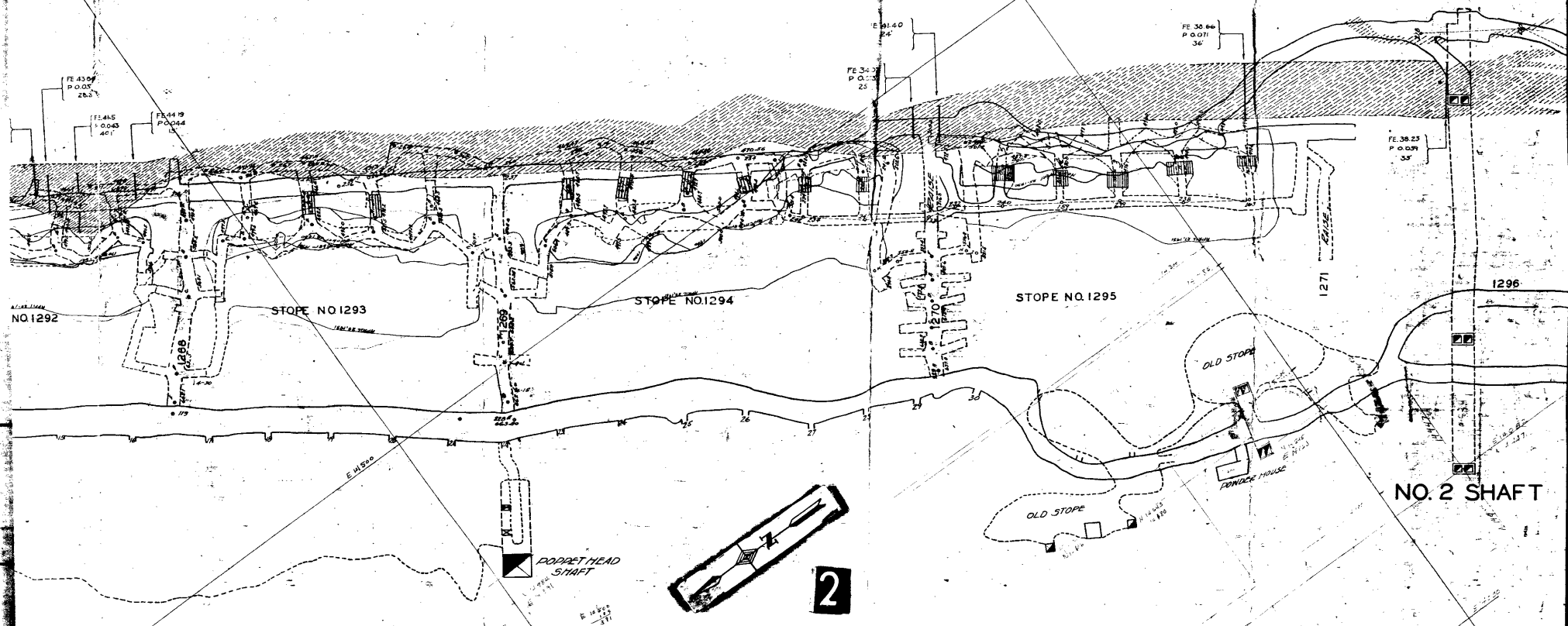

PLAN OF
 REPLOGLE MINE
 SCALE 1"=30'

103 NO 1007
 102 NO 1001
 1030

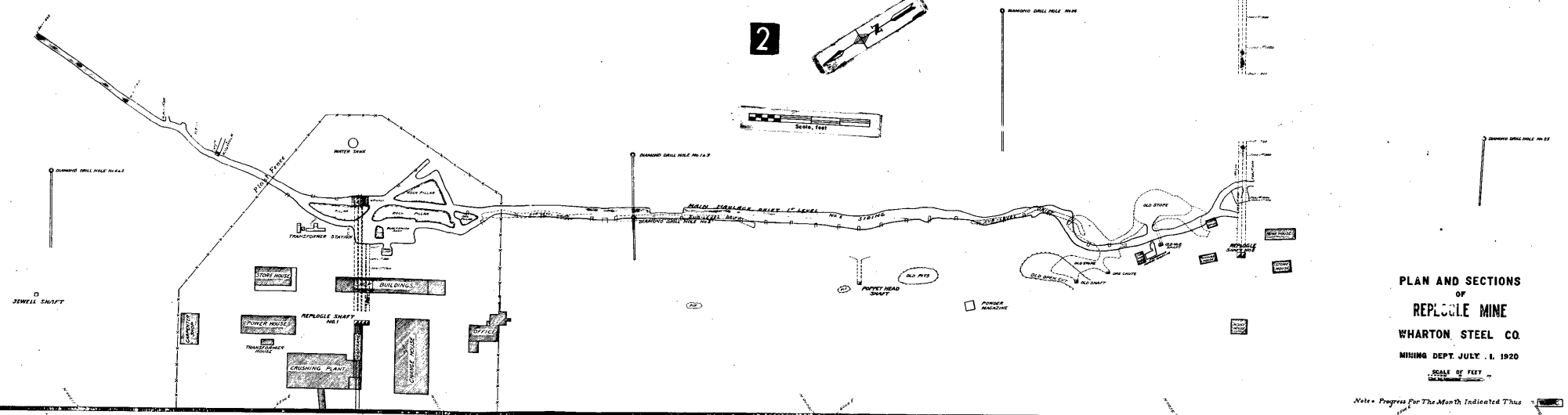
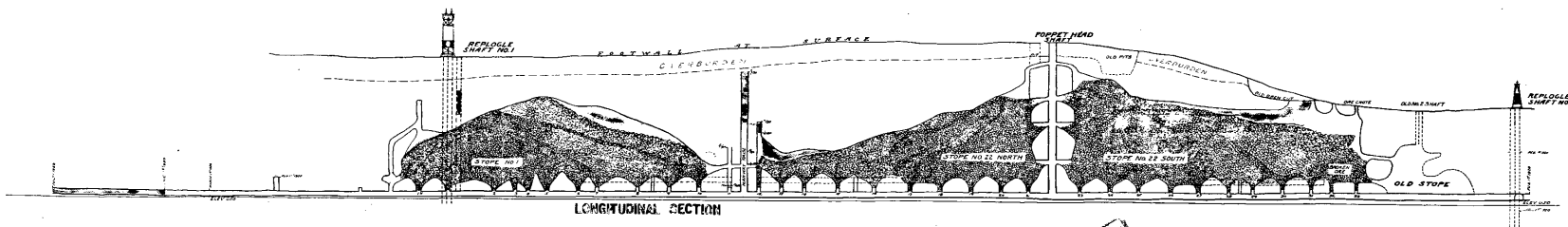

NJGS 03145 55 36X 354158

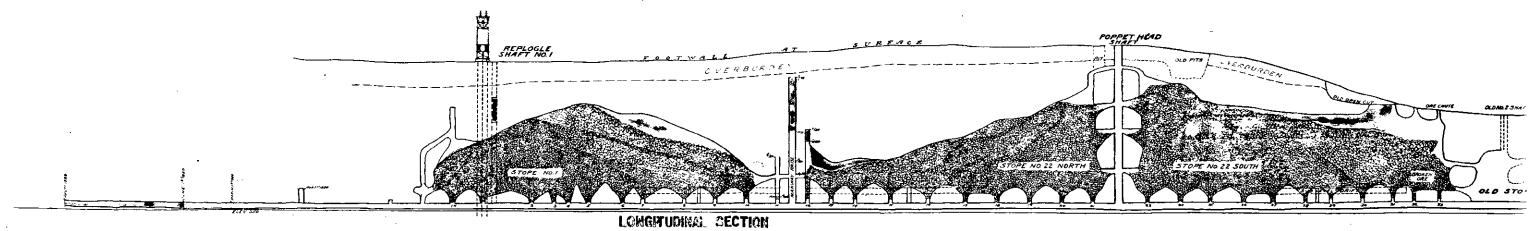

LONGITUDINAL SECTION

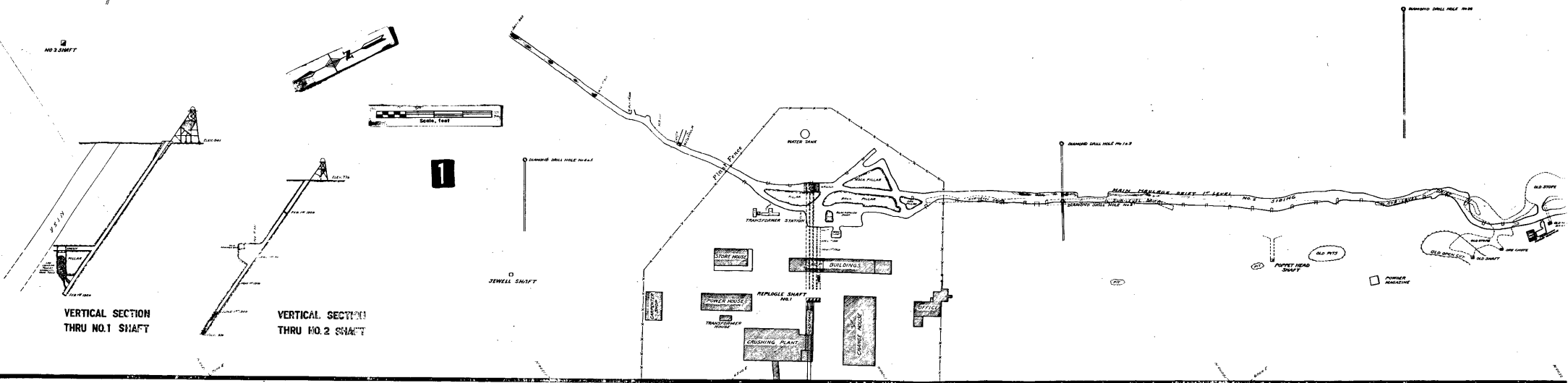

VERTICAL SECTION THRU NO. 1 SHAFT

VERTICAL SECTION THRU NO. 2 SHAFT

NJGS 03145 54 36X 354158

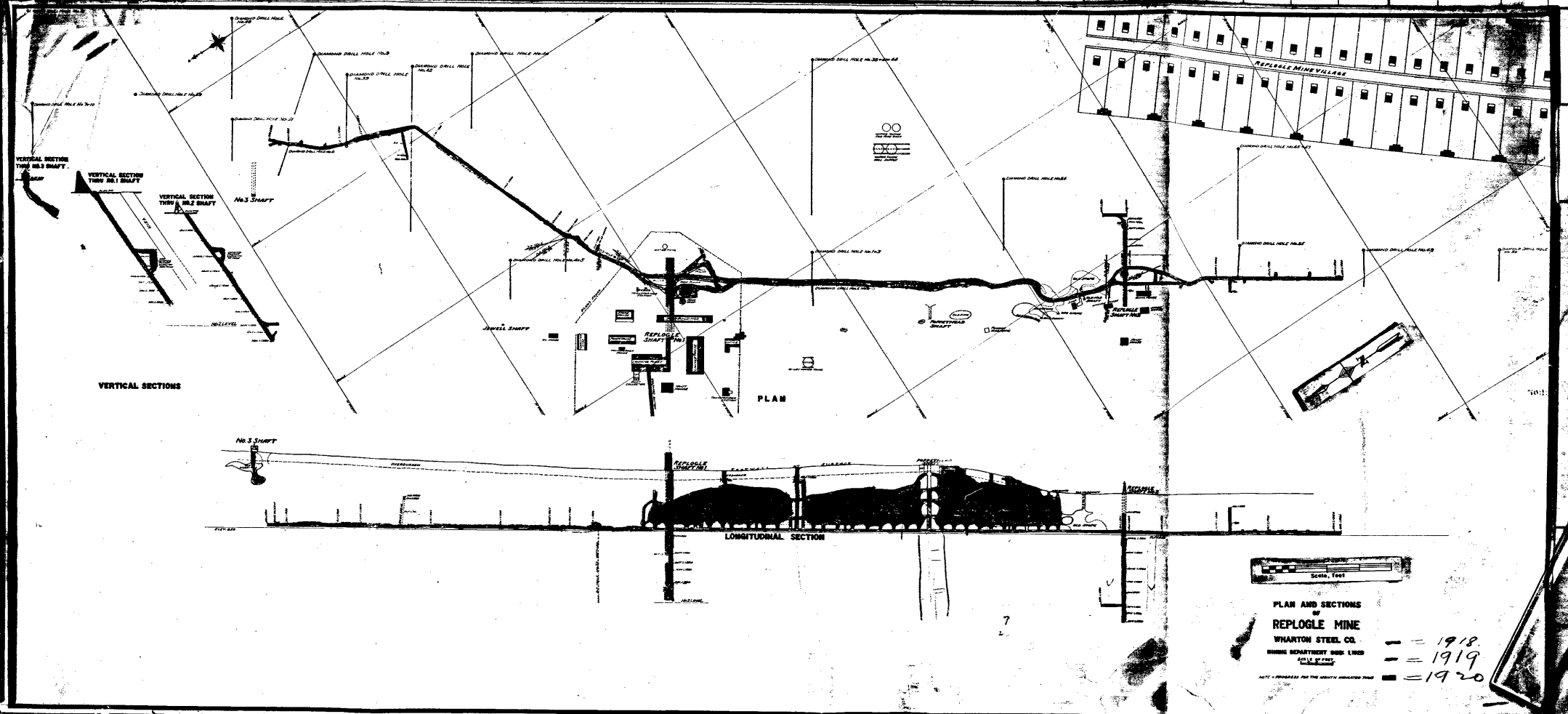

NJGS 03145 / 49 32X 354153