



State of New Jersey  
Department of Environmental Protection  
Geological Survey



**Information Disclaimer**

The State of New Jersey makes great effort to provide secure, accurate and complete information. However, portions of the information contained here may be incorrect or not current.

The State of New Jersey, its officers, employees or agents shall not be liable for damages or losses of any kind arising out of or in connection with the use or performance of information, including but not limited to, damages or losses caused by reliance upon the accuracy or timeliness of any such information, or damages incurred from the viewing, distributing, or copying of those materials.

The materials and information provided here are provided "as is." No warranty of any kind, implied, expressed, or statutory, including but not limited to the warranties of non-infringement of third party rights, title, merchantability, fitness for a particular purpose, and freedom from computer virus, is given with respect to the contents of this document.

# PLAN OF NEW VEIN

Richard Mine Wharton, N.J.  
 Dec. 8, 1914 L. H. Stone, E.M.  
 Revised, 12-12-14 Scale, 1" = 25'



NOTE:  
 The rock is 1 1/2 to 2 ft thick in places and is made of 1/2 to 1 inch pieces of iron ore.

Part looks like falling back by following west we can get some low-cost ore  
 means like north top of a shoot 1/4 mi

As seen in mine examination by Tom Myers in spring of 1914, shoots appeared to be 10 to 20 ft wide

1 B/p. sent to A. J. S. 7/1/14 = returned to Easton office with revisions 12/15/14.  
 1 " " " W. S. H. " "  
 1 " to be kept in Easton office

Intersection of  
North Vein and  
Coker Property  
Line

1061

9th Level  
Projected  
Bottom Rock

North Vein

7th Level

6th Level

5th Level

500 Level

Projected Top Rock

BAKER PROPERTY

THOMAS IRON CO

Base Line

45°

Cross Section  
Richards Mine  
Scale 1" = 100'

Diagonal Drift Hole,  
being drilled, April 15th,  
projected on section.

THOMAS IRON CO  
Section #  
Scale 1" = 100'

BAKER

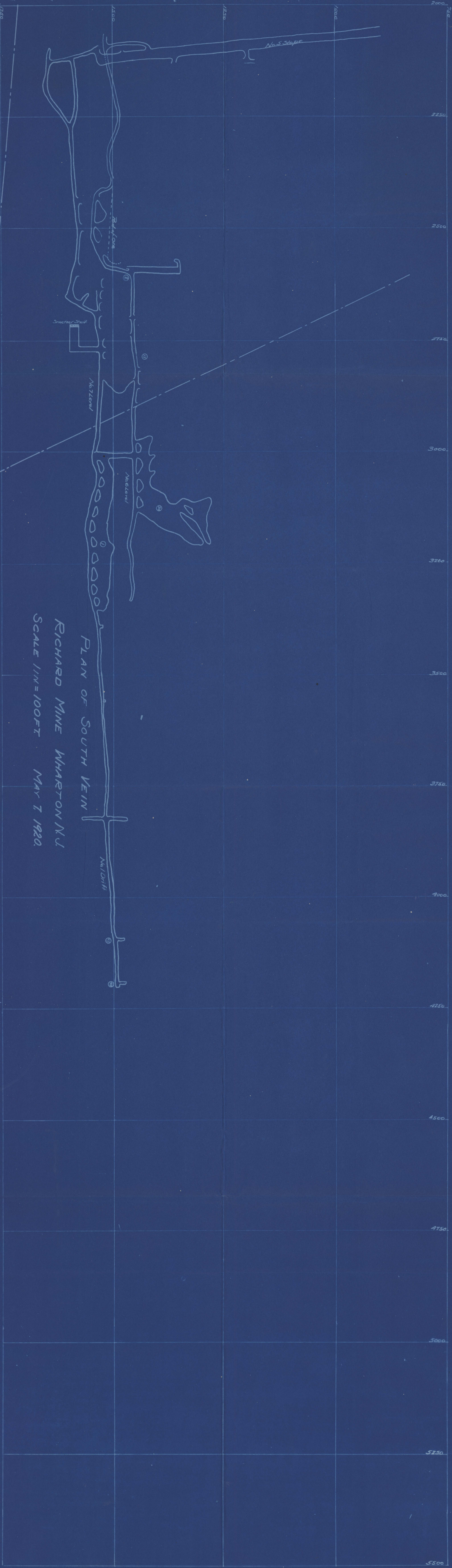

PLAN OF SOUTH VEIN  
RICHARD MINE WHARTON N.J.  
SCALE 1/4" = 100 FT. MAY 7, 1920.

BAKER

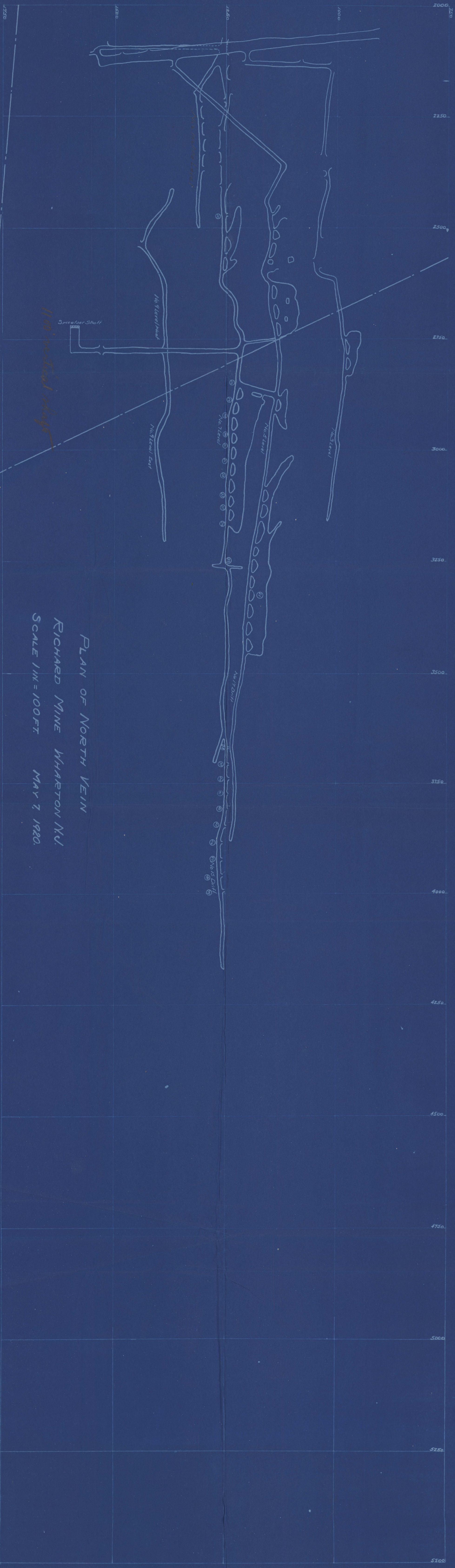

PLAN OF NORTH VEIN  
RICHARD MINE WHARTON N.J.  
SCALE 1 IN = 100 FT. MAY 7, 1920.

**MAP NO.1**

BAKER PROBABLE ORE 1,2,5	= 10,42,000	TONS	NORTH VEIN
RICHARD ORE IN SIGHT	= 1,743,000	"	" " " C.F.A.A
" PROBABLE ORE A,B,C,D	= 3,120,000	"	" " "
" " " F.E.B.A	= 1,902,000	"	" " "
" " " "	= 1,754,000	"	SOUTH "
" ORE IN SIGHT	= 1,055,000	"	" " "
<b>TOTAL TONNAGE</b>	<b>= 10,616,000</b>	<b>TONS</b>	
RICHARD ORE IN SIGHT	= 2,798,000		
" PROBABLE ORE	= 6,776,000		
BAKER " "	= 1,042,000		

TEABO  
186 ACRES

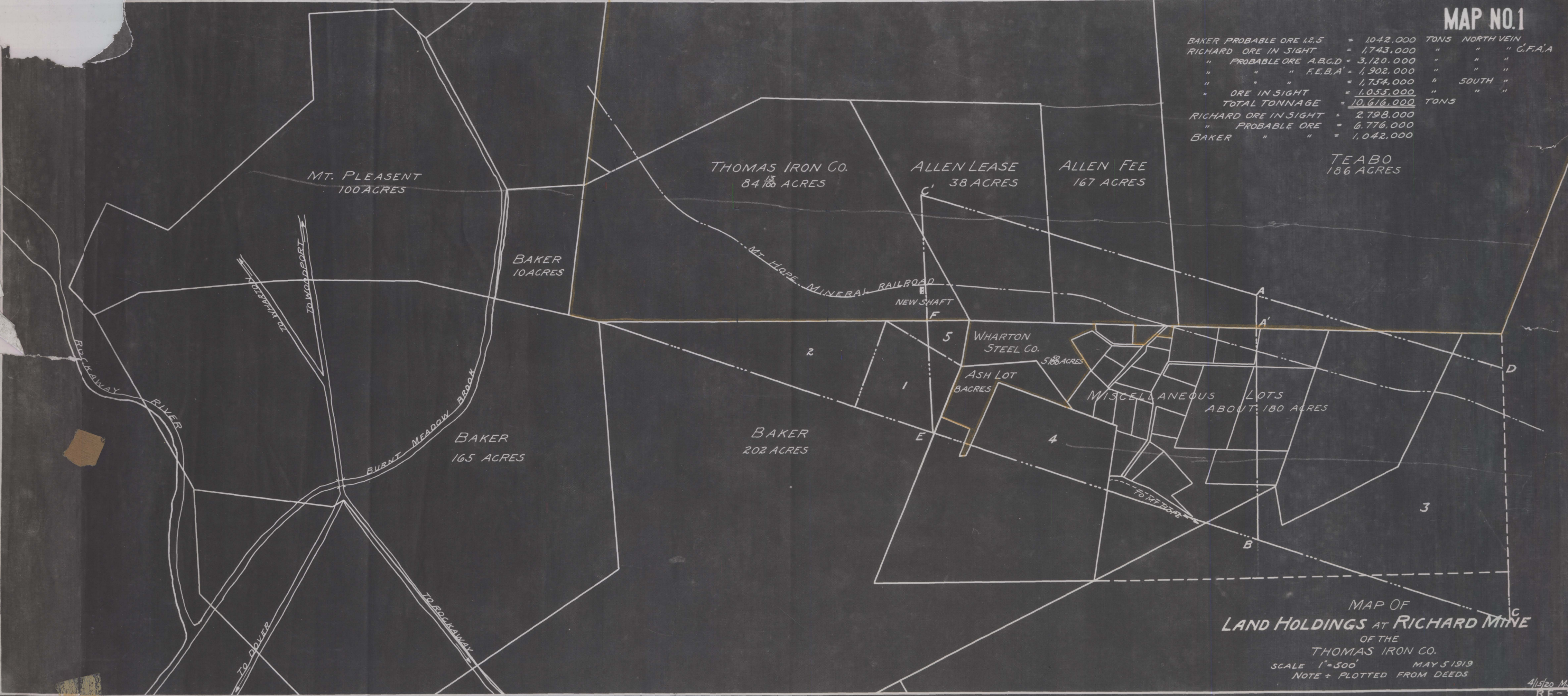

MAP OF  
**LAND HOLDINGS AT RICHARD MINE**  
OF THE  
THOMAS IRON CO.  
SCALE 1"=500' MAY 5 1919  
NOTE - PLOTTED FROM DEEDS

Cross Section  
Richards Mine  
Scale 1" = 100'

THOMAS IRON CO.  
Section #  
Scale 1" = 100'

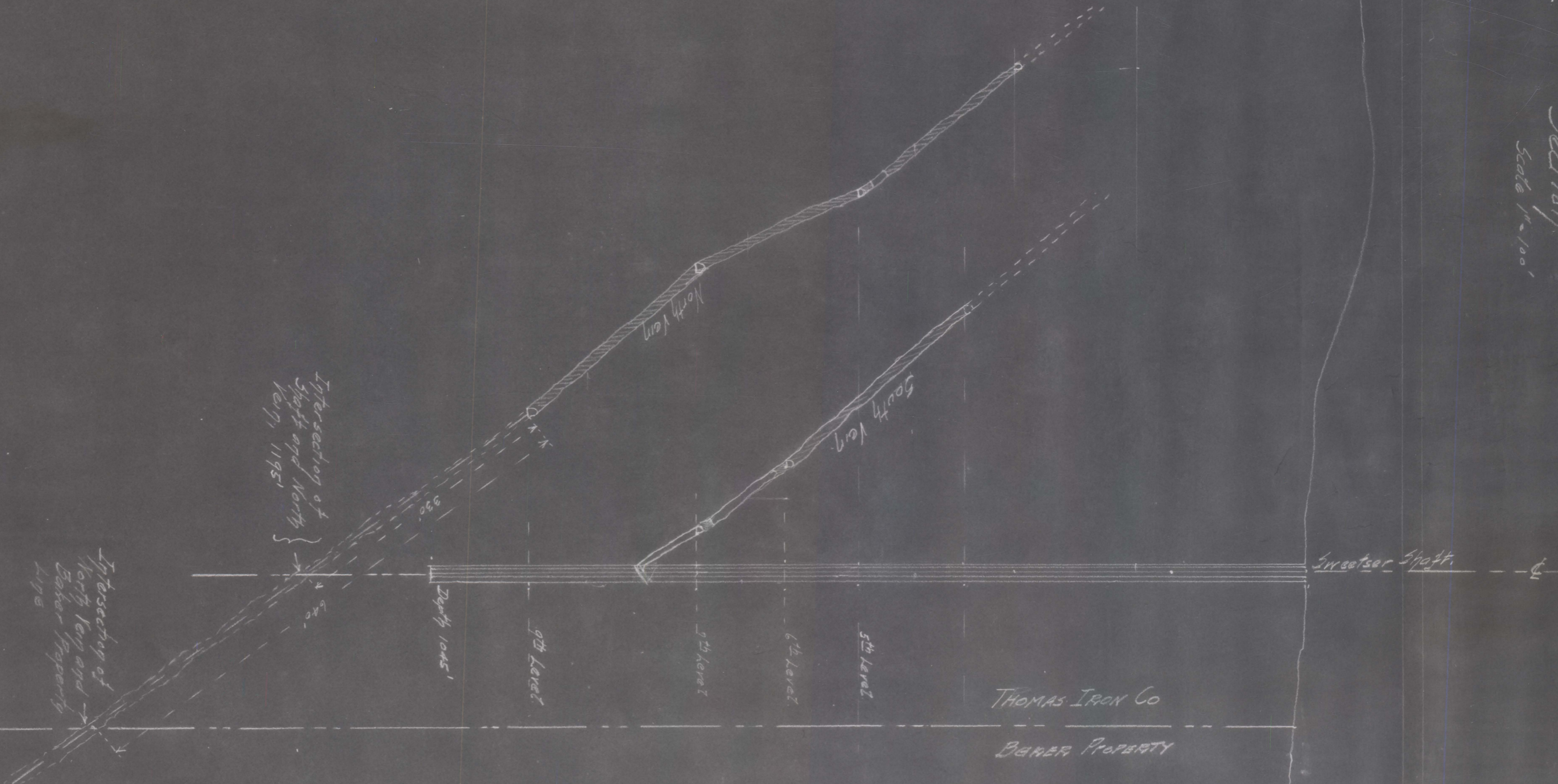

Intersection of  
Shaft and North  
Vein, 1195'

Intersection of  
North Vein and  
Baker Property  
Lips

Sweetser Shaft

Depth 1045'

9th Level

7th Level

6th Level

5th Level

THOMAS IRON CO

BEMER PROPERTY

North Vein

South Vein

ALLEN  
 RICHARD MINE  
 ALLEN MINE

# MAP

## OF LEASED WORKINGS

RICHARD MINE WHARTON N.J.

APR. 6, '15. L.H. STONE EM.

SCALE: 1" = 100'

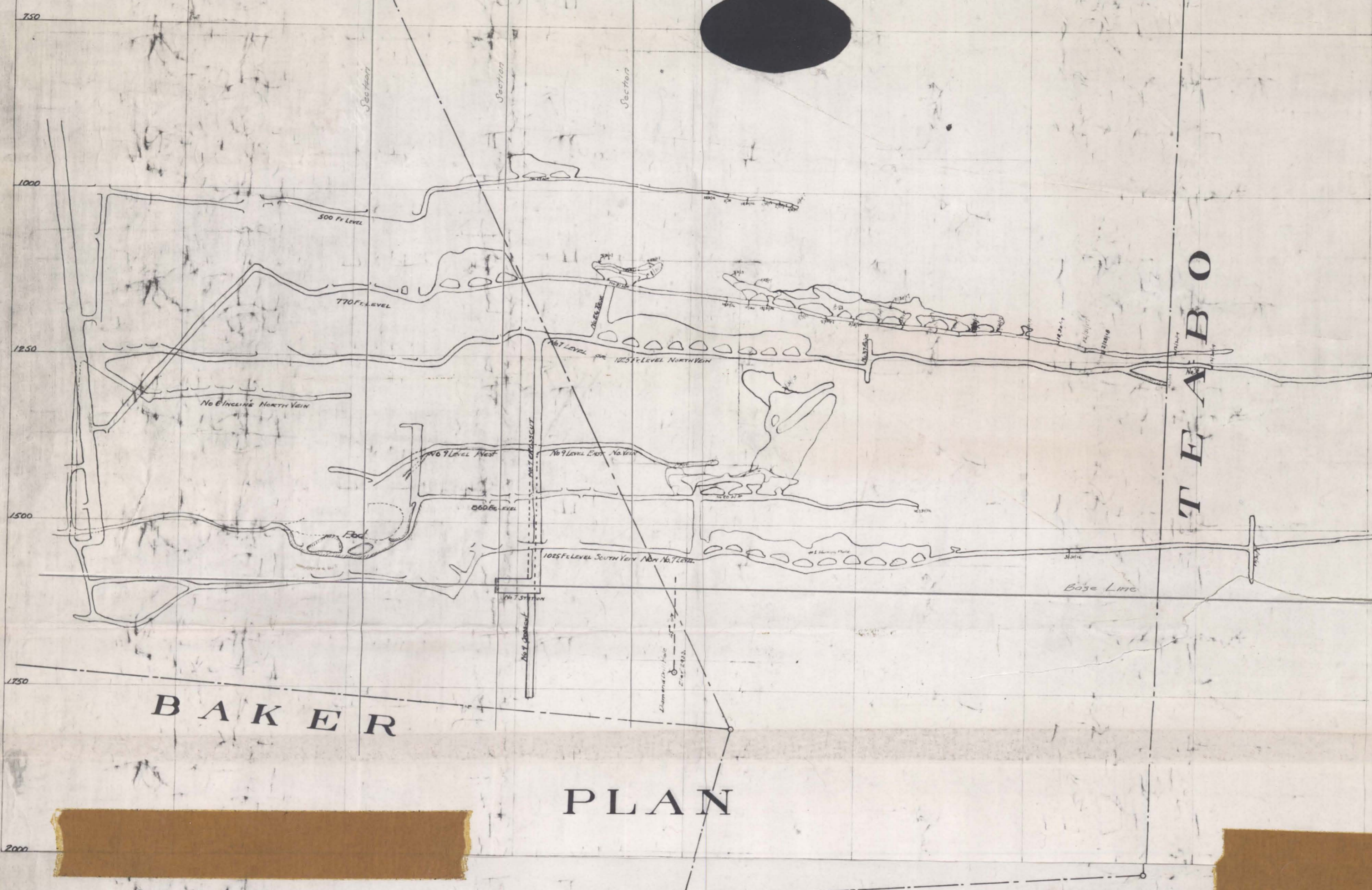

# PLAN

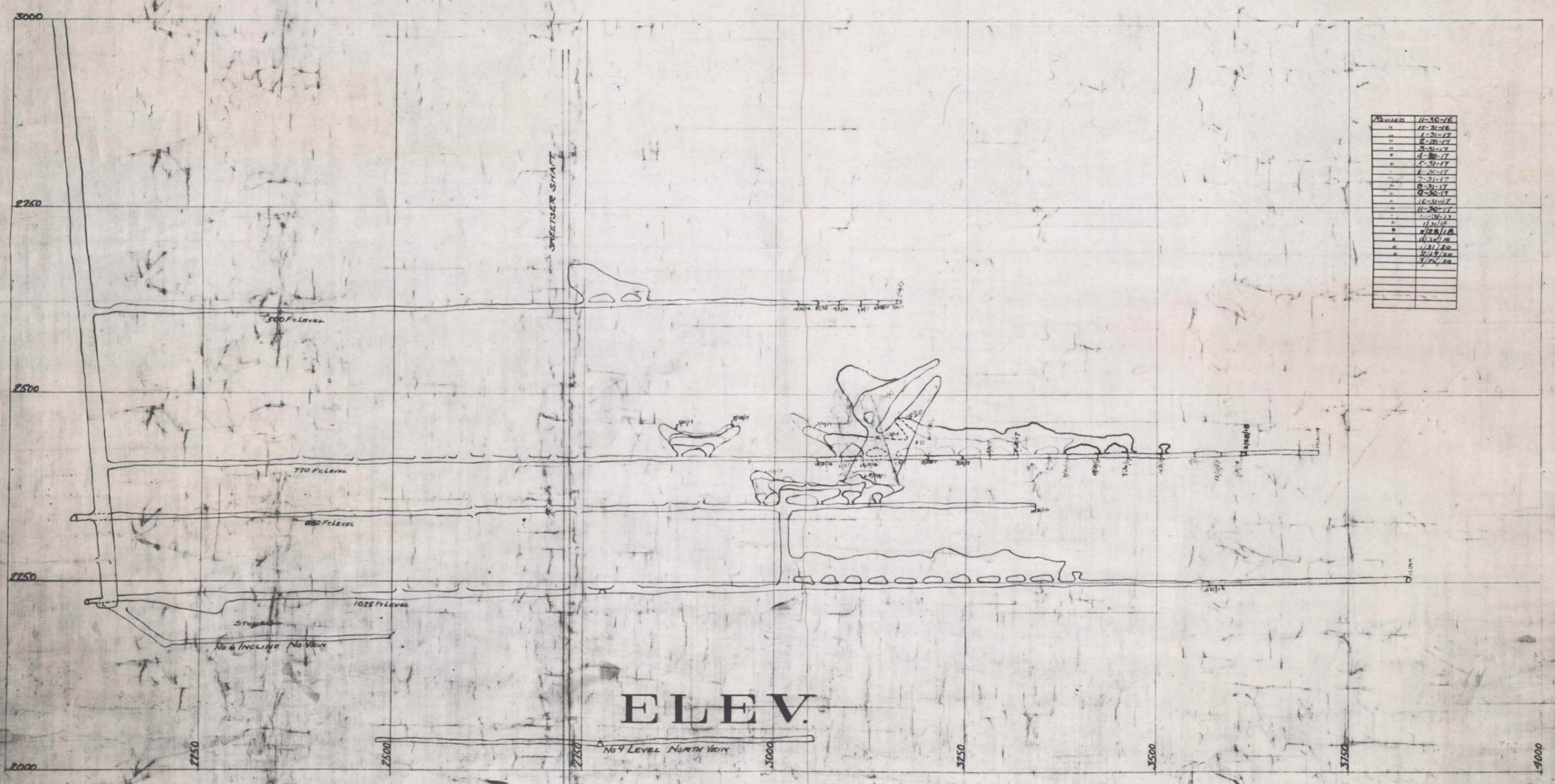

# ELEV.

Number	Description
1	1025
2	1025
3	1025
4	1025
5	1025
6	1025
7	1025
8	1025
9	1025
10	1025
11	1025
12	1025
13	1025
14	1025
15	1025
16	1025
17	1025
18	1025
19	1025
20	1025
21	1025
22	1025
23	1025
24	1025
25	1025
26	1025
27	1025
28	1025
29	1025
30	1025
31	1025
32	1025
33	1025
34	1025
35	1025
36	1025
37	1025
38	1025
39	1025
40	1025
41	1025
42	1025
43	1025
44	1025
45	1025
46	1025
47	1025
48	1025
49	1025
50	1025



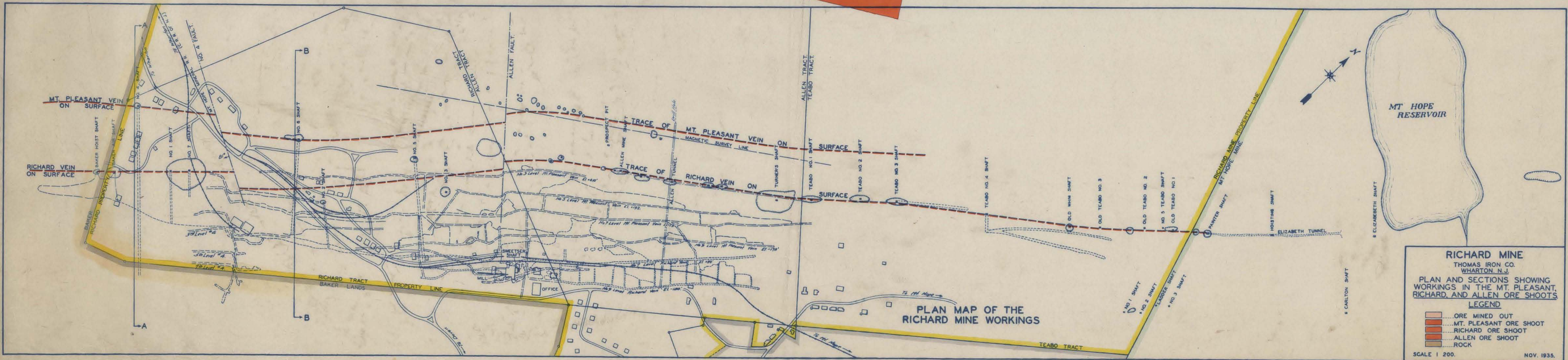
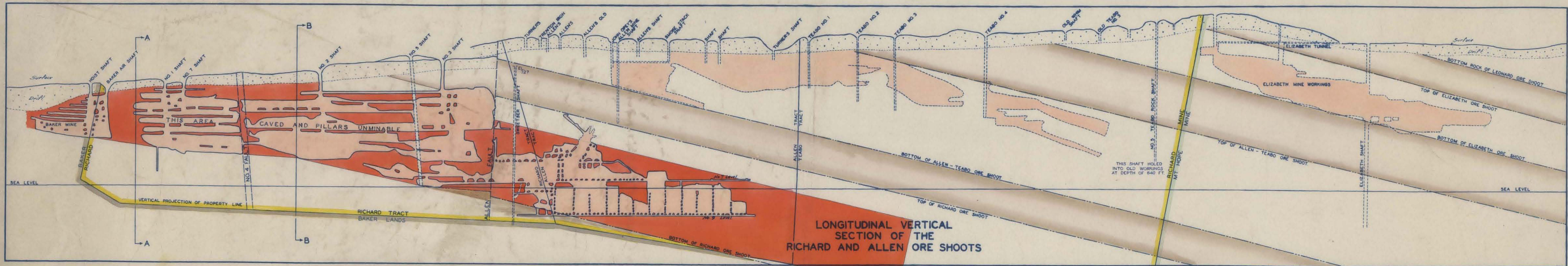
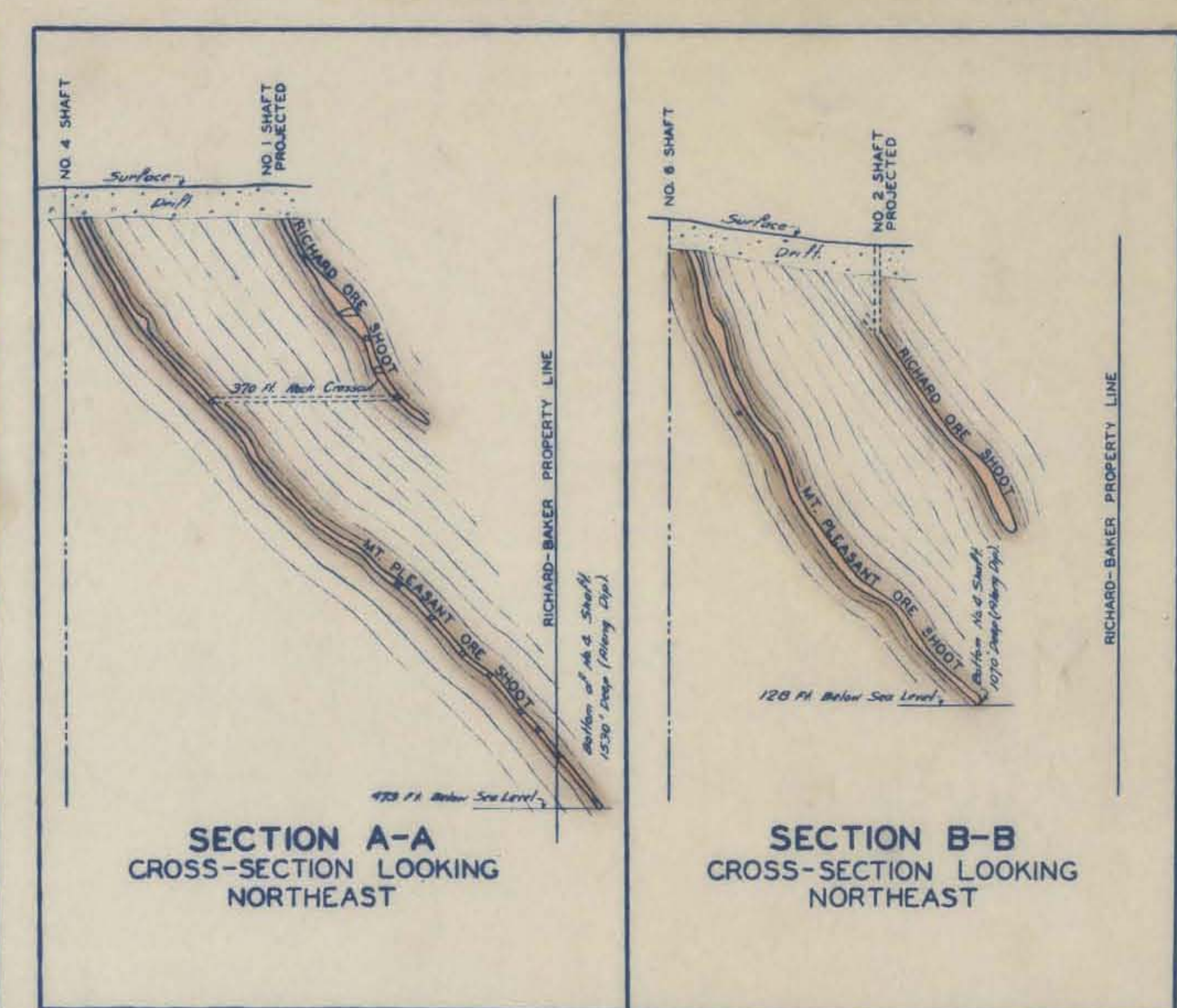
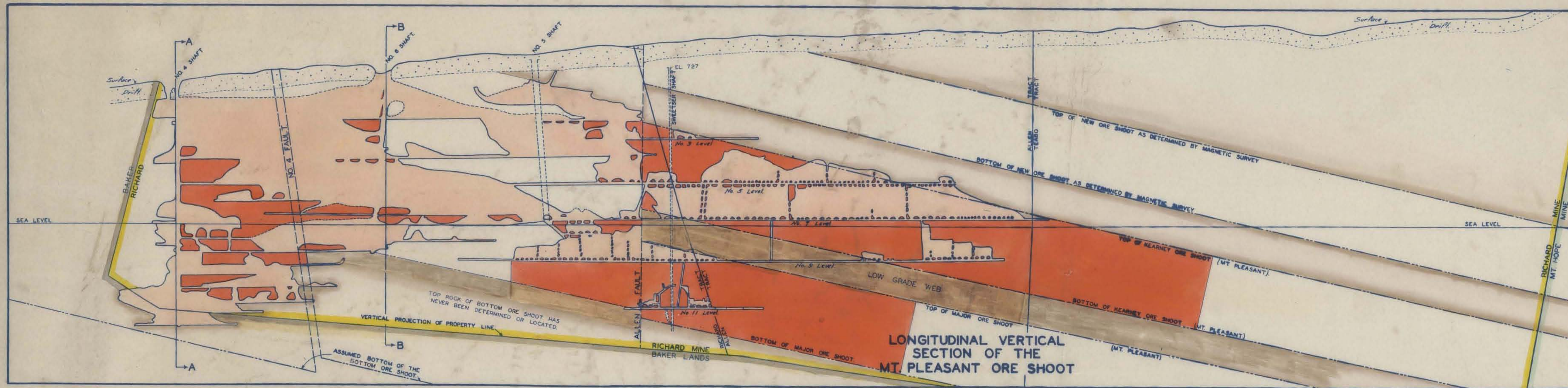

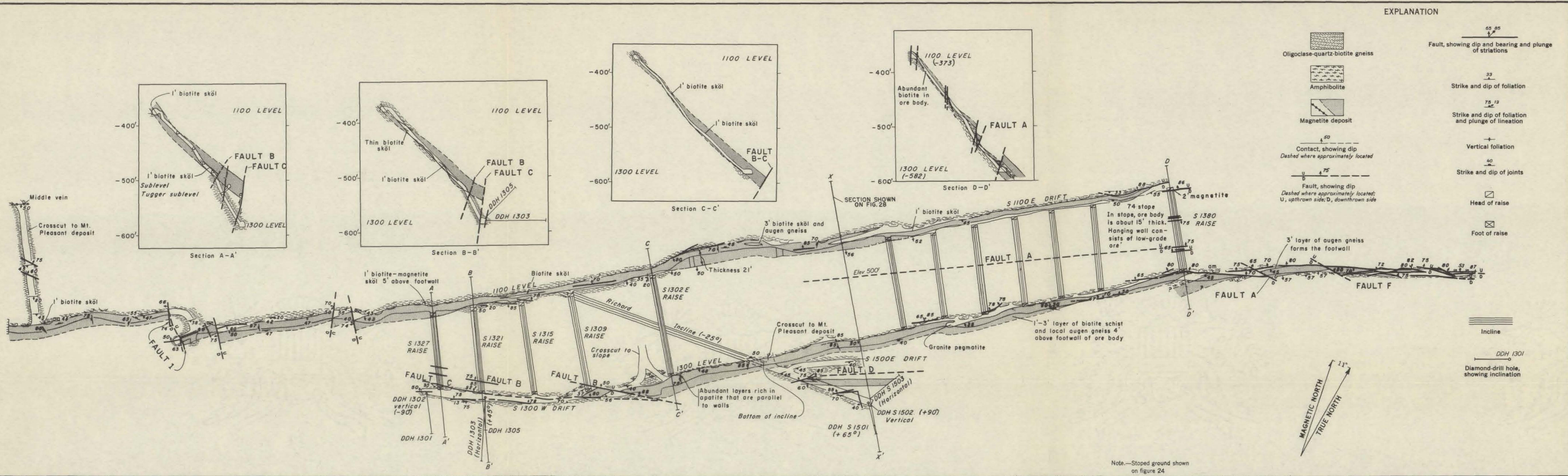

GEOLOGIC MAPS AND SECTIONS OF THE RICHARD (SOUTH) ORE BODY ON THE 1100, 1300, AND 1500 LEVELS. RICHARD MINE, MORRIS COUNTY, NEW JERSEY

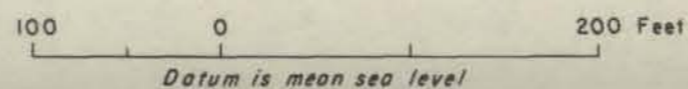

49155 O-38 (in pocket)

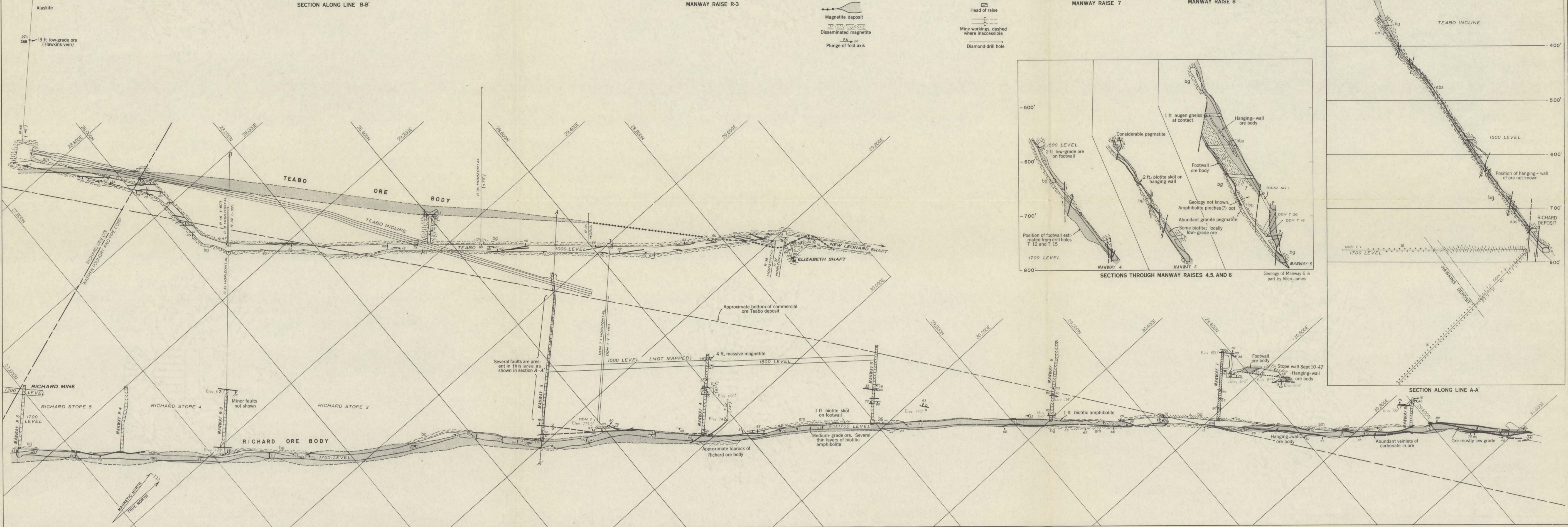
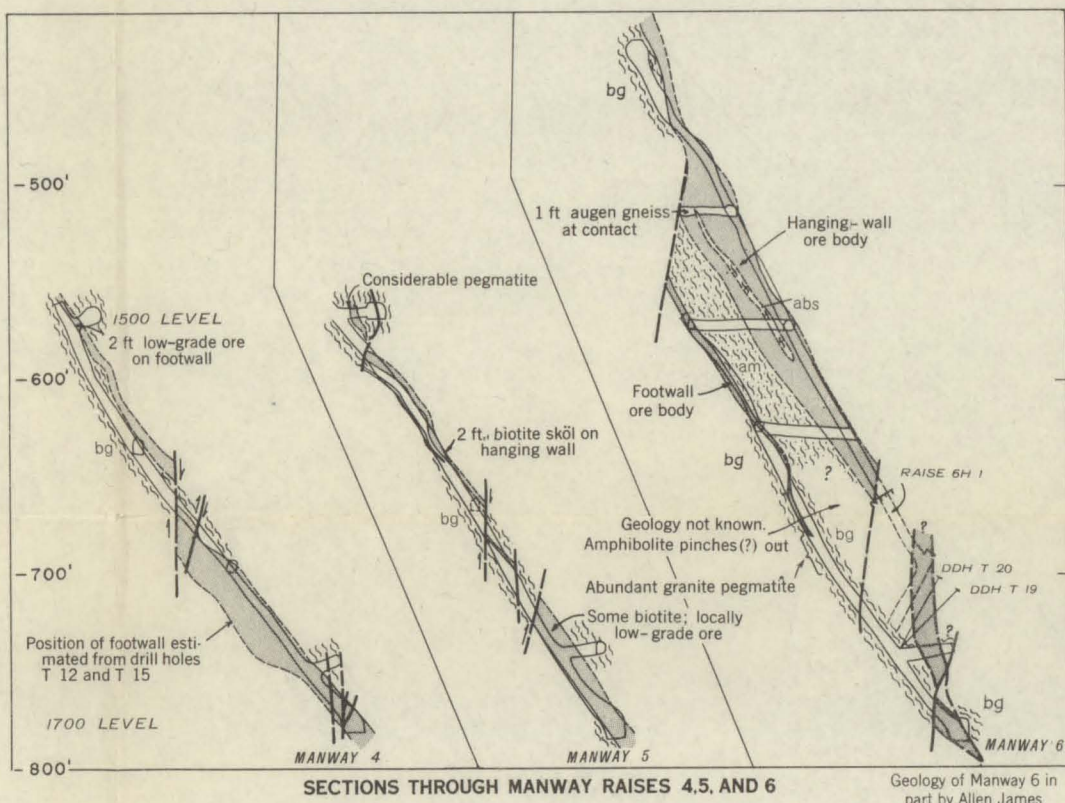
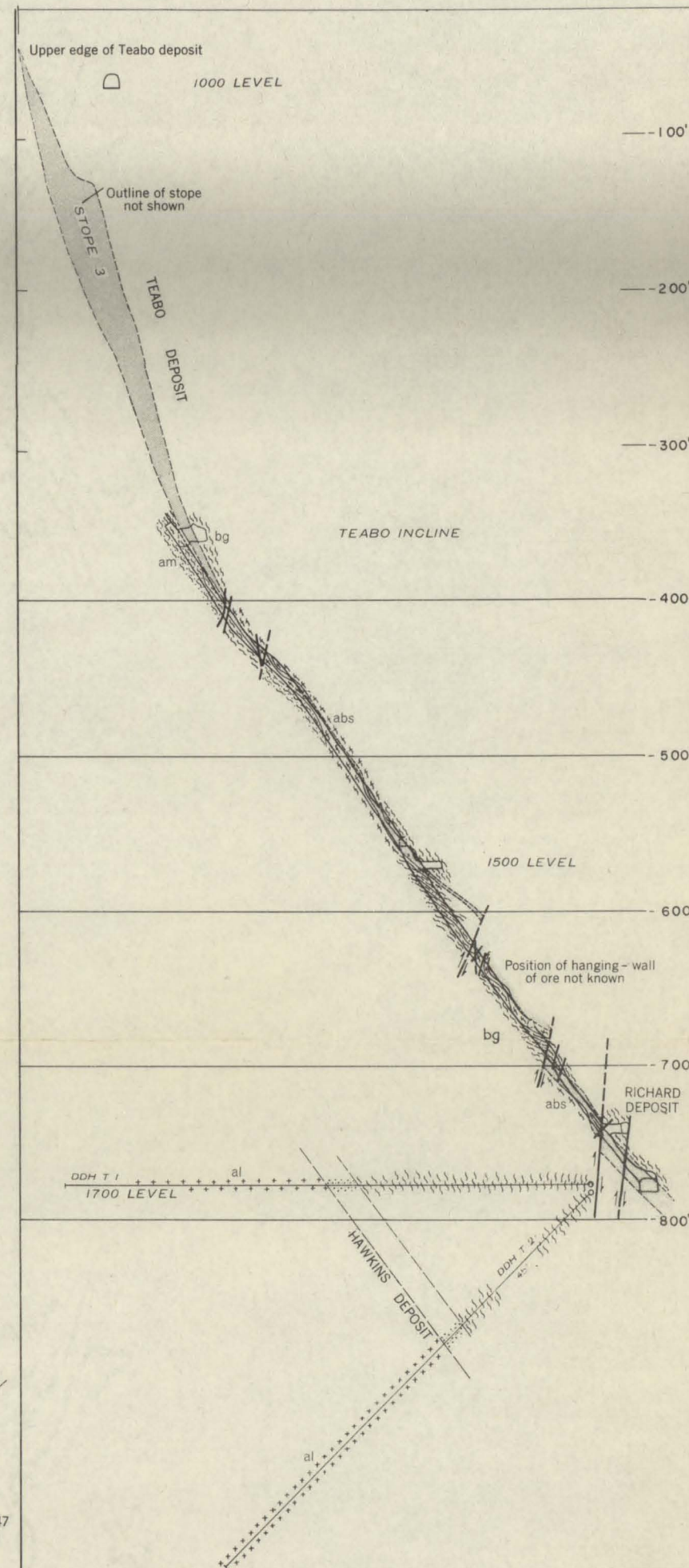
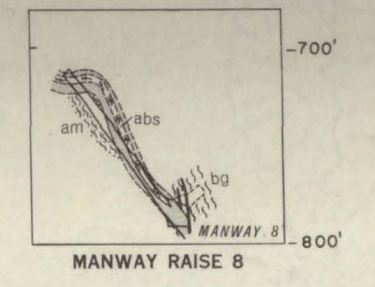
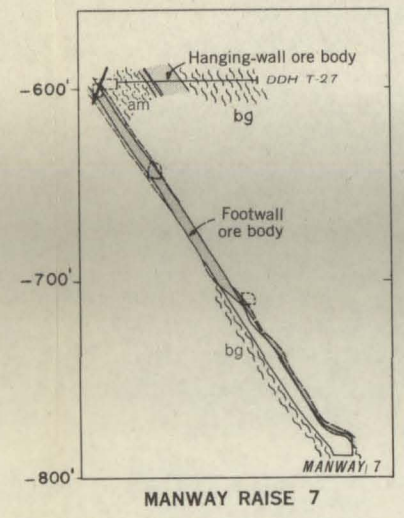
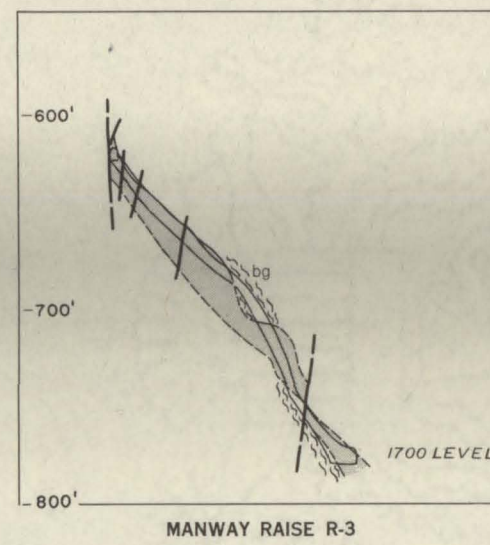
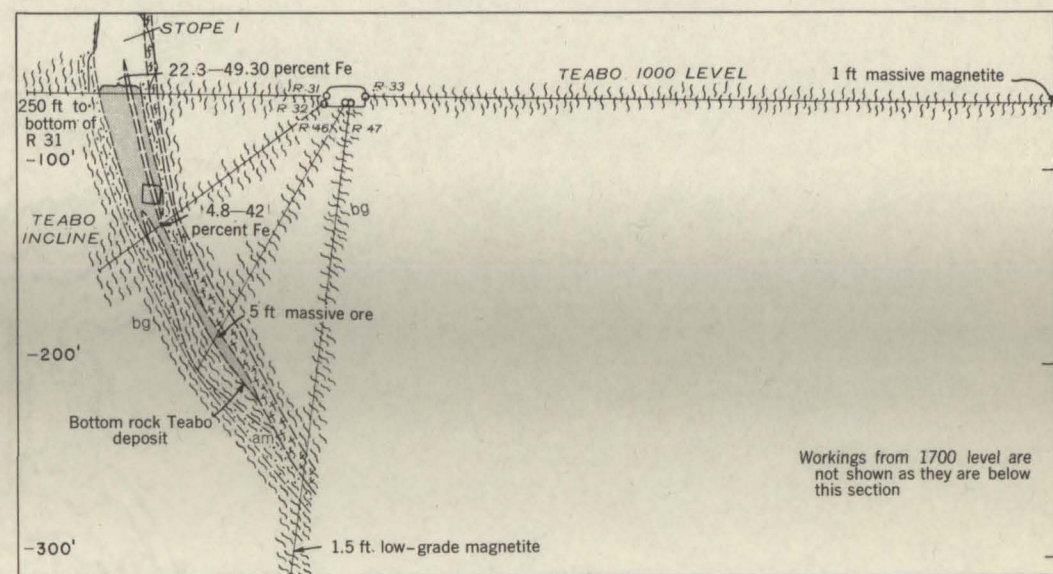

- EXPLANATION
- Alaskite
  - Oligoclase-quartz-biotite gneiss
  - Amphibolite
  - Biotitic amphibolite and biotite skil
  - Contact, showing dip  
Dashed where approximately located
  - High angle fault, showing dip  
Dashed where approximately located  
U, upthrown side; D, downthrown side
  - Vertical fault
  - Fault, showing relative movement
  - Magnetite deposit
  - Disseminated magnetite
  - Plunge of fold axis
  - Plunge of overturned fold
  - Strike and dip of foliation
  - Bearing and plunge of lineation
  - Strike and dip of foliation and plunge of lineation
  - Strike and dip of joints
  - Strike of vertical joints
  - Shaft going above and below levels
  - Inclined raise chevrons point down
  - Incline or slope
  - Foot of raise
  - Head of raise
  - Mine workings, dashed where inaccessible
  - Diamond-drill hole

GEOLOGIC MAP AND SECTIONS OF THE TEABO AND RICHARD ORE BODIES, 1000 AND 1700 LEVELS, MOUNT HOPE MINE, MORRIS COUNTY, NEW JERSEY

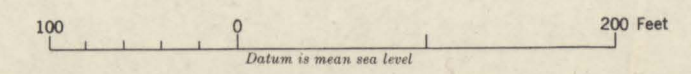

Geology by P. K. Sims, 1947-49

491519 O -58 (in pocket)

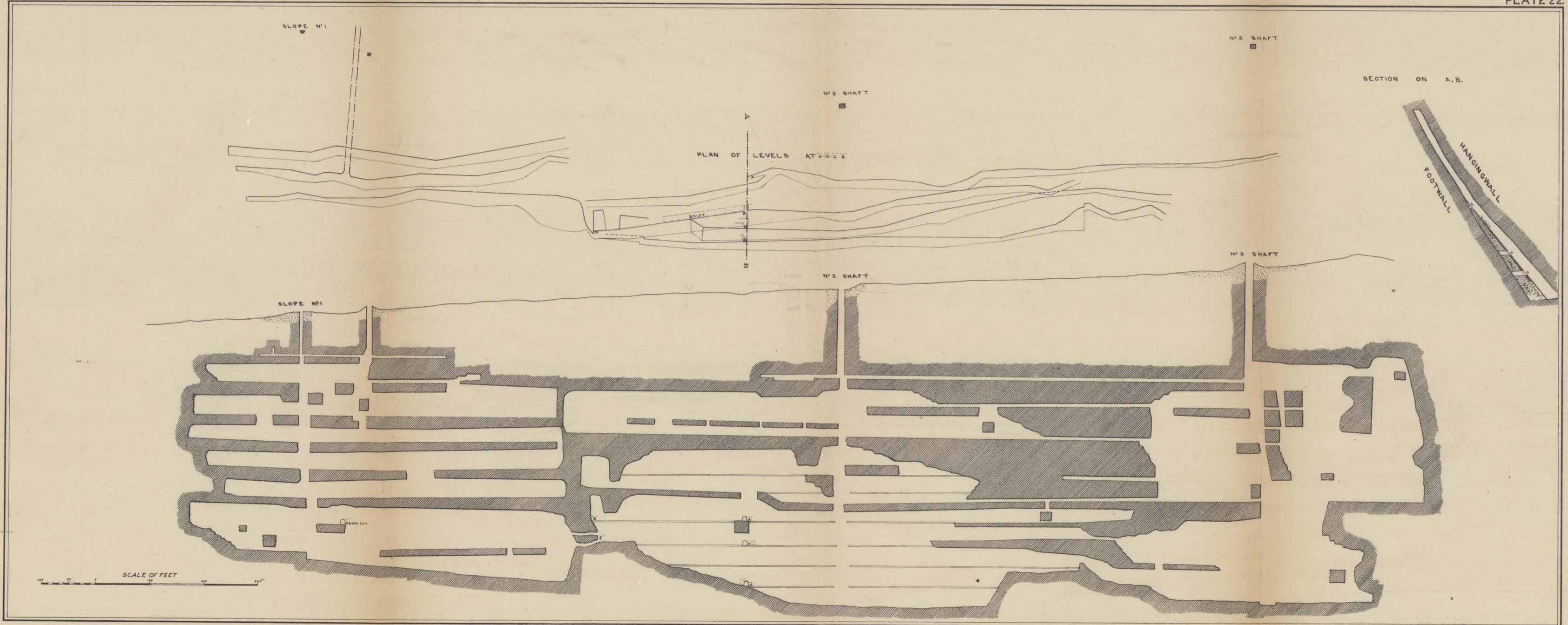

PLAN AND ELEVATION OF THE RICHARD MINE  
BY GEORGE E. JENKINS C.E.

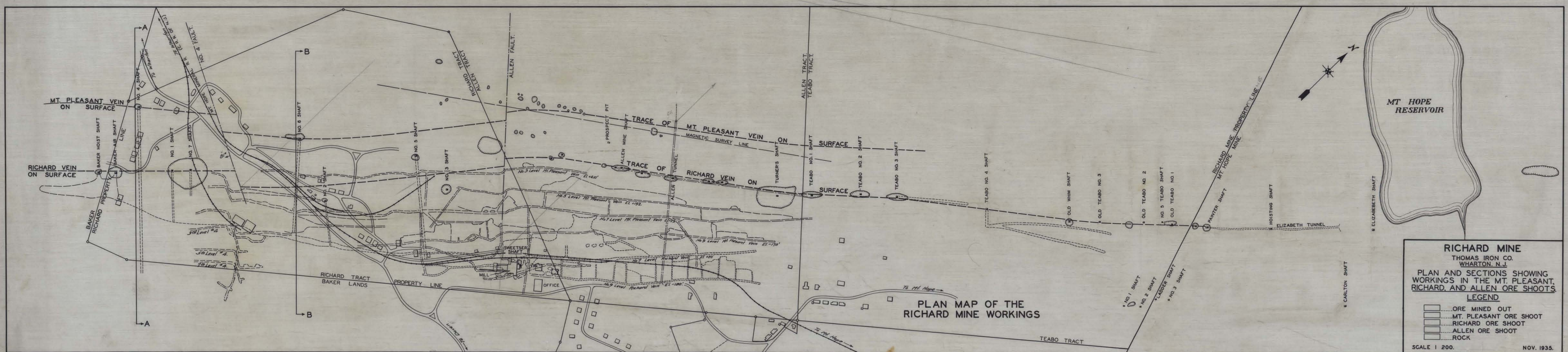
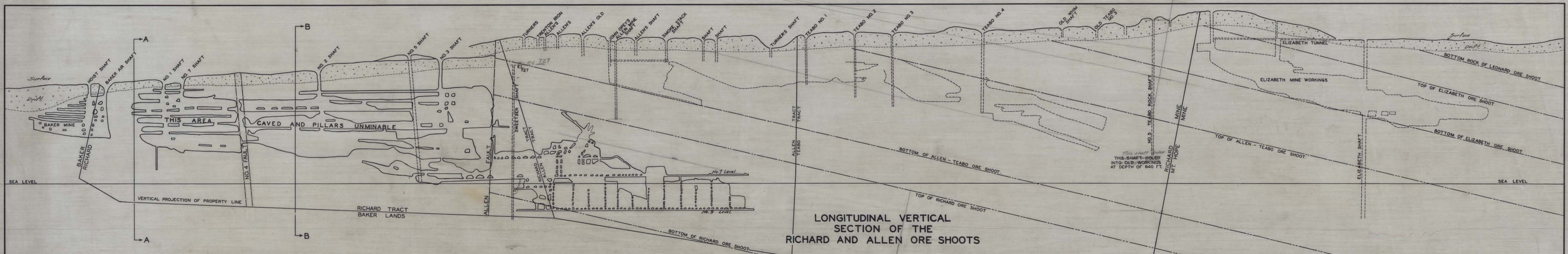
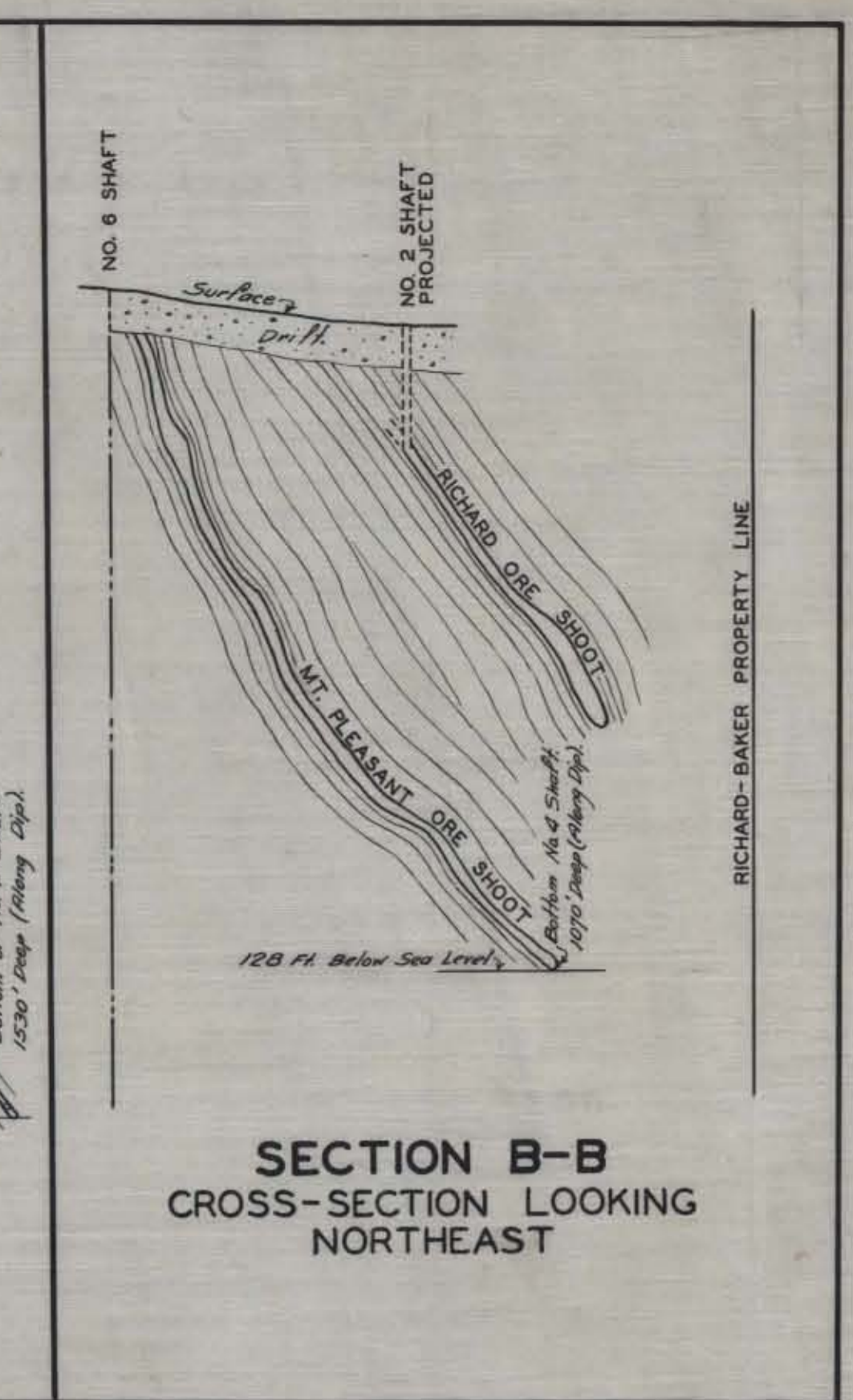
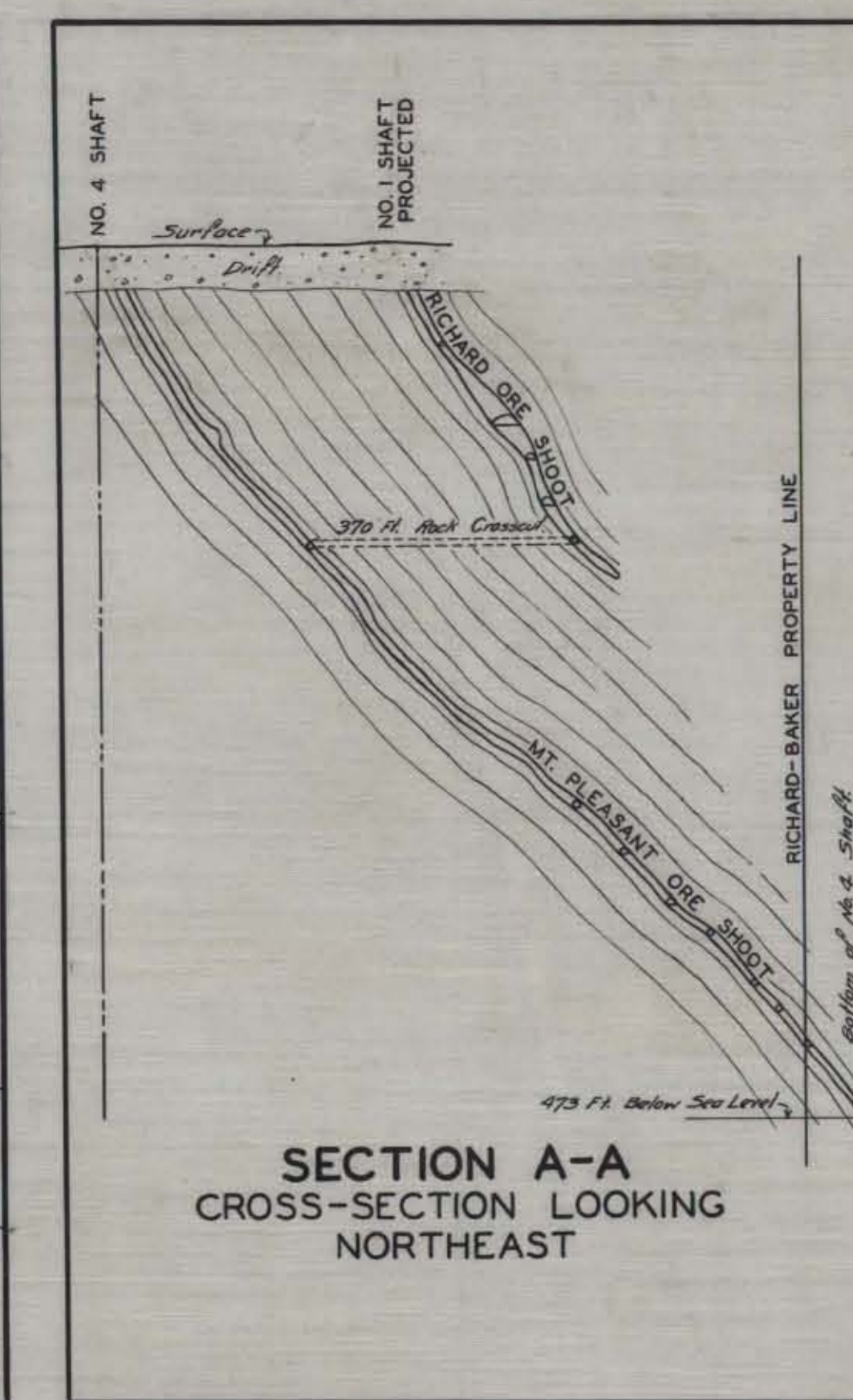
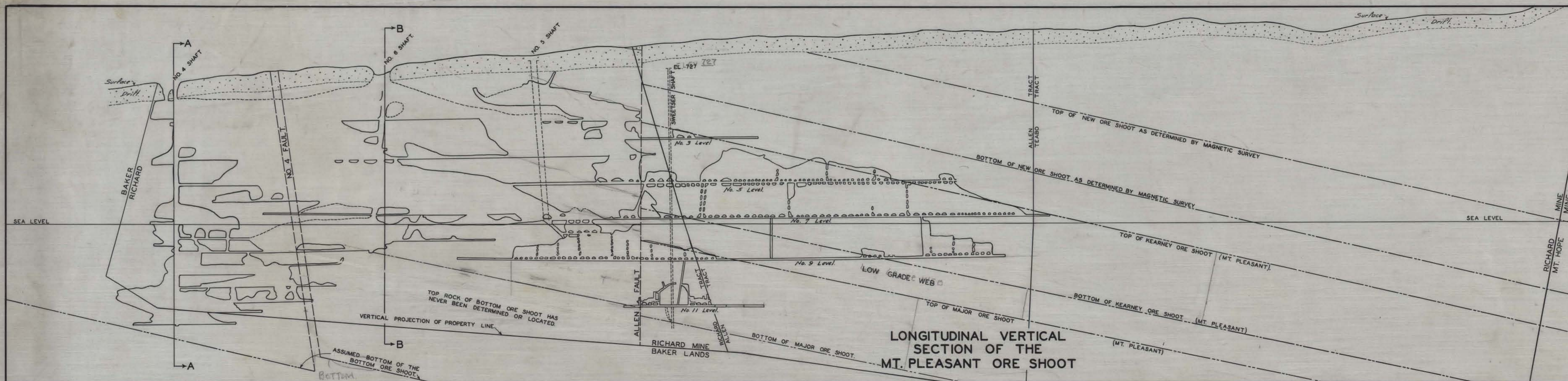

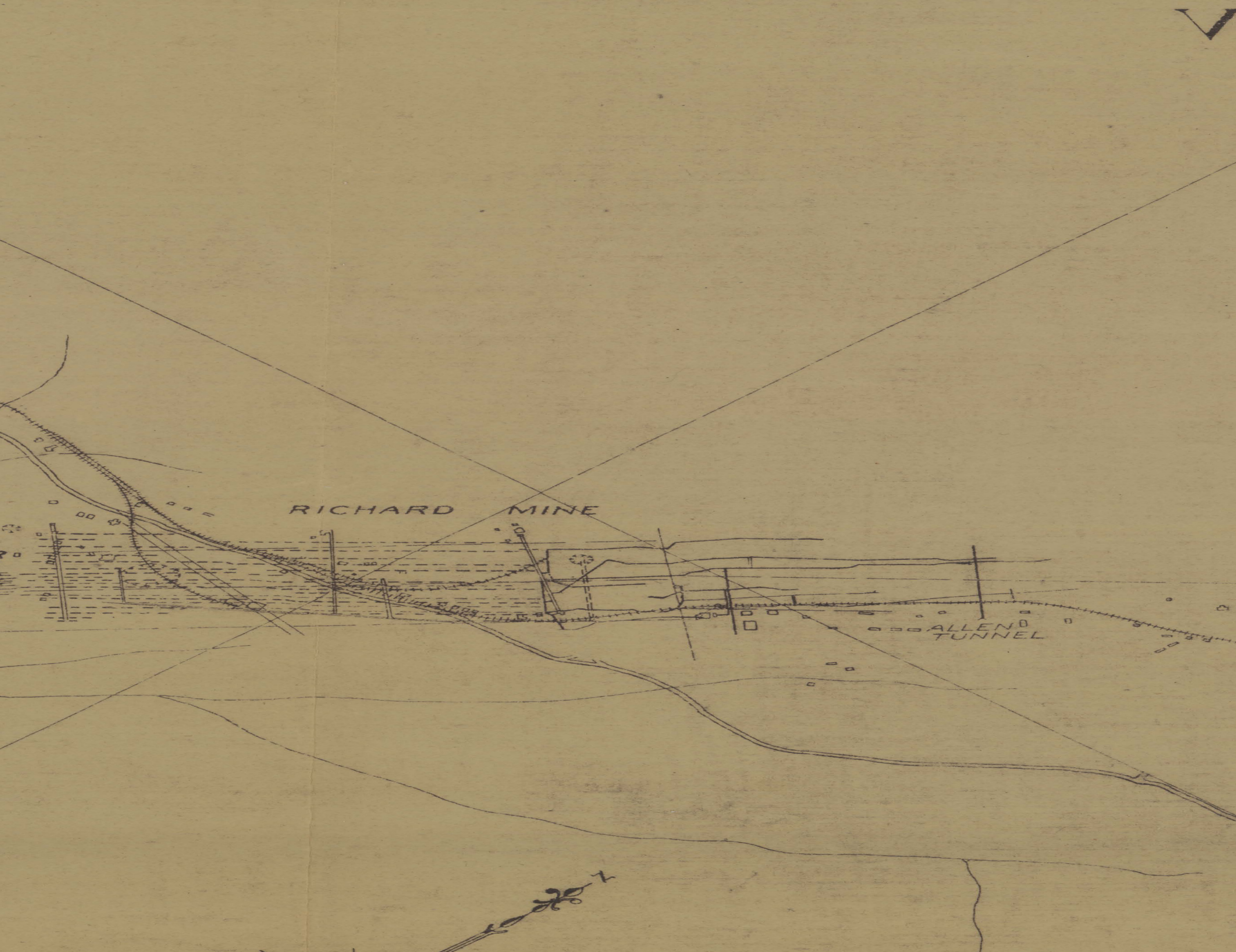

RICHARD MINE

ALLEN TUNNEL

