



State of New Jersey

DEPARTMENT OF ENVIRONMENTAL PROTECTION

Bureau of Freshwater & Biological Monitoring
PO Box 420, 35 Arctic Parkway
Mail Code 35-01
Trenton, NJ 08625-420
TEL (609) 292-0427
FAX (609) 633-1095

CHRIS CHRISTIE
Governor

KIM GUADAGNO
Lt. Governor

BOB MARTIN
Commissioner

Dr. Stewart Farrell, Executive Director
Stockton State College Coastal Research Center
30 Wilson Ave.
Port Republic, NJ 08241

December 20, 2013

Dear Dr. Farrell,

This is to confirm the work to be performed at Twilight Lake, Bay Head, NJ, by Stockton State College for the State of New Jersey Department of Environmental Protection (NJDEP). The purpose of this work is to obtain sediment core samples for physical analysis and chemical testing. Pursuant to the "Sediment Sample and Testing Plan," provided to you on November 7, 2013, Stockton State College will collect six (6) sediment core samples at this lake. NJDEP has agreed to pay the fee of \$2593.24 for these services which Stockton had quoted on November 13, 2013.

Please contact me if you have any questions. Thank you.

Sincerely,

Victor Poretti
Section Chief
Bureau of Freshwater and Biological Monitoring

cc: J. Reading, NJDEP/WMS
L. McGeorge, NJDEP/BFBM

STATE OF NEW JERSEY AGENCY PURCHASE ORDER P O #: 7904465				DOCUMENT		DATE	REQUISITION NUMBER	FY		
				TC	AGY	NUMBER				
				PO	042	48507904465	12/31/13	R		14
				(DPA) DIRECT PURCHASE AUTHORIZATION				VENDOR ID NUMBER		
CONTRACT NO	AGENCY REF	BUYER	TERMS					TOTAL AMOUNT		
	PMCHAIR		NONE					\$ 2593.24		

VENDOR NAME AND ADDRESS

RICHARD STOCKTON COLLEGE OF NJ
JIMMIE LEEDS ROAD
POMONA NJ 08240

SHIP F.O.B. DESTINATION TO:

WATER RESOURCES PLANNING/MANAGEMENT (424850/S005)
WATER MONITORING MGT. DEP
35 ARCTIC PARKWAY
PO BOX 427
TRENTON NJ 08625-0422

Direct Purchase or Special Procurement, Indicate Date Quotation Received → **12/26/13**

CONTACT DIANE HUTCHINGS (609) 292-0427

BILL TO:

DEPT OF ENVIRONMENTAL PROTECT
WATER RESOURCES PLANNING/MANAGEMENT (424850/B003)
WATER MONITORING MGT.
35 ARCTIC PARKWAY
PO BOX 427
TRENTON NJ 08625-0422

**IMPORTANT: THIS PURCHASE
ORDER CONTAINS PROMPT
PAYMENT INFORMATION**

VENDOR REFERENCE

BFY	FUND	AGCY	ORG CODE	SUBORG	APPR UNIT	ACTIVITY CD	OBJECT CD	SUB-OBJ	REV SRCE	SUB-REV	PROJECT/JOB NO
14	534	042	4890		005	V6YX	3610				A7571200
1											
2											
3											

RPT CT	AMOUNT
1	2593.24
2	
3	

INSTRUCTIONS TO VENDORS: ENCLOSE PACKING SLIP WITH SHIPMENTS. SUBMIT ALL BILLS ON ATTACHED STATE VOUCHER FORMS. IF PARTIAL BILLING SUBMIT BALANCE ON SEPARATE STATE VOUCHER FORMS. SHOW PURCHASE ORDER NUMBER ON ALL BILLS OF LADING. INVOICES AND CORRESPONDENCE TO THE STATE AGENCY INDICATED ABOVE. N.J.S.A. 54:32B-1 ET SEQ. EXEMPTS NJ STATE AGENCIES FROM SALES OR USE TAXES. DO NOT INCLUDE THEM IN YOUR PRICE.

ITEM NO.	COMMODITY CODE/DESCRIPTION OF ITEM	QUANTITY	UNIT	UNIT PRICE	AMOUNT
00001	DELIVERY: 007WEEKS ARO COMMODITY CODE: 961-48-000000 [LABORATORY AND FIELD TESTING SERVICES...] ITEM DESCRIPTION: COLLECTION OF SIX(6) SEDIMENT CORE SAMPLES FROM TWILIGHT LAKE, BAYHEAD, NJ SERVICE INCLUDES EQUIPMENT AND SUPPLIES NECESSARY TO OBTAIN SAMPLES	1.000	EACH	2593.24	\$ 2593.24

AGENCY APPROVAL: This transaction is authorized by the Director, Division of Purchase and Property in accordance with the provision of Chap. 107 P.L. 1985 as amended. The issuing Agency's Approval Officer's signature guarantees compliance with all provisions governing the authorization granted by the Director. Signature affixed to this document serves as certification that: 1) items purchased under DPA authorization are not currently available under the provisions of a current State contract, nor from the State Distribution Center, nor from DEPTCOR (State Use Industries); 2) funds required and authorized for this purpose are available. Unauthorized use is subject to prosecution.

 Authorized Signature

 Title

12/31/13
 Date

Davis, Mark

From: Davis, Mark
Sent: Thursday, August 22, 2013 10:51 AM
To: 'Gruppuso, Karen'
Subject: RE: Twilight Lake - Sampling Plan Request for Expanded Dredge Area
Attachments: Twilight Lake Locations.pdf

Karen,

I've limited the sampling as much as possible based on the existing data and the propose volume of material to be dredged. The additional sampling to characterize the expanded dredge area should consist of six (6) individual core samples (3 from the east side of the lake and 3 from the west). Re-sampling of the previous sampling locations is not required, unless the County chooses to do so. Also, keep in mind that the Ocean County Landfill may have independent sampling requirements. You should contact the landfill to confirm any additional sampling that they may require.

Core Samples:

Six (6) individual core samples are prescribed for the expanded dredging activity. The sample locations are delineated on the attached site plan (sample locations shown in red only). All core samples shall be taken to the proposed project depth.

Preliminary Grain Size Analysis

The six (6) core samples shall be individually analyzed for grain size, total organic carbon, and percent moisture.

Composite Sample Scheme:

Following the preliminary grain size analysis required above the core samples shall be composited as specified below. Note that if the grain size analysis of an individual core indicates that the dredged material is 90% or greater sand (> 0.0625 mm), no further analytical testing is required on those cores and they would not need to be included in the composite sample.

Composite East = Cores A, B, and C; and
Composite West = Cores D, E, and F.

All core samples shall be obtained by qualified personnel. Core logs for each sample core shall be obtained. The specific guidelines for homogenizing and compositing cores are specified on pages 9-11 and Appendix A of the Dredging Manual. The applicant shall obtain Department approval prior to implementing changes to the compositing scheme listed here.

Composite Sample Analysis:

Each composite sample shall be analyzed for the following:

1. Grain size;

2. Total Organic Carbon;
3. Percent moisture;
4. Bulk sediment chemistry for the target analytes found in Appendix B, Attachment 1, of the Dredging Manual consisting of semi-volatile organics, pesticides, aroclors, and inorganics (excluding volatiles, and dioxins); and

Note: Samples should be analyzed for both total chromium and hexavalent chromium.

All data packages shall comply with the QA/QC requirements outlined in Appendix B of the NJDEP Dredging Manual

The laboratory used to perform the testing required herein must be certified by the Department for the particular analytical method performed. Please verify current certification status with the Office of Quality Assurance (609) 292-3950. The Department recommends verifying the volumes required for the needed tests with the laboratories prior to sampling. Please be advised that all holding times and minimum detection limits as referenced in the Department's Dredging Manual must be met,

Please contact me with any questions.

Mark C. Davis

Office of Dredging and Sediment Technology
NJ Department of Environmental Protection
P.O. Box 420
Mail Code #401-06C
401 East State Street
Trenton, NJ 08625
Phone: (609) 633-1357

From: Gruppuso, Karen [<mailto:Gruppuso@taylorwiseman.com>]
Sent: Wednesday, August 21, 2013 1:53 PM
To: Davis, Mark
Cc: FScarantino@co.ocean.nj.us; Rob Mulloy; Wingate, Thomas A
Subject: Twilight Lake - Sampling Plan Request for Expanded Dredge Area
Importance: High

Mark,

Attached please find a sediment sampling and analysis plan request for the proposed expanded dredging at Twilight Lake. As discussed this morning, the pre- and post-storm bathymetry on the attached plans show a layer of sand deposited by Superstorm Sandy throughout the lake. Please issue a sediment sampling and analysis plan as soon as possible. Thank you for your prompt attention to this request.



<<08-21-13 Sampling Plan Request.pdf>>

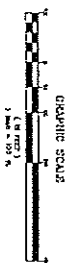
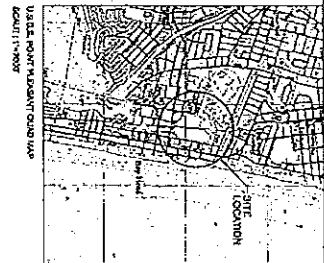

Sincerely,

Karen

This e-mail message has been scanned for Viruses and Content and cleared by MailMarshal



 SOIL SAMPLE LOCATION
 PROJECTS SAMPLE LOCATION

 Taylor, Whittman & Taylor <small>INCORPORATED</small> 1000 N. W. 10th St., Suite 100 Fort Lauderdale, Florida 33304 Phone: (305) 441-1111	EDWARD V. BRADY	 EDWARD V. BRADY PROFESSIONAL ENGINEER STATE OF FLORIDA No. 12345 Exp. 12/31/2025	PROJECT NO. 2024-001 SHEET NO. 1 OF 1
	PROJECT NO. 2024-001 SHEET NO. 1 OF 1		PROJECT NO. 2024-001 SHEET NO. 1 OF 1

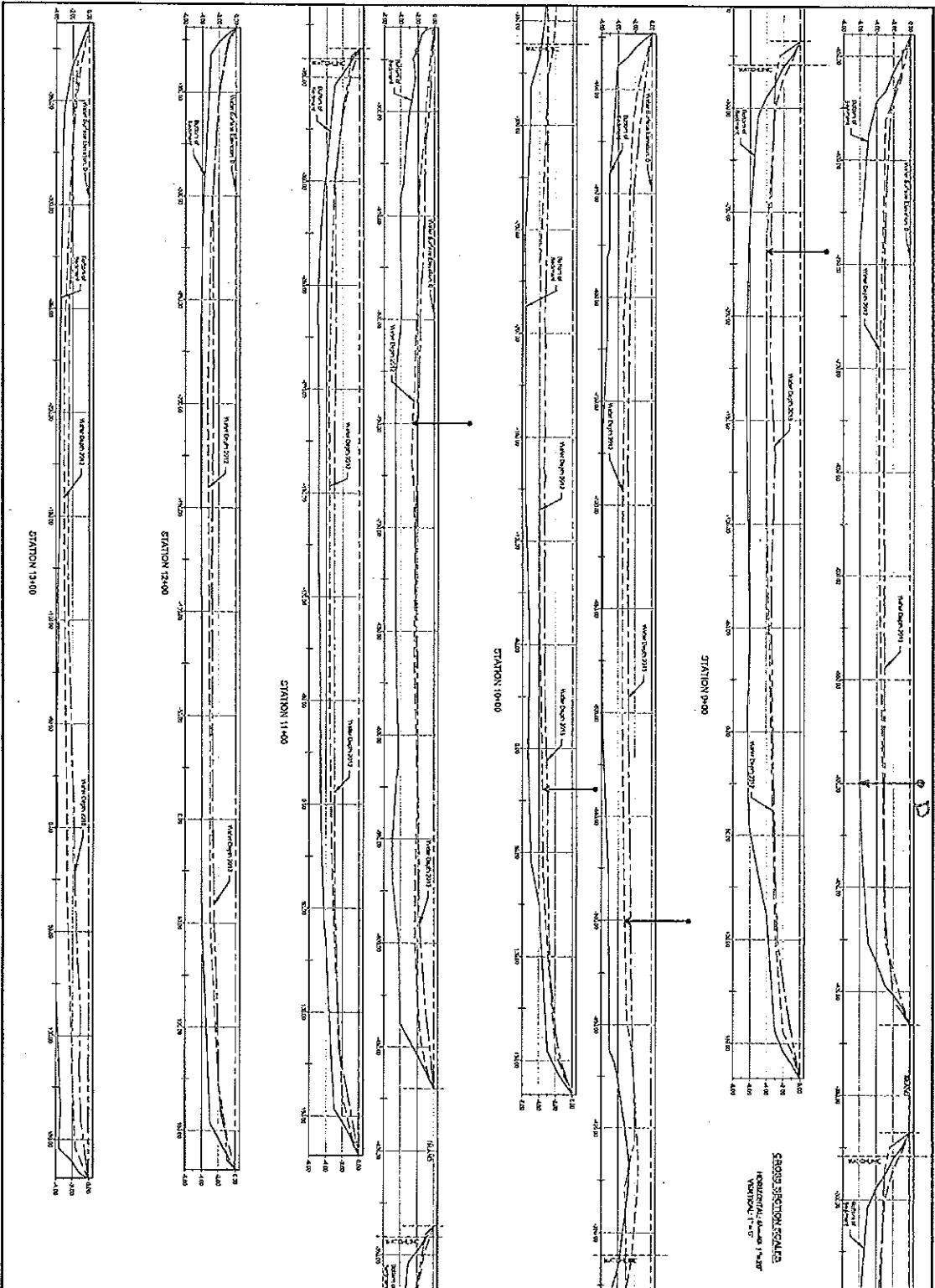

CALL BEFORE YOU DIG!
 A WARNING SIGN MUST BE PLACED AT THE BEGINNING AND END OF ANY EXCAVATION. CALL 800-4-A-HEAD (4273) FOR MORE INFORMATION.
 1-800-272-1000

PROJECT NOTES

1. The proposed road is to be constructed on the existing ground.
2. The proposed road is to be constructed on the existing ground.
3. The proposed road is to be constructed on the existing ground.
4. The proposed road is to be constructed on the existing ground.
5. The proposed road is to be constructed on the existing ground.

STAKEPLACING LOCATION

DATE: _____

BY: _____

FOR: _____

PRINCETON HYDRO LTD.

SCHEIDT AND ENGINEERS
 1100 OLD YORK ROAD, SUITE 1
 PRINCETON, NEW JERSEY 08540
 TEL: 609-953-3000
 FAX: 609-953-3001
 WWW.PRINCETONHYDRO.COM

CROSS SECTIONS

DATE: _____

BY: _____

FOR: _____

7

OF

8

The Coastal Research Center

Ph: 609.652.4245
Fax: 609.748.0656

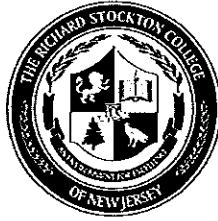

30 Wilson Avenue
Port Republic, NJ 08241
www.stockton.edu/crc

THE RICHARD STOCKTON COLLEGE OF NEW JERSEY

Mr. David Rosenblatt, NJDEP
Division of Engineering and Construction
1510 Hooper Avenue
Toms River, NJ 08753

November 13, 2013

Dear Mr. Rosenblatt,

The Richard Stockton College Coastal Research Center is submitting a proposal following a request to conduct sediment coring in Twilight Lake, Bay Head, NJ. The purpose is to obtain samples for chemical testing should the samples appear to consist of less than 90% sand by volume. There should be two composite samples each consisting of three separate cores combined in the field and put into containers supplied by the selected laboratory assigned to conduct chemical analysis.

This work will take one day for a crew of two using our 16-foot boat since the lake is small and fairly shallow with no existing means to launch our larger center console vessel we normally use for these projects.

This effort also involves NJDEP folks as oversight from Victor Poretti, Section Chief, NJDEP Bureau of Freshwater and Biological Monitoring. Mr. Poretti contacted us on November 7th regarding the potential to conduct this sampling.

Please examine this proposal and let me know if the scope and intent meets your needs.

Sincerely,

A handwritten signature in cursive script that reads "Stewart Farrell".

Dr. Stewart Farrell, Executive Director
Coastal Research Center