



State of New Jersey
Department of Environmental Protection
Geological Survey



Information Disclaimer

The State of New Jersey makes great effort to provide secure, accurate and complete information. However, portions of the information contained here may be incorrect or not current.

The State of New Jersey, its officers, employees or agents shall not be liable for damages or losses of any kind arising out of or in connection with the use or performance of information, including but not limited to, damages or losses caused by reliance upon the accuracy or timeliness of any such information, or damages incurred from the viewing, distributing, or copying of those materials.

The materials and information provided here are provided "as is." No warranty of any kind, implied, expressed, or statutory, including but not limited to the warranties of non-infringement of third party rights, title, merchantability, fitness for a particular purpose, and freedom from computer virus, is given with respect to the contents of this document.

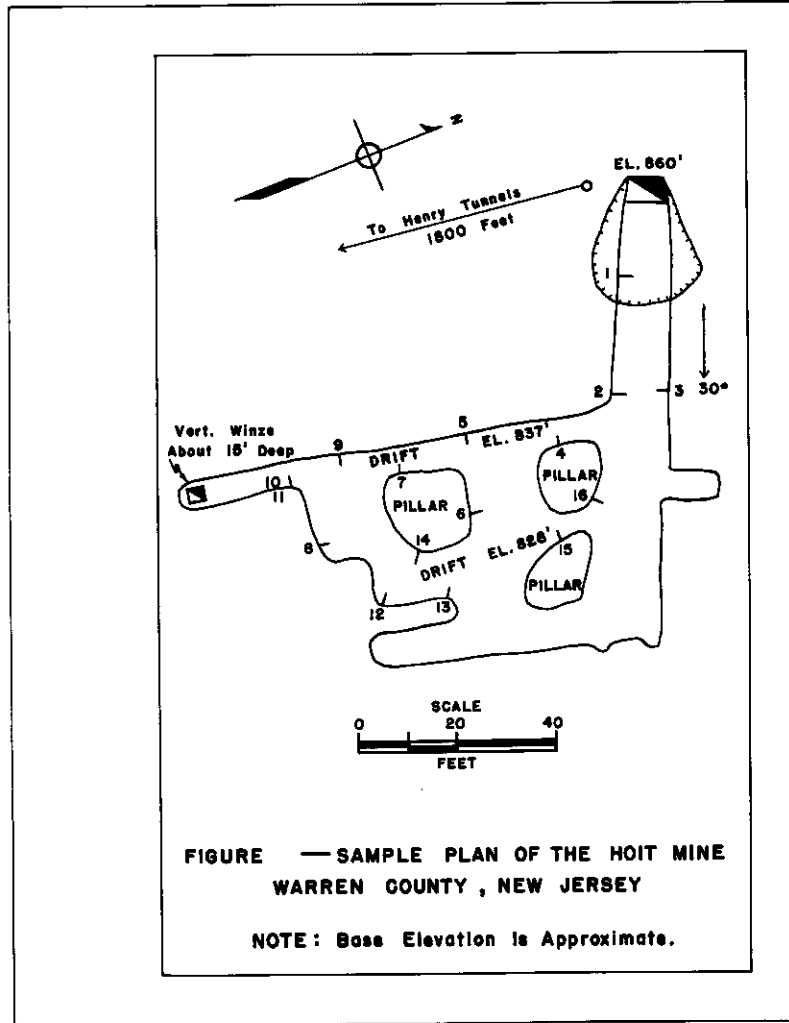

4-2015

30002

391

14.5:1

300820

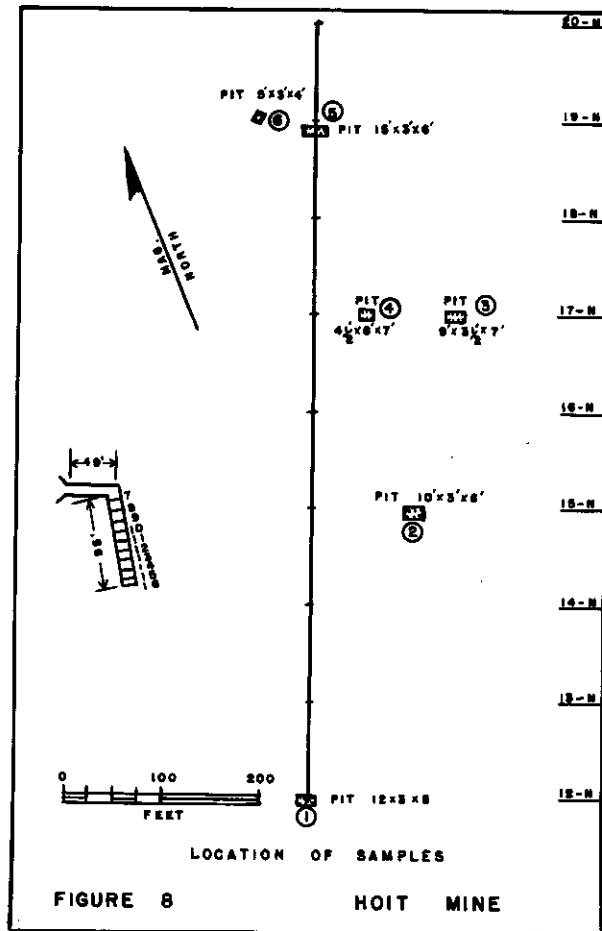

30002 420 14.5.1 300849

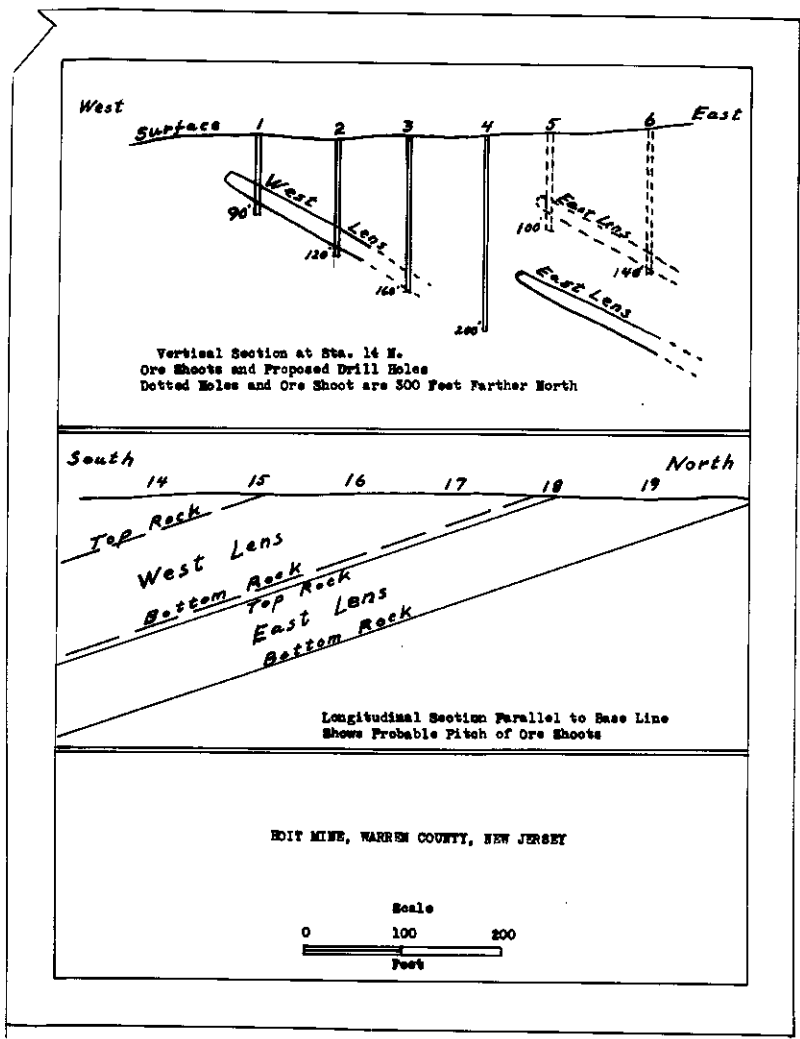

H. 227

30002 394 14.5.1 300823

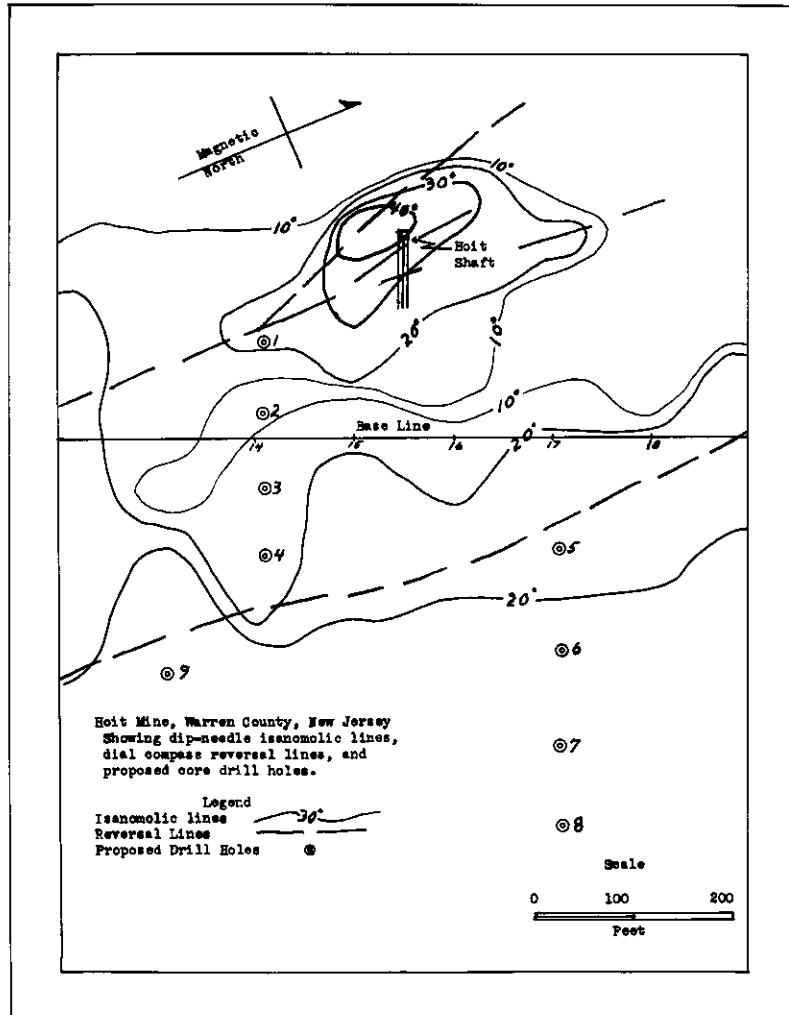

30002 393 | 14.5.1 3008 22

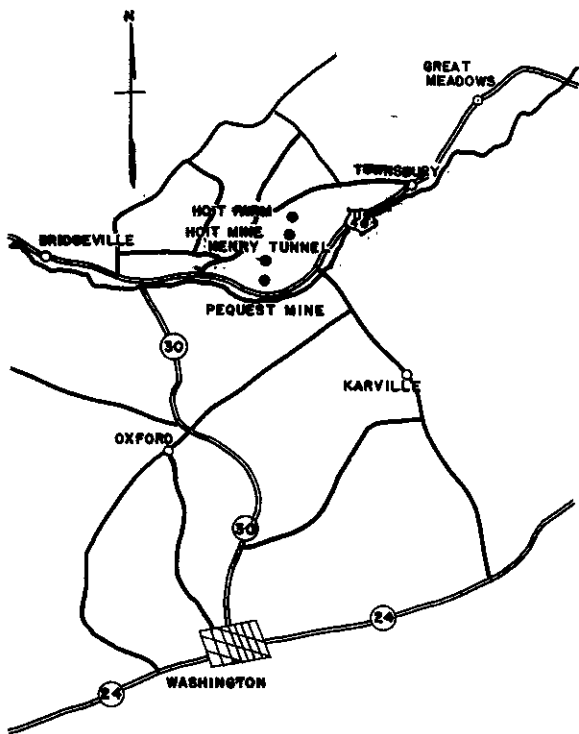

U. S. DEPARTMENT OF THE INTERIOR
 BUREAU OF MINES
 LOCATION OF HOIT FARM,
 HOIT MINE, HENRY TUNNEL, PEQUEST MINE
 WARREN COUNTY, NEW JERSEY



PROJ. ENG. _____ DISTRICT ENG. _____
 DATE _____ PROJECT _____ MAP No. _____

819

Handwritten initials and a date: A-3-41

30002 390 14.5.1 300819

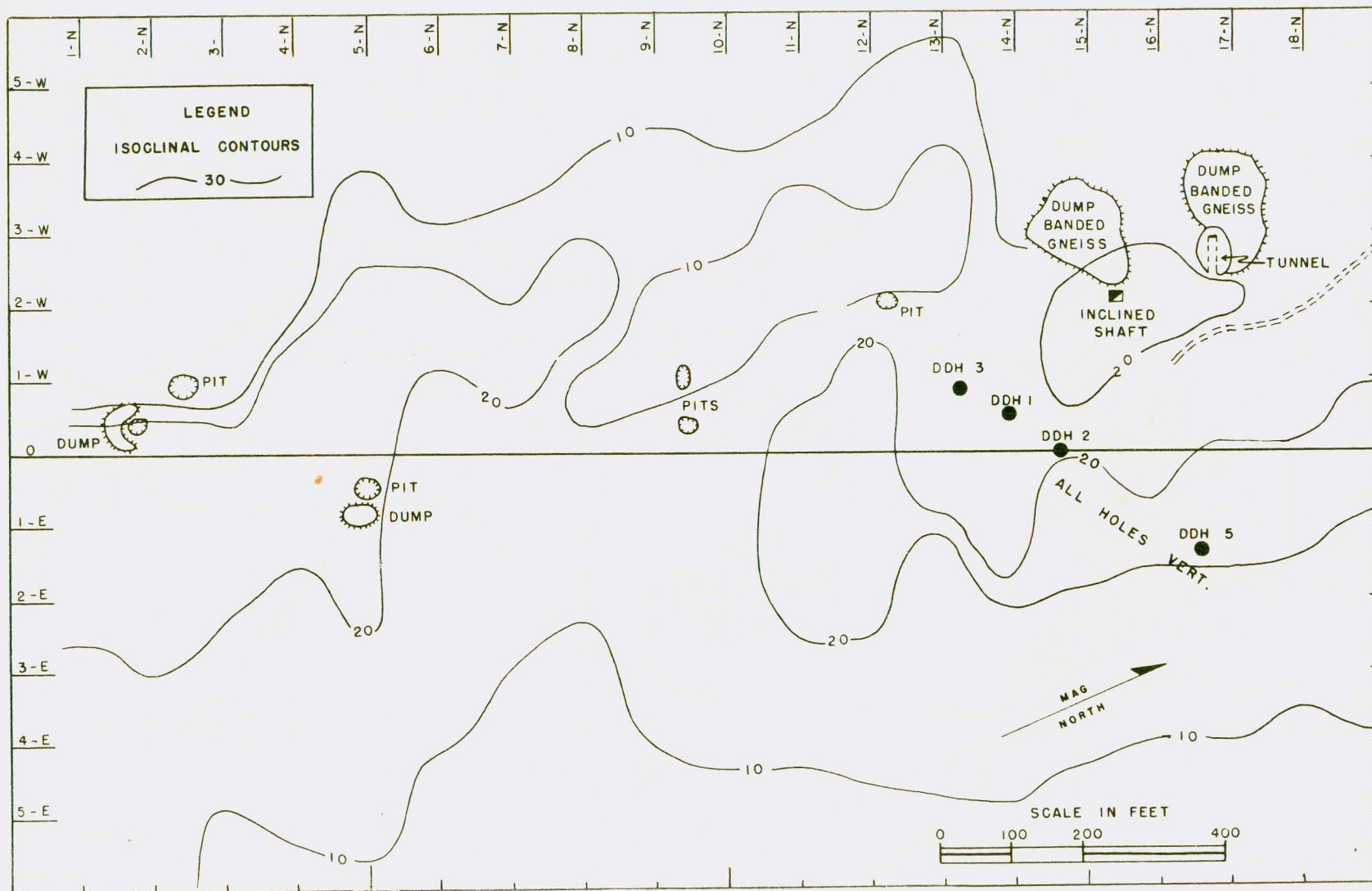

Figure 5. - Hoit mine area.

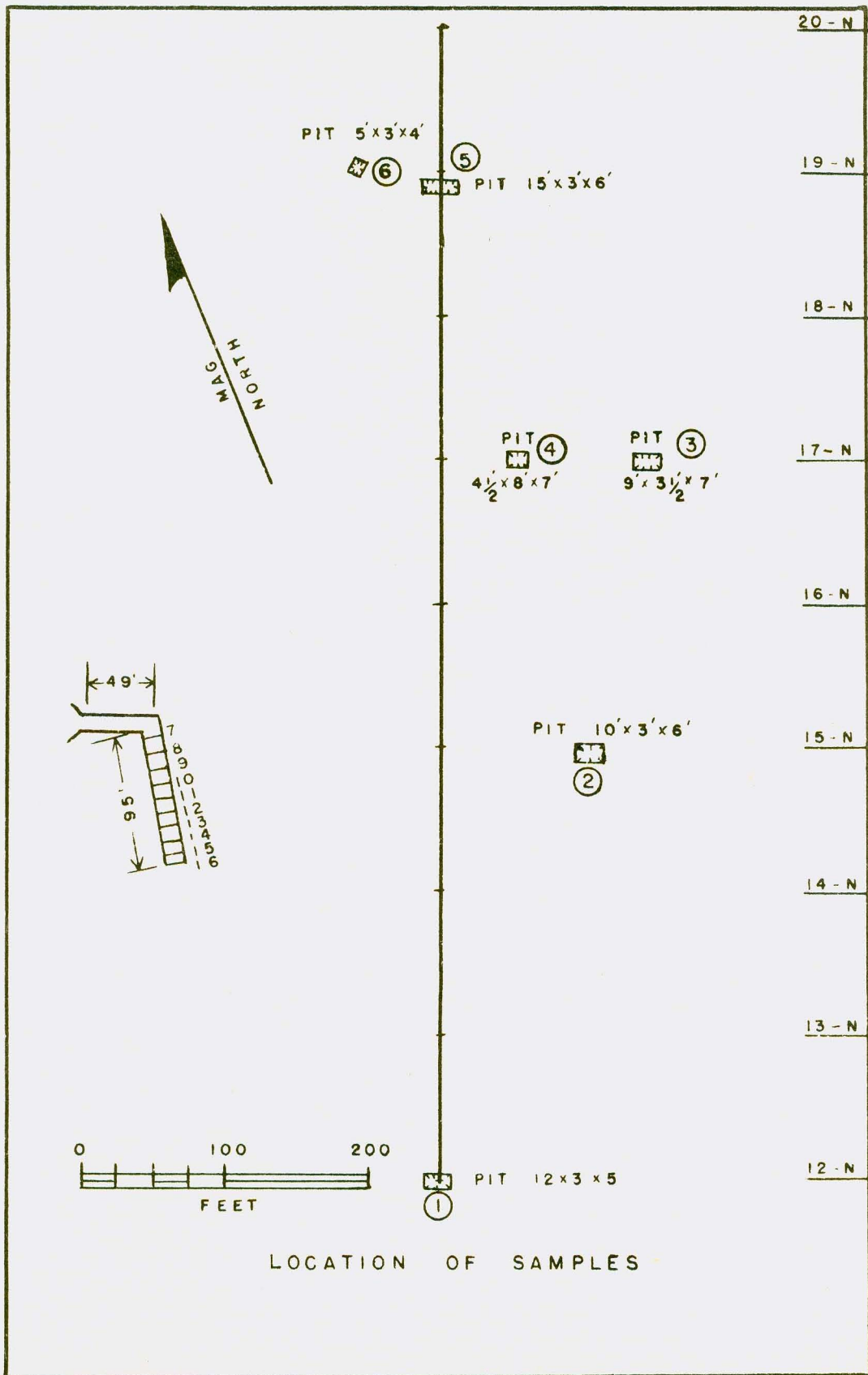

Figure 8. - Hoit mine.

Dip-needle survey of Hoyt mine, Hope Twp., Warren County

HENRY TUNNEL IS IMMEDIATELY SOUTH OF THIS PROPERTY

THE BASE LINE ON THIS PROPERTY IS STARTED AT THE UPPER MOST HENRY TUNNEL, THENCE 150 N. 21°30' W TO STATION ON THIS BASE LINE, THENCE N 22°30' E. FOR 5400'

MAGNETIC NORTH

HOYT FARM EXPLOATION IS IMMEDIATELY NORTH OF THIS PROPERTY

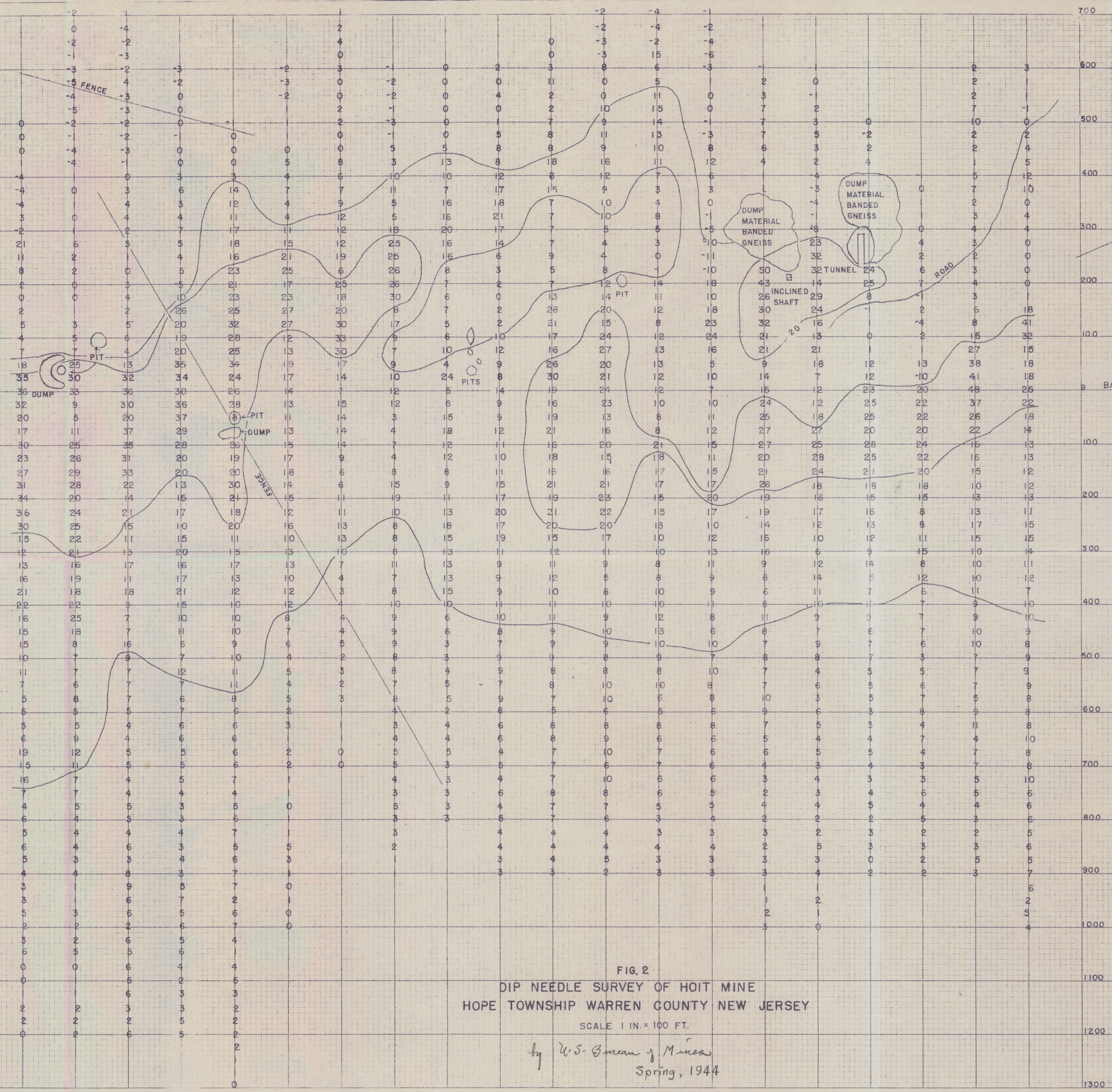

FIG. 2
 DIP NEEDLE SURVEY OF HOYT MINE
 HOPE TOWNSHIP WARREN COUNTY NEW JERSEY
 SCALE 1 IN. = 100 FT.

by W.S. Bureau of Mines
 Spring, 1944

Fig
Hoit
Mine

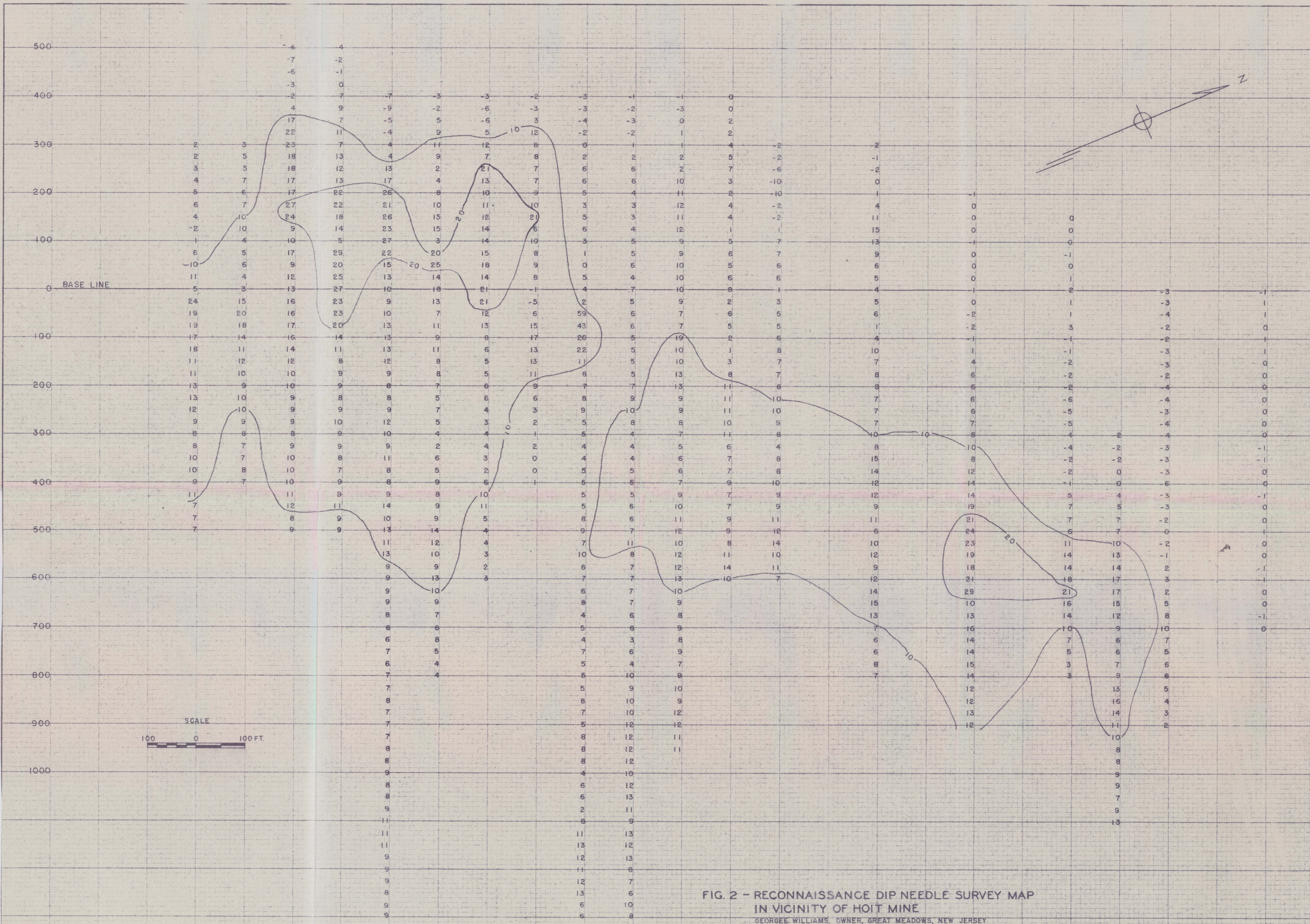

FIG. 2 - RECONNAISSANCE DIP NEEDLE SURVEY MAP
IN VICINITY OF HOIT MINE
GEORGE WILLIAMS, OWNER, GREAT MEADOWS, NEW JERSEY

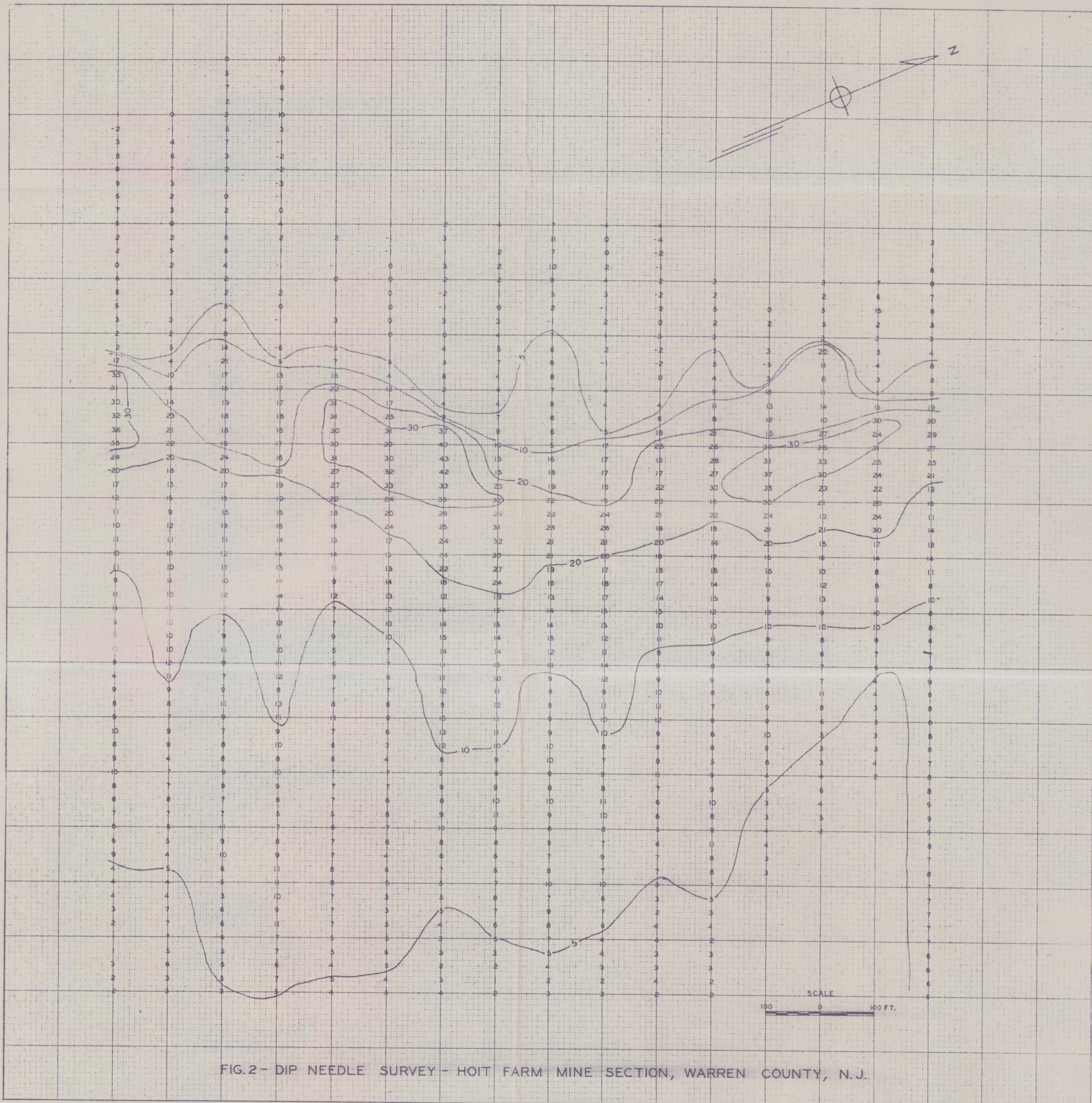
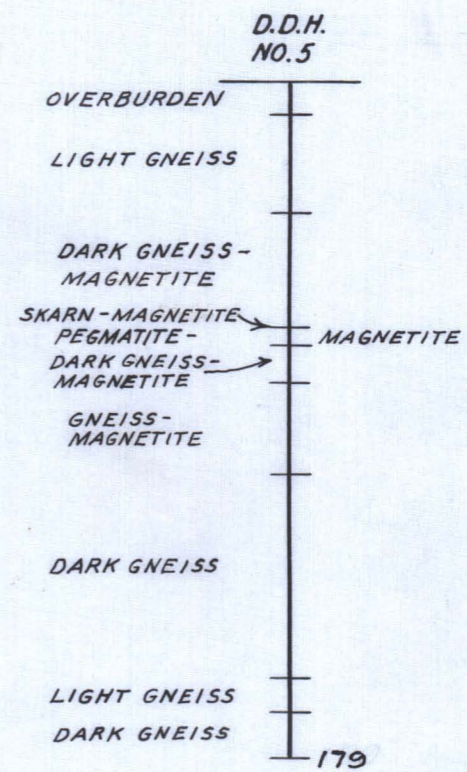
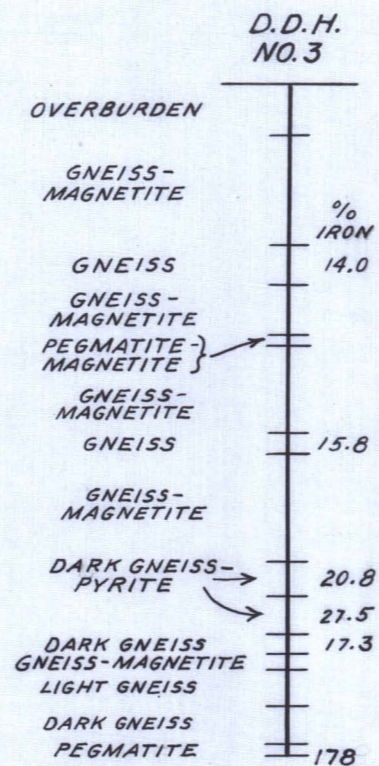
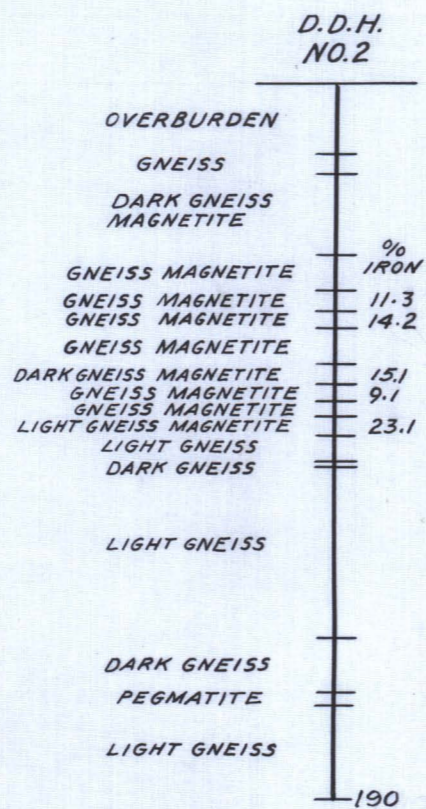
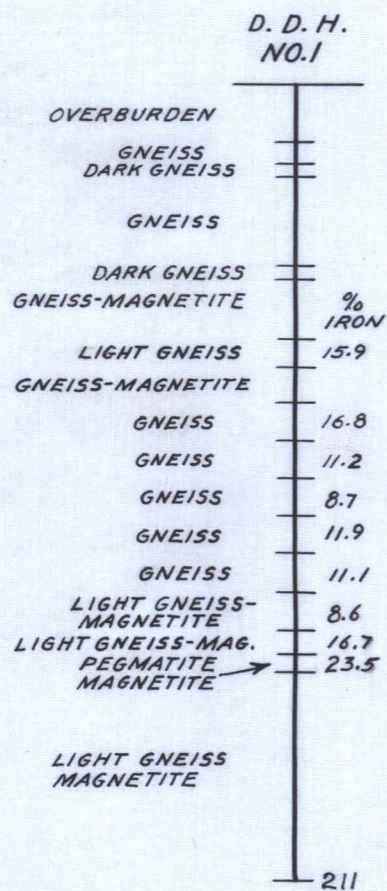

FIG. 2 - DIP NEEDLE SURVEY - HOIT FARM MINE SECTION, WARREN COUNTY, N.J.



Note: No analysis for iron made by Bureau of Mines for D.D.H. No. 5

LEGEND

- OVERBURDEN
- LIGHT GNEISS & GNEISS
- DARK GNEISS
- PEGMATITE

HOIT MINE

DRILLING DONE BY
BUREAU OF MINES 1945
ALL HOLES VERTICAL

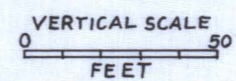

2
ABL