



State of New Jersey
Department of Environmental Protection
Geological Survey



Information Disclaimer

The State of New Jersey makes great effort to provide secure, accurate and complete information. However, portions of the information contained here may be incorrect or not current.

The State of New Jersey, its officers, employees or agents shall not be liable for damages or losses of any kind arising out of or in connection with the use or performance of information, including but not limited to, damages or losses caused by reliance upon the accuracy or timeliness of any such information, or damages incurred from the viewing, distributing, or copying of those materials.

The materials and information provided here are provided "as is." No warranty of any kind, implied, expressed, or statutory, including but not limited to the warranties of non-infringement of third party rights, title, merchantability, fitness for a particular purpose, and freedom from computer virus, is given with respect to the contents of this document.

OSBORNE MINE

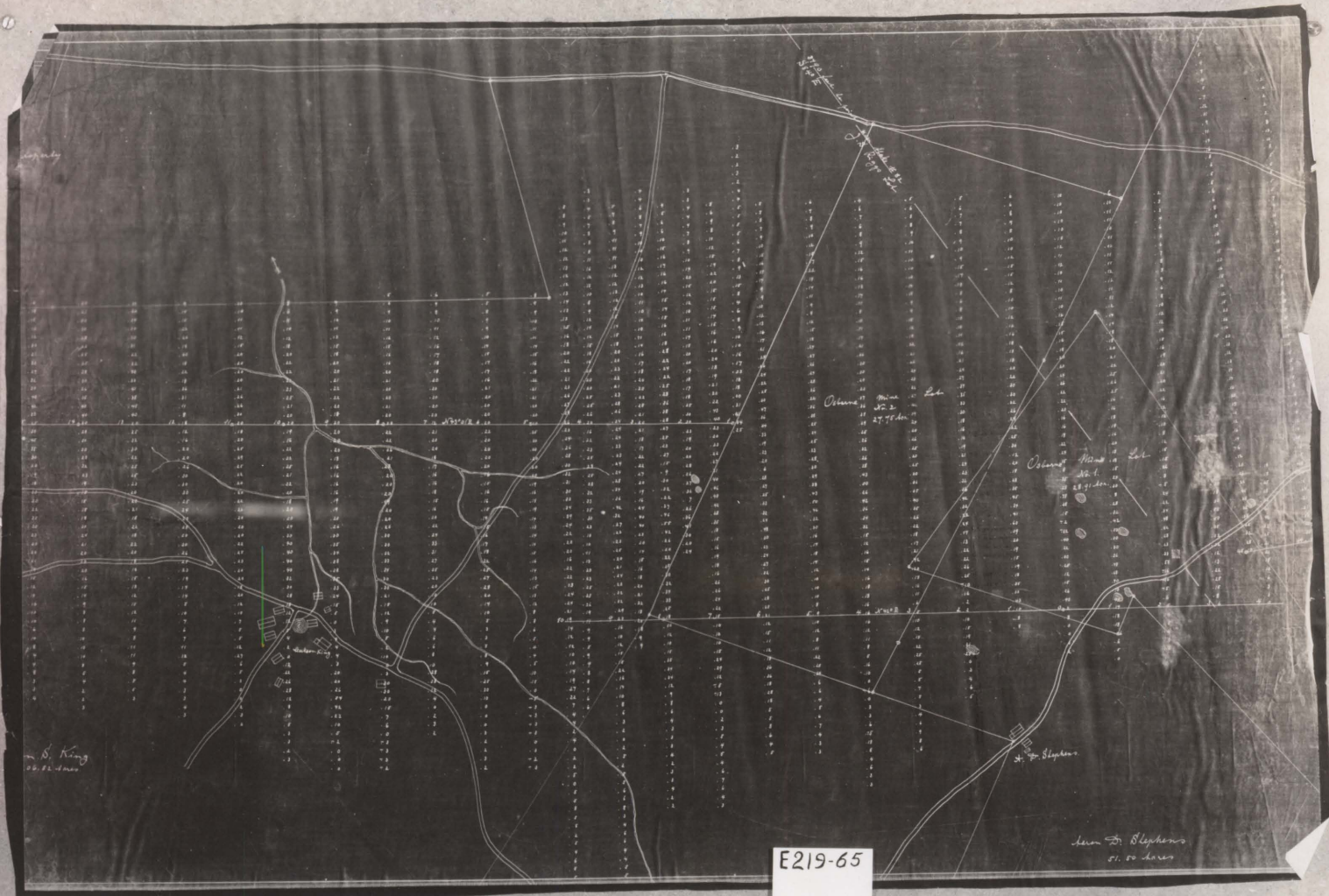

See St. Stephens
51.00 down

OSBORNE MINE AREA

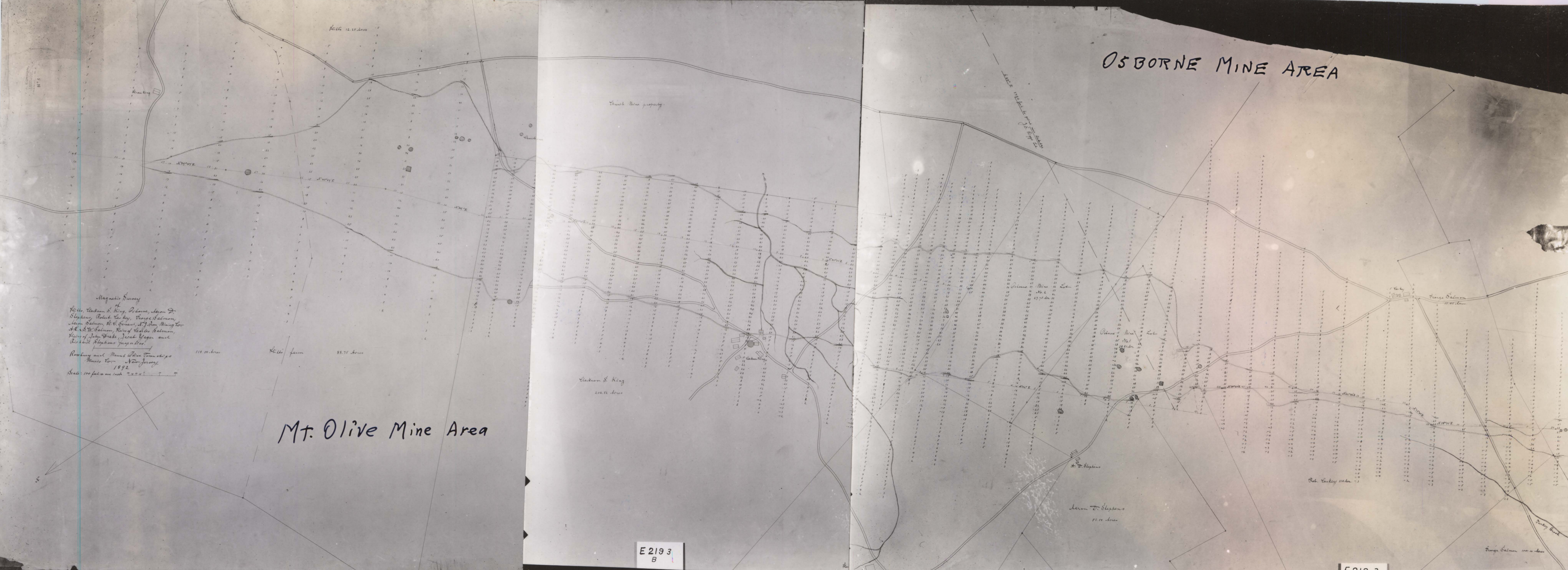

Magnetic Survey
of
Fells, Clarkson S. King, Deane, Leon F.
Stephens, Robert L. Key, George Salmon,
Leon Salmon, H. C. Green, St. John, Minton,
A. H. S. W. Salmon, Robert L. Key, Jacob Egan and
Richard Stephens property

Mt. Olive Mine Area

Hills farm 88.75 acres

Clarkson S. King
206.72 acres

E 2193
B

Leon F. Stephens
51.00 acres

Rob. L. Key 100.00 acres

George Salmon 100.00 acres

E 2193
C

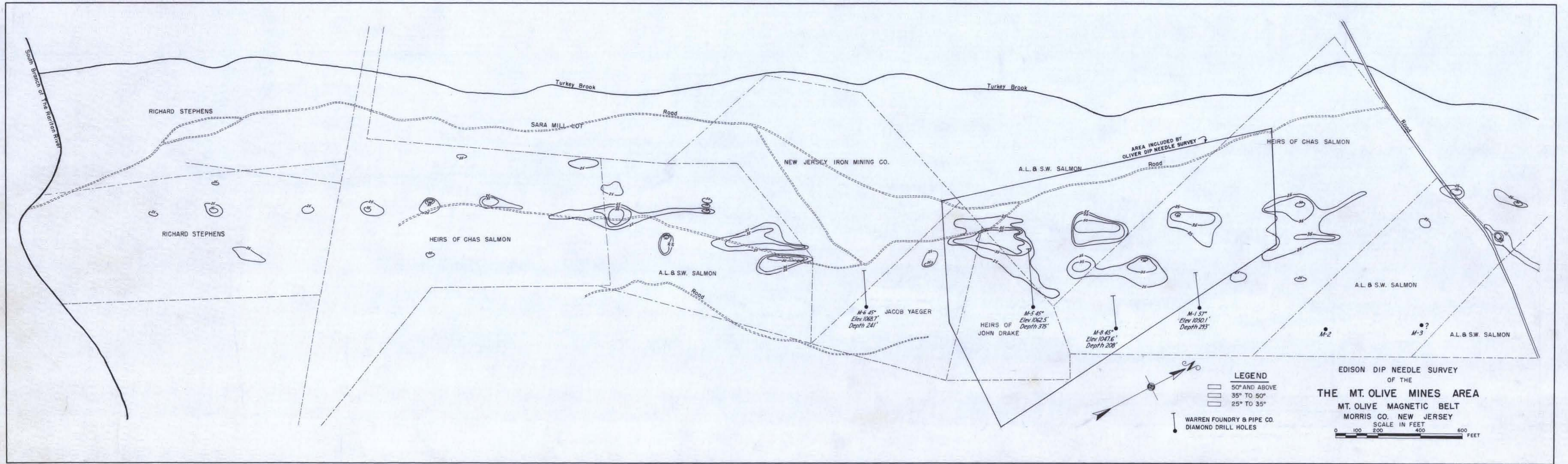

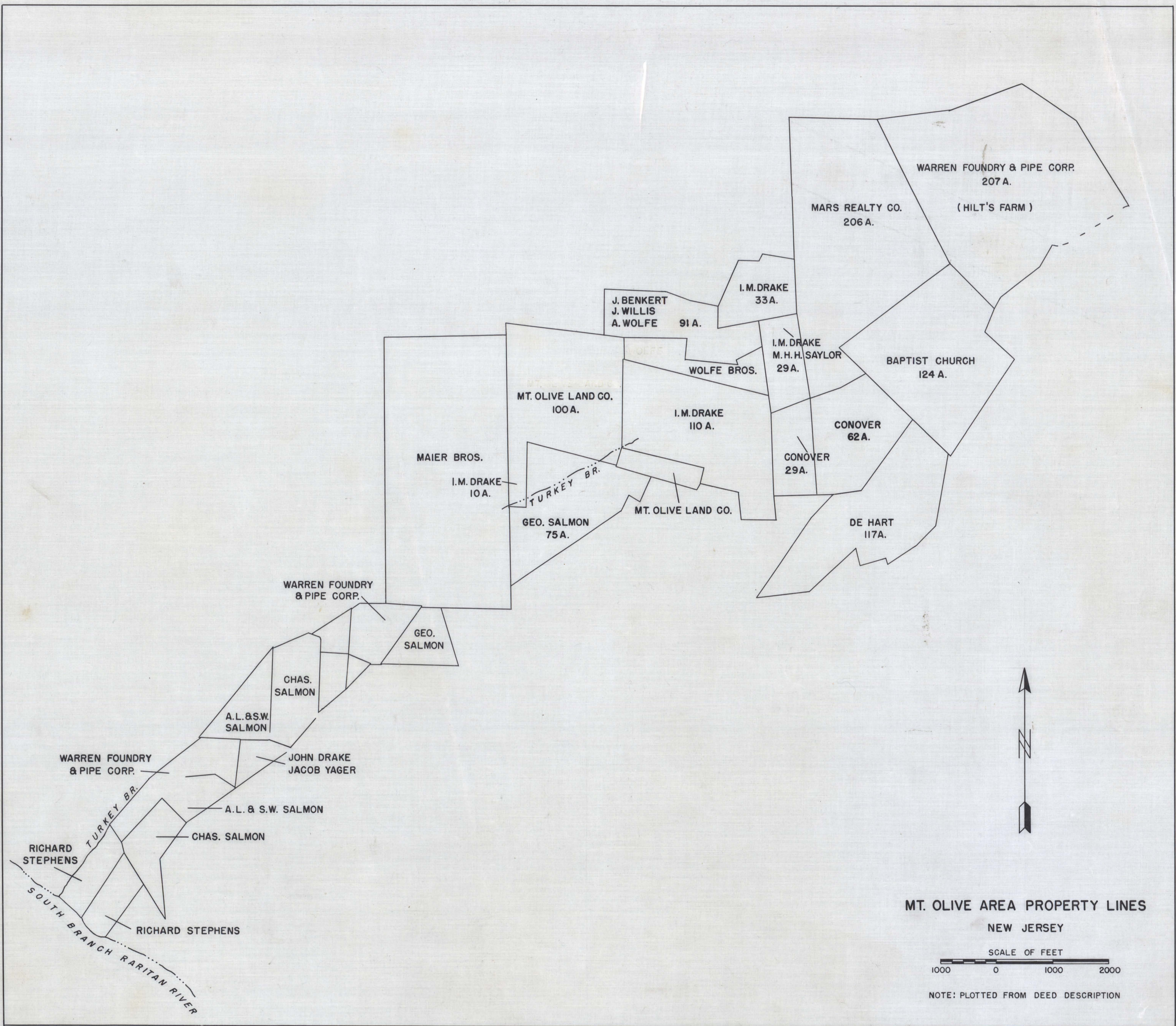

MT. OLIVE AREA PROPERTY LINES

NEW JERSEY



SCALE OF FEET

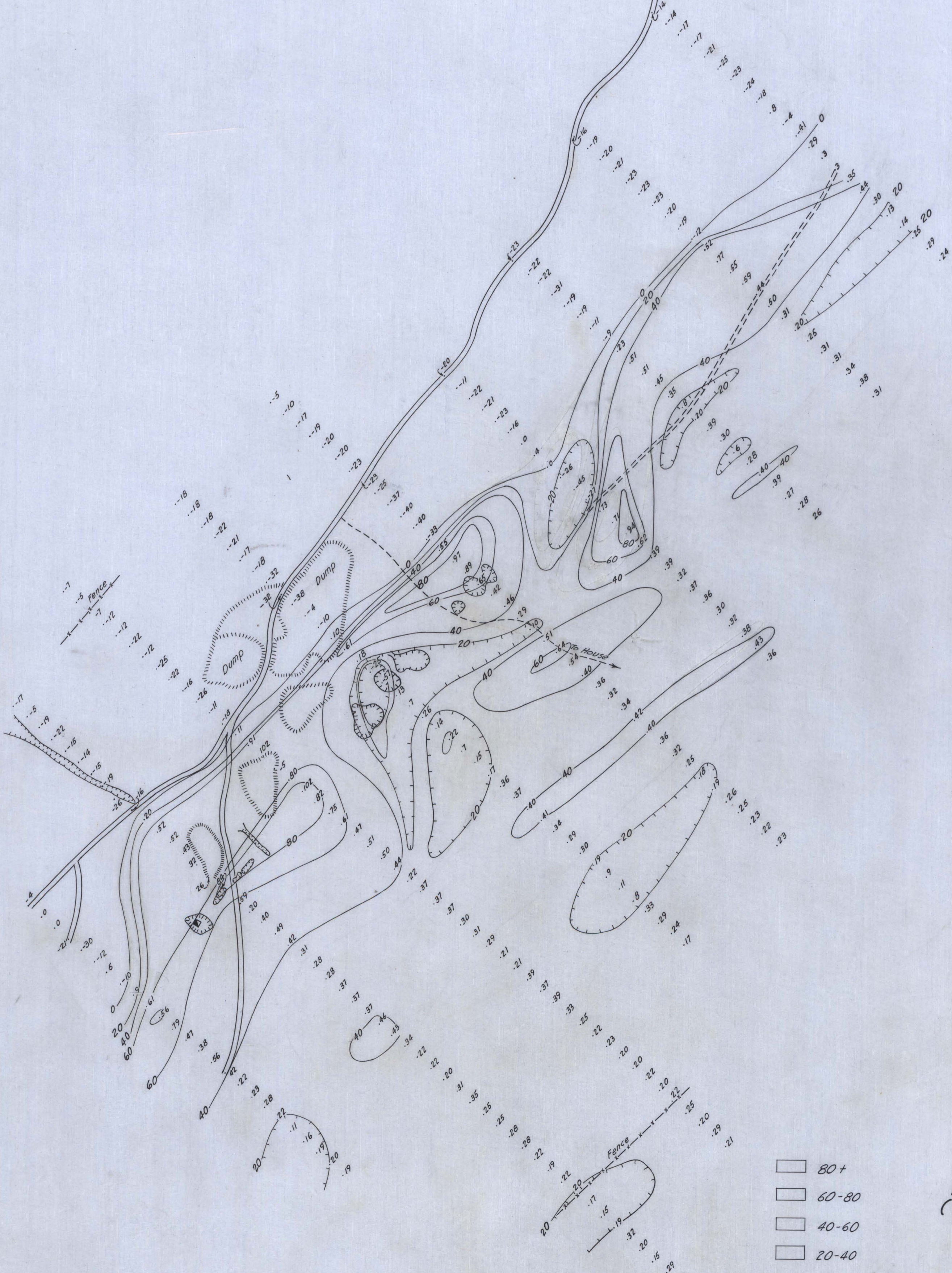

NOTE: PLOTTED FROM DEED DESCRIPTION

to Budd Lake - 1 mile

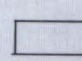
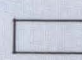
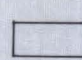

-  80+
-  60-80
-  40-60
-  20-40

DIP NEEDLE MAP
OF THE
MOUNT OLIVE MINES
(MT. OLIVE MAGNETIC BELT)
MORRIS CO, NEW JERSEY

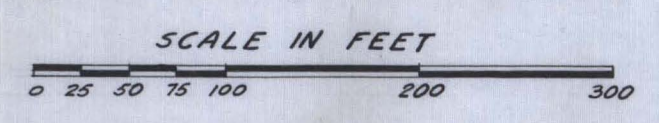

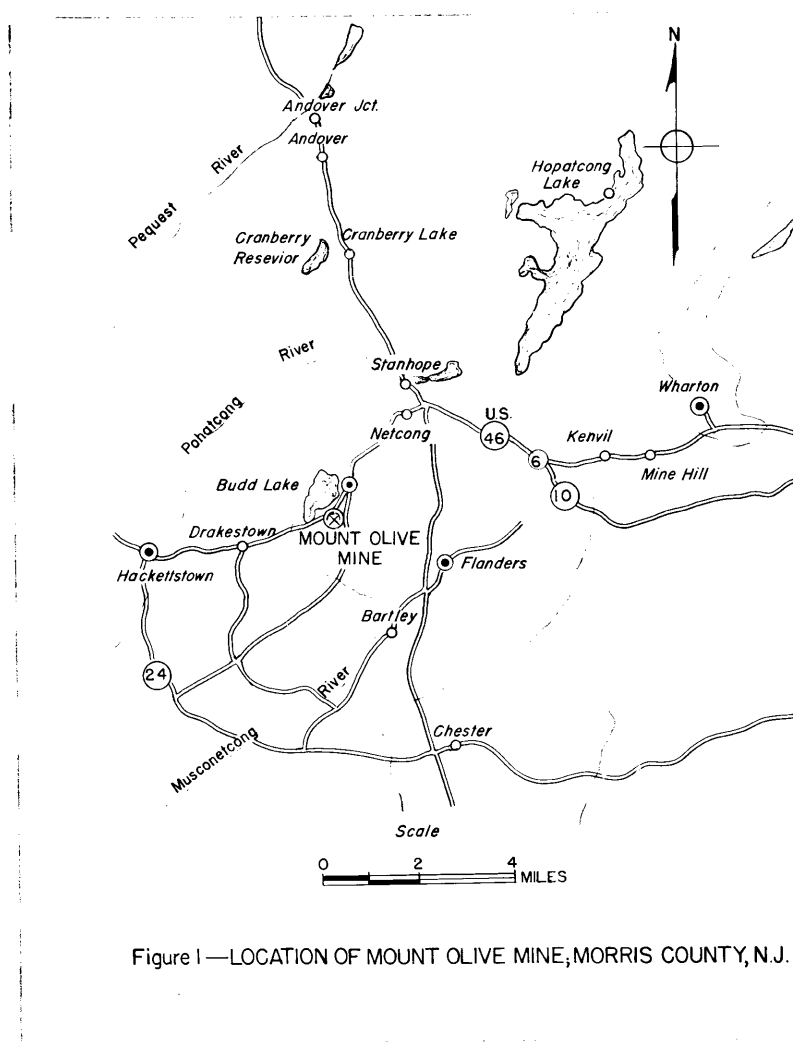

Figure 1—LOCATION OF MOUNT OLIVE MINE, MORRIS COUNTY, N.J.

30002

308

14.5:1

300737

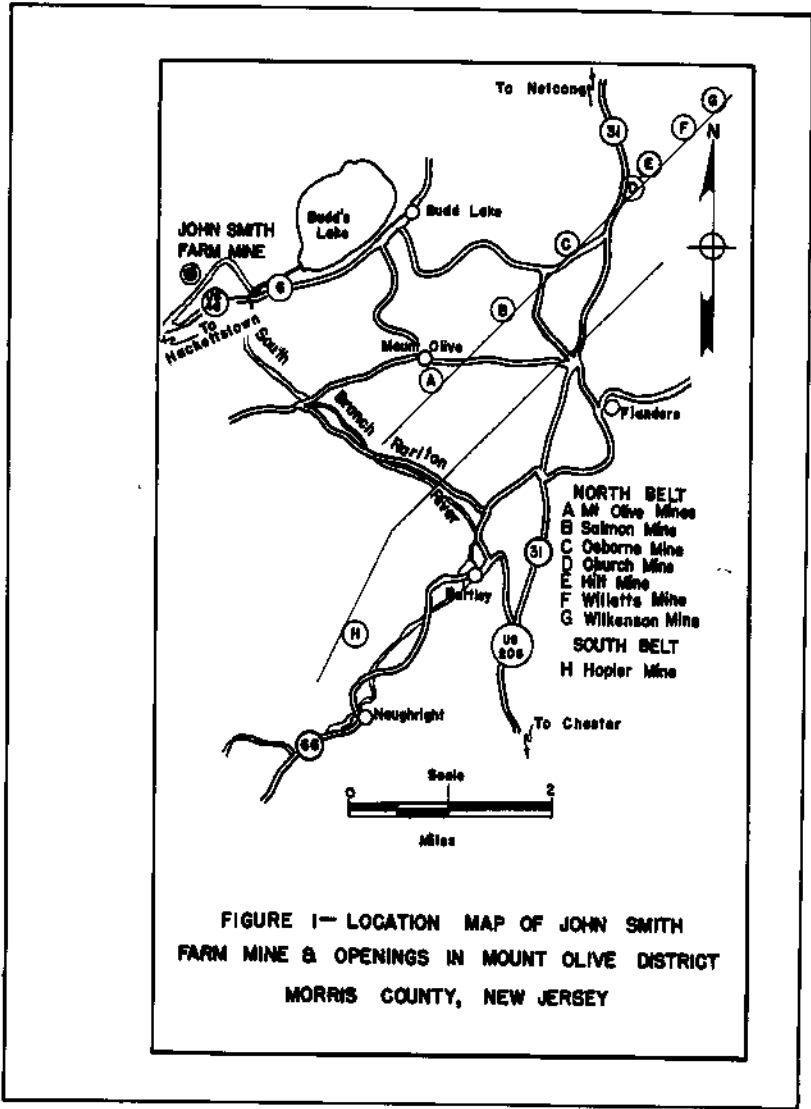
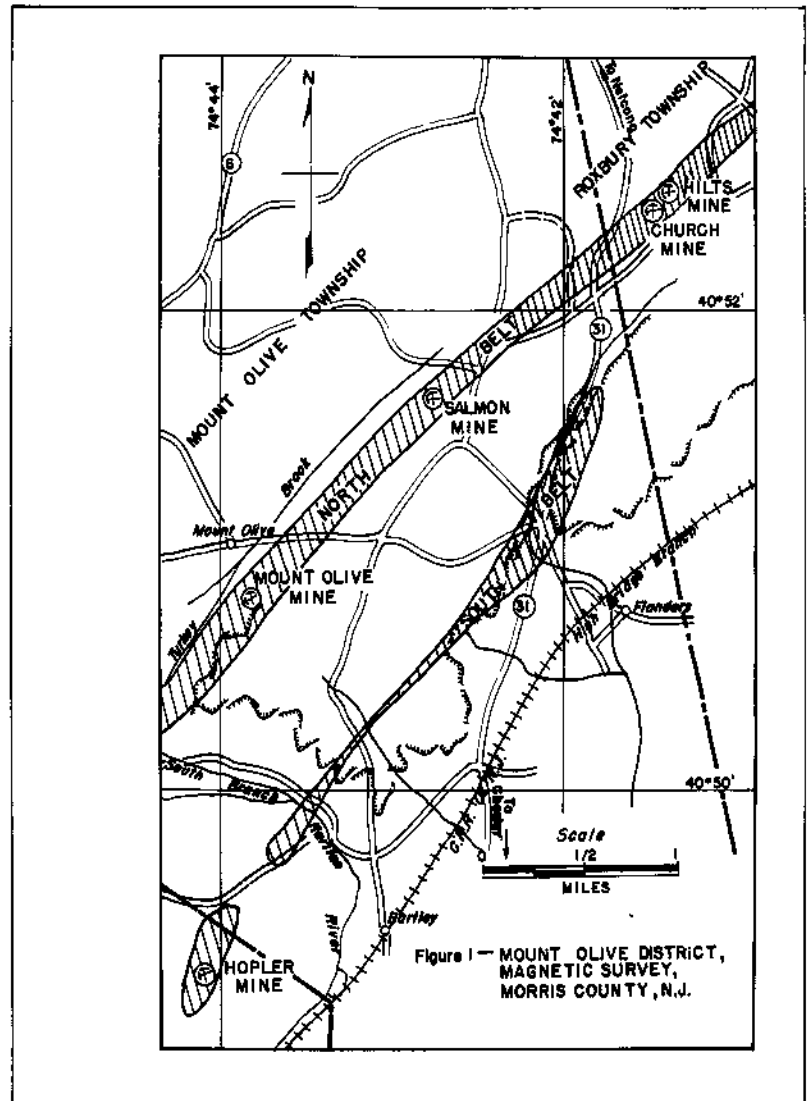

FIGURE 1- LOCATION MAP OF JOHN SMITH FARM MINE & OPENINGS IN MOUNT OLIVE DISTRICT MORRIS COUNTY, NEW JERSEY

A-25

30002 305 14.5.1 300734



A 1857

30002

288

14.5.1

300717

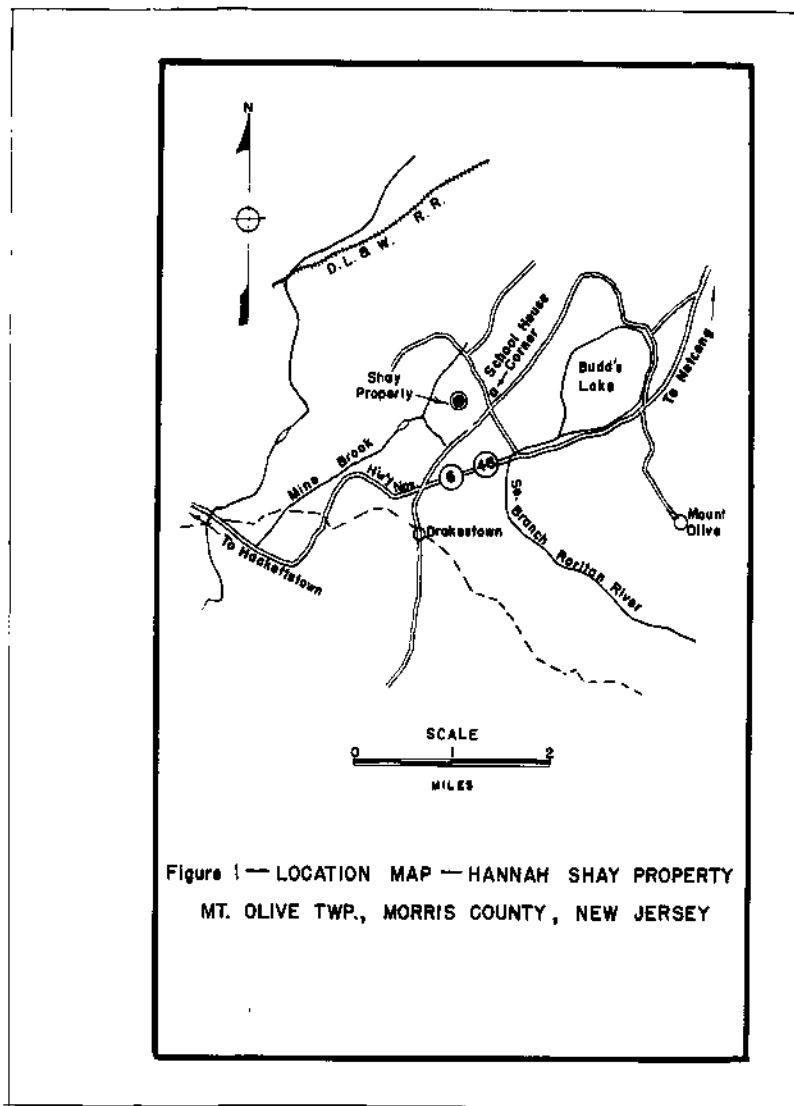

Figure 1 — LOCATION MAP — HANNAH SHAY PROPERTY
 MT. OLIVE TWP., MORRIS COUNTY, NEW JERSEY

A1703

30002

306

14.5:1

300735

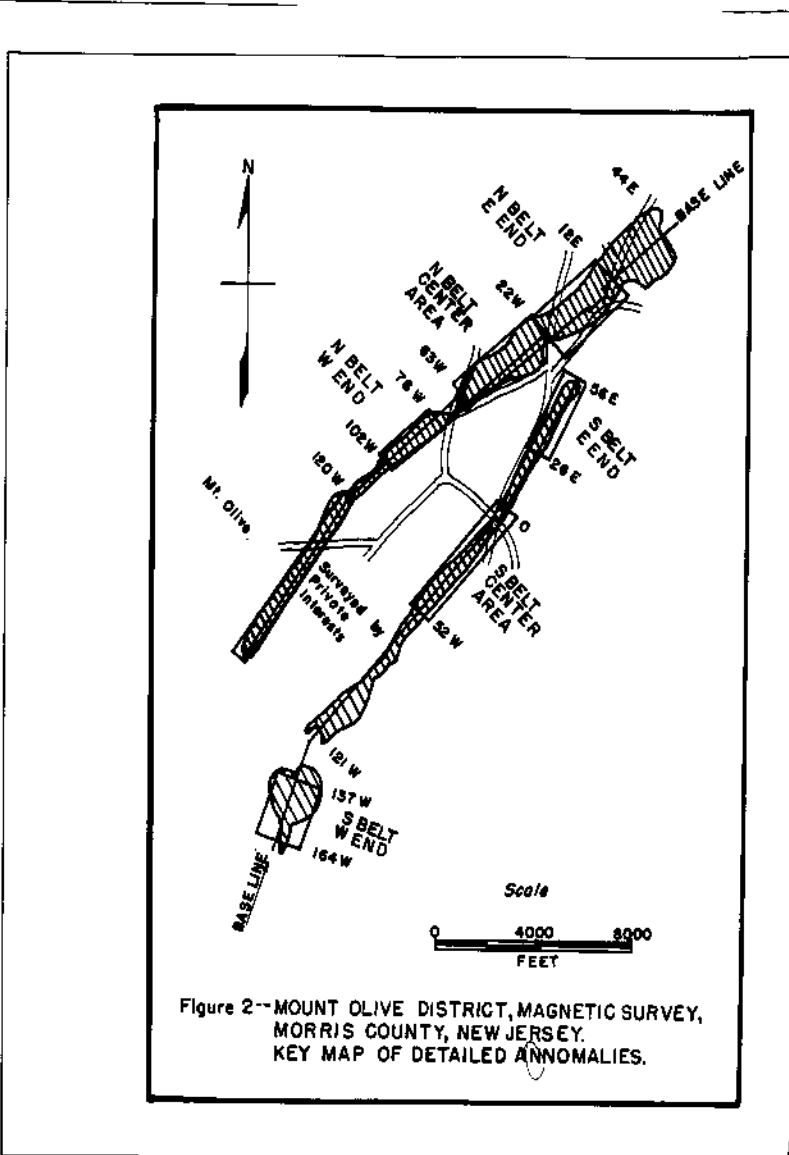

Figure 2--MOUNT OLIVE DISTRICT, MAGNETIC SURVEY,
MORRIS COUNTY, NEW JERSEY.
KEY MAP OF DETAILED ANOMALIES.

A-7858

30002

289

14.5.1

300718

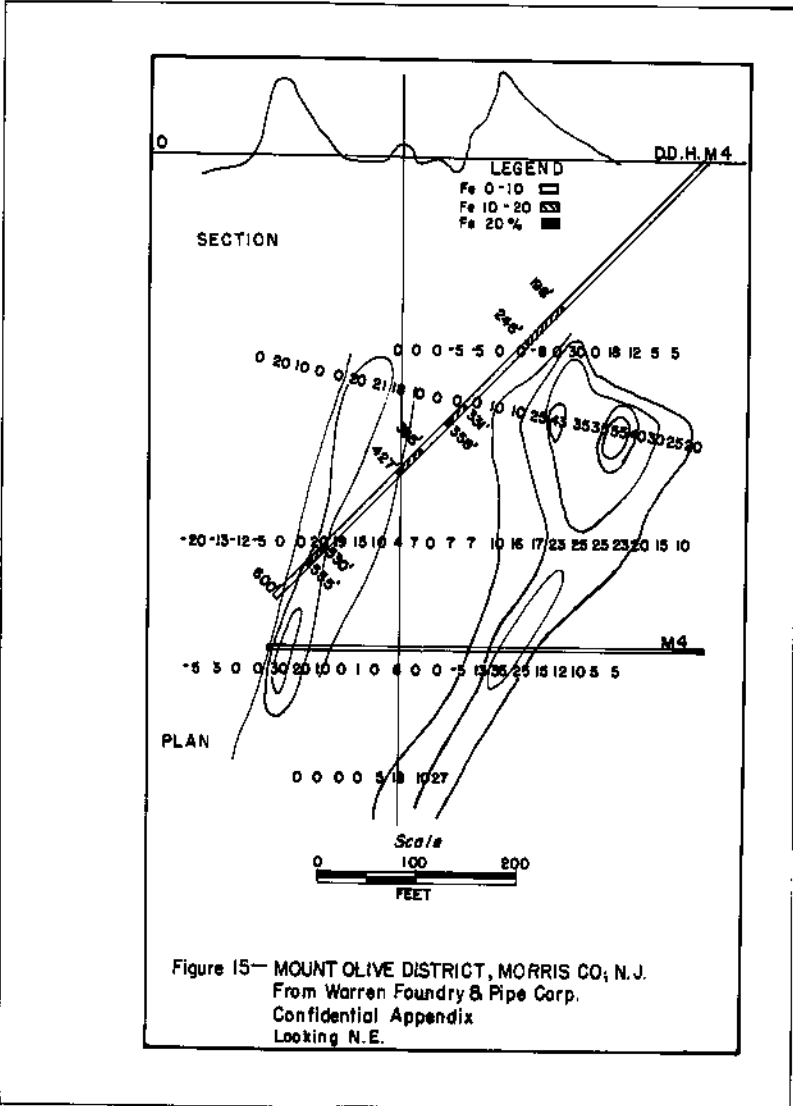

A1E59

30002

290

14.5.1

300719

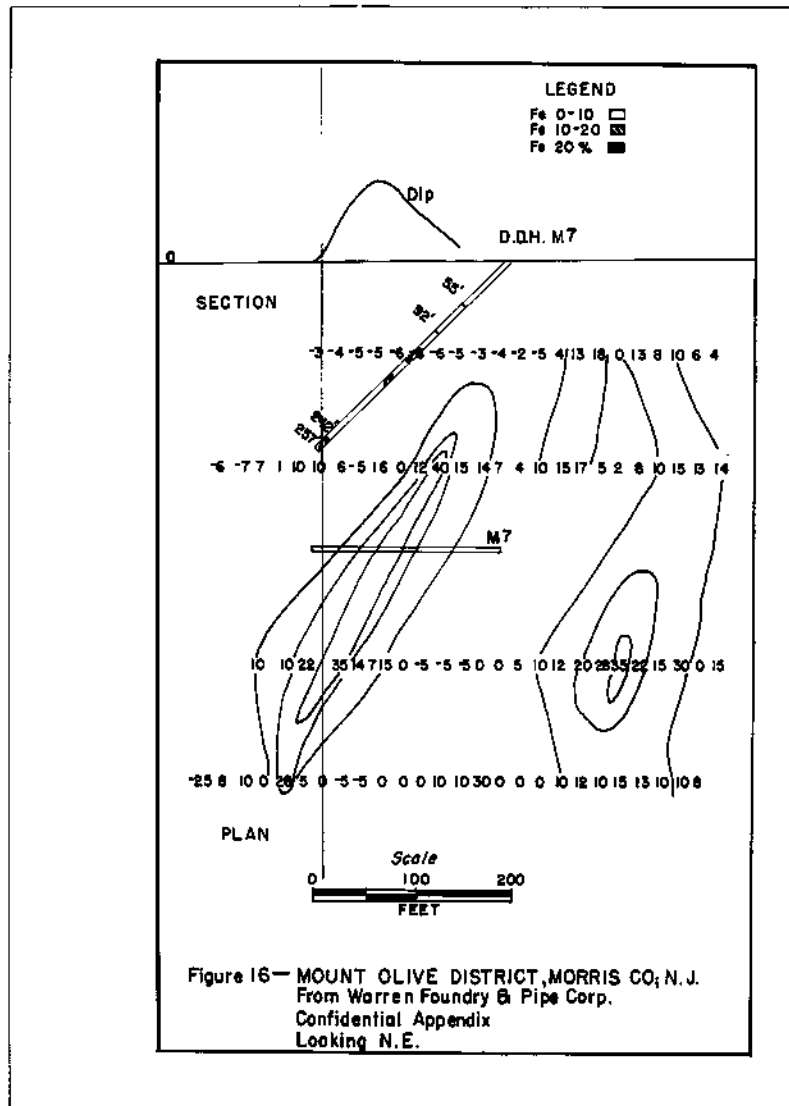

A 1860

30002

291

14.5:1

300720

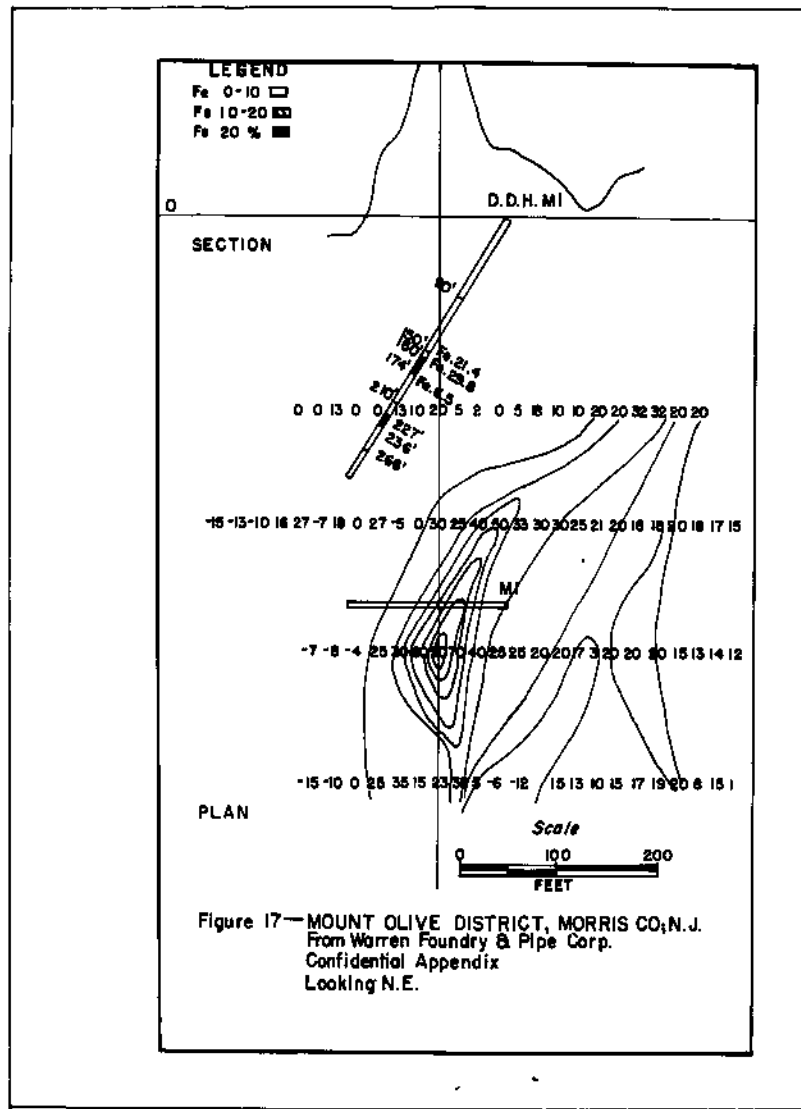

Fr 1861

30002

292

14.5:1

300721

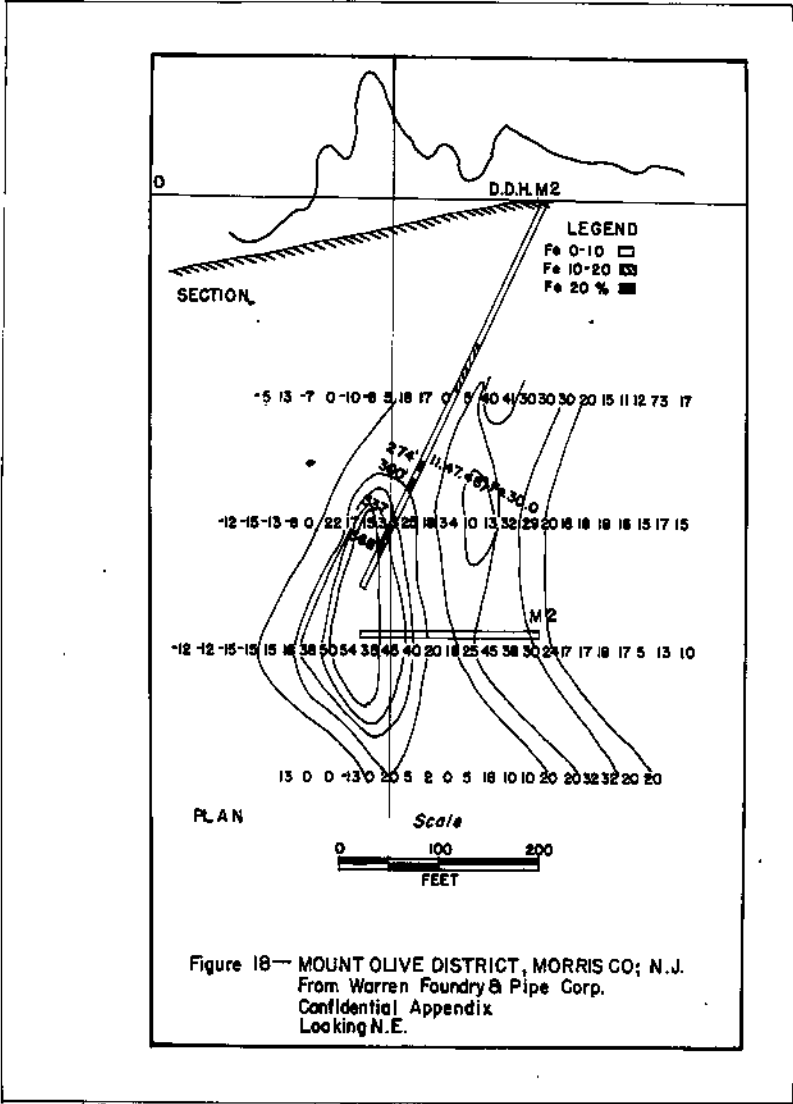

A1862

30002

293

14.5.1

300722

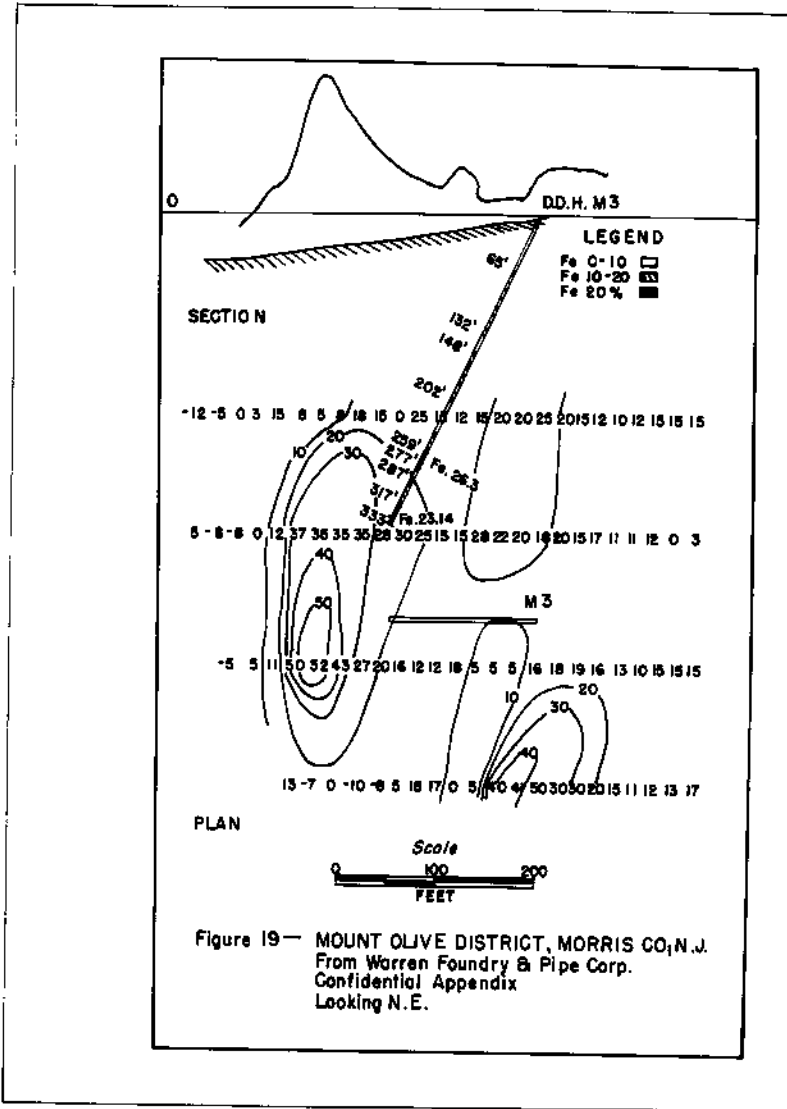
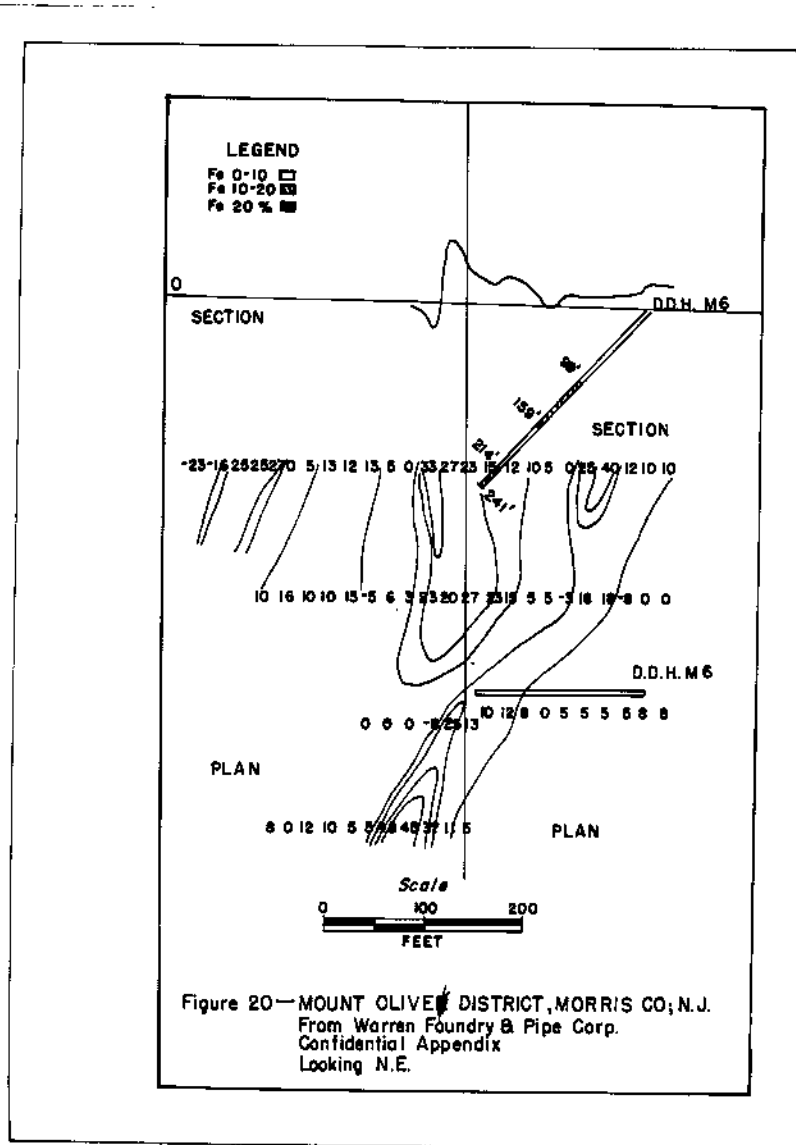

Figure 19— MOUNT OLIVE DISTRICT, MORRIS CO., N.J.
 From Warren Foundry & Pipe Corp.
 Confidential Appendix
 Looking N.E.

9/863

300021294 | 14.5:1 | 300723



A1864

300020295

14.5.1

300724

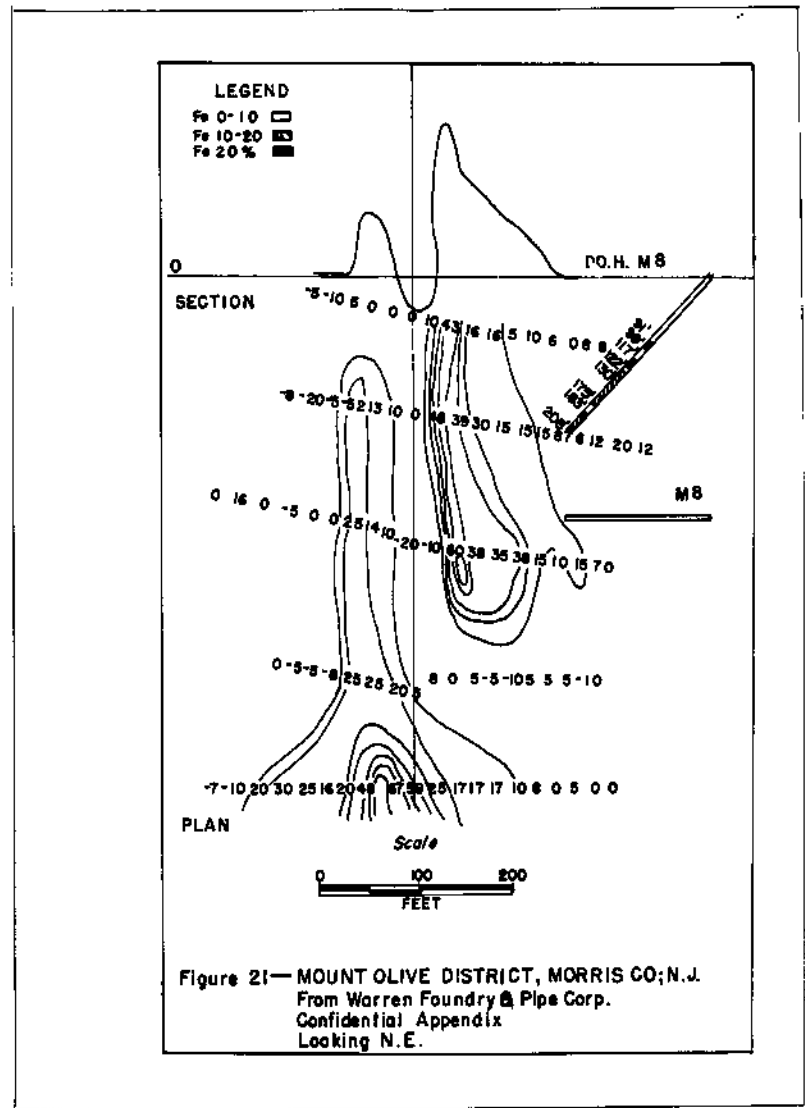

71865

30002 296

14.5.1

300725

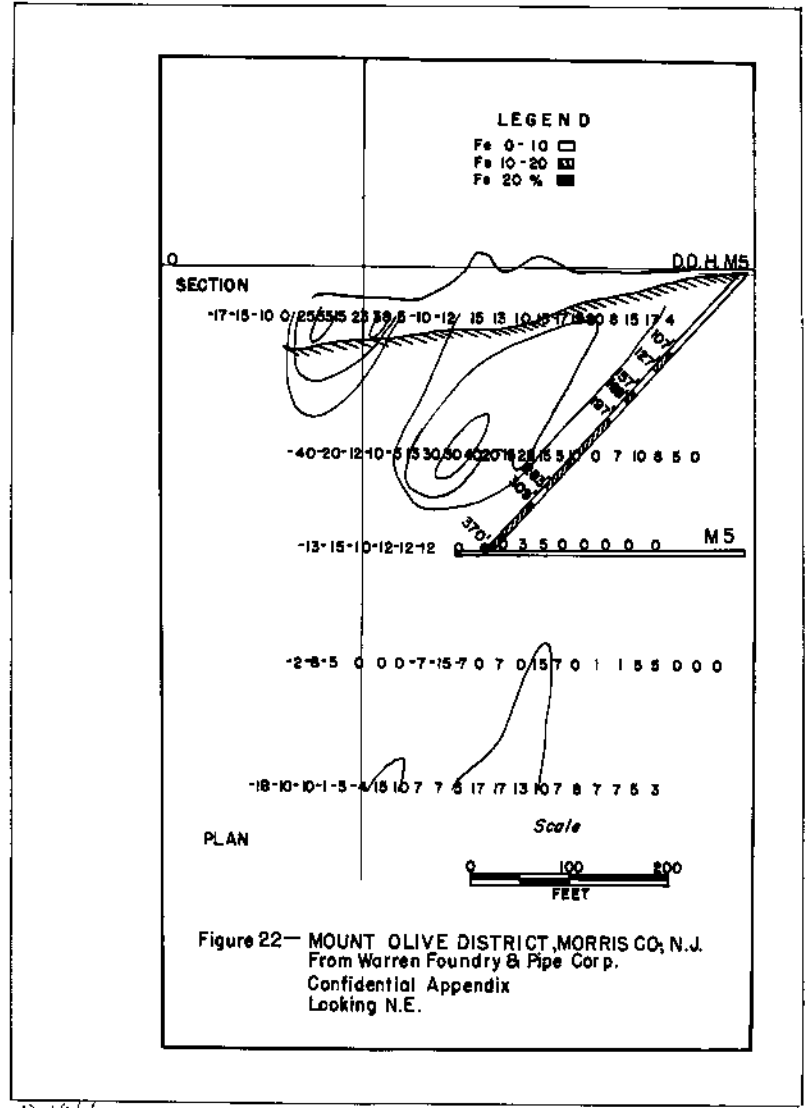

771866

30002

297

14.5:1

300726

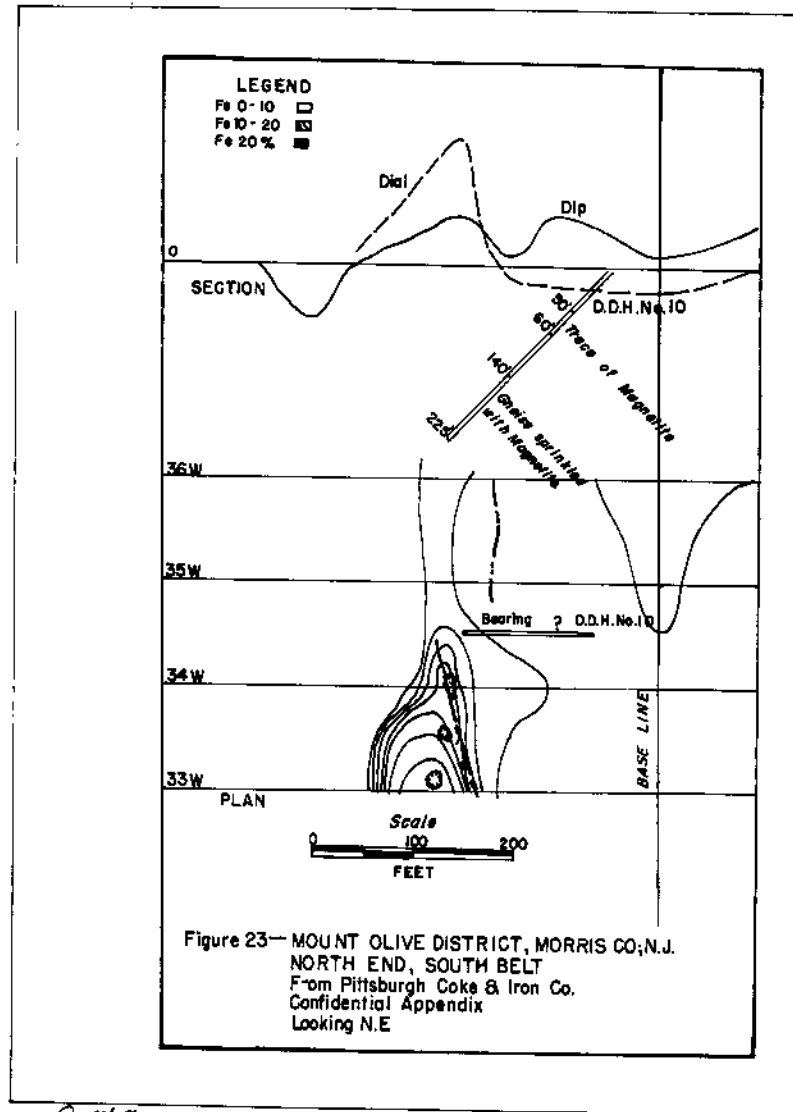

A1867

300020298

14.5.1

300727

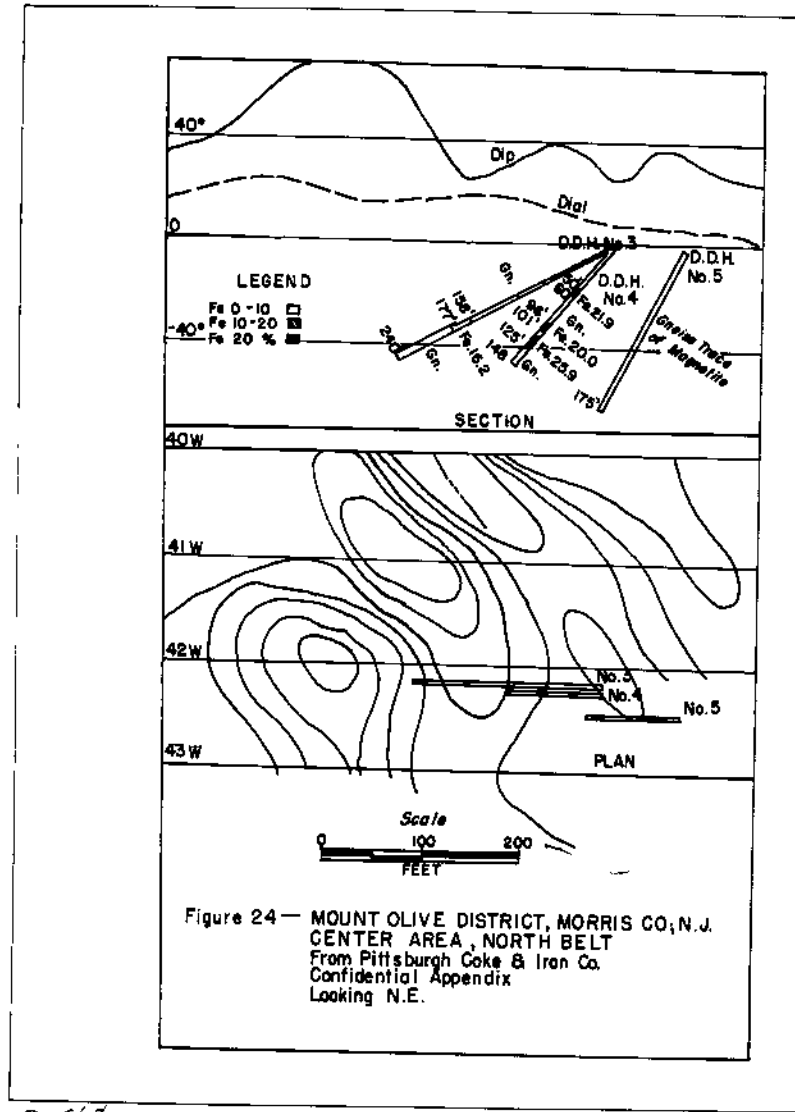

A1868

30002 299

14.5.1 300728

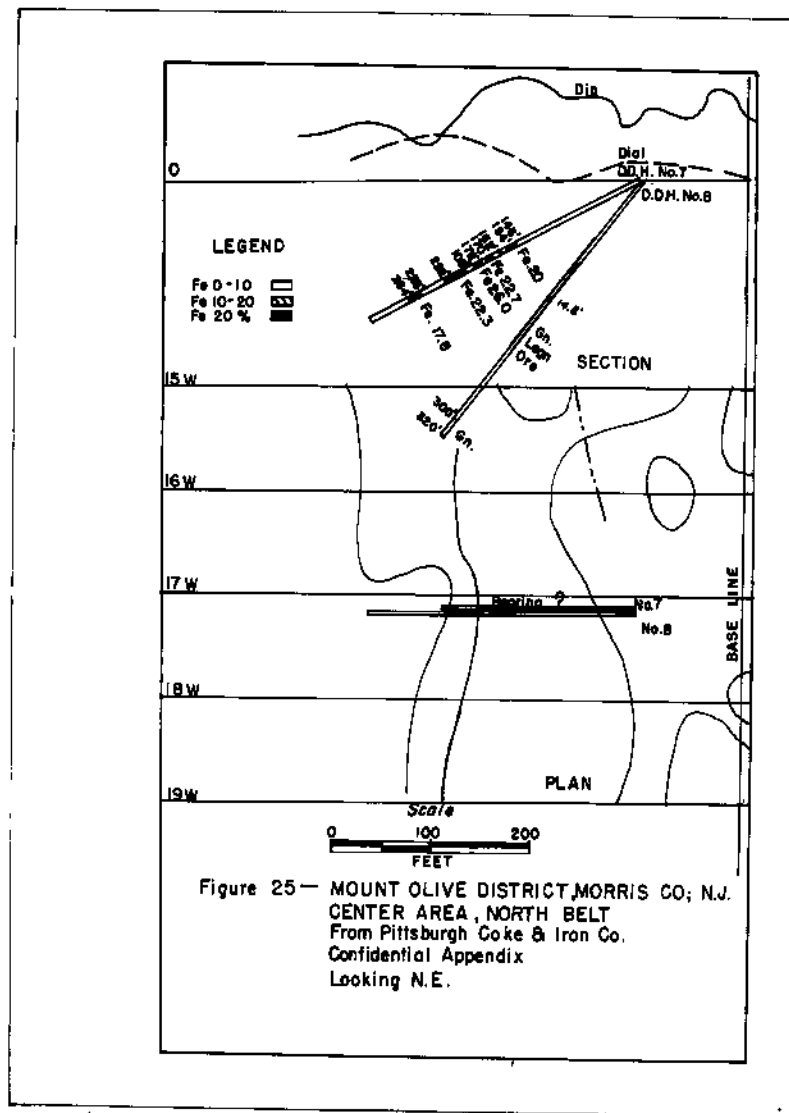

A1869

300021300 | 14.5:1 | 300729

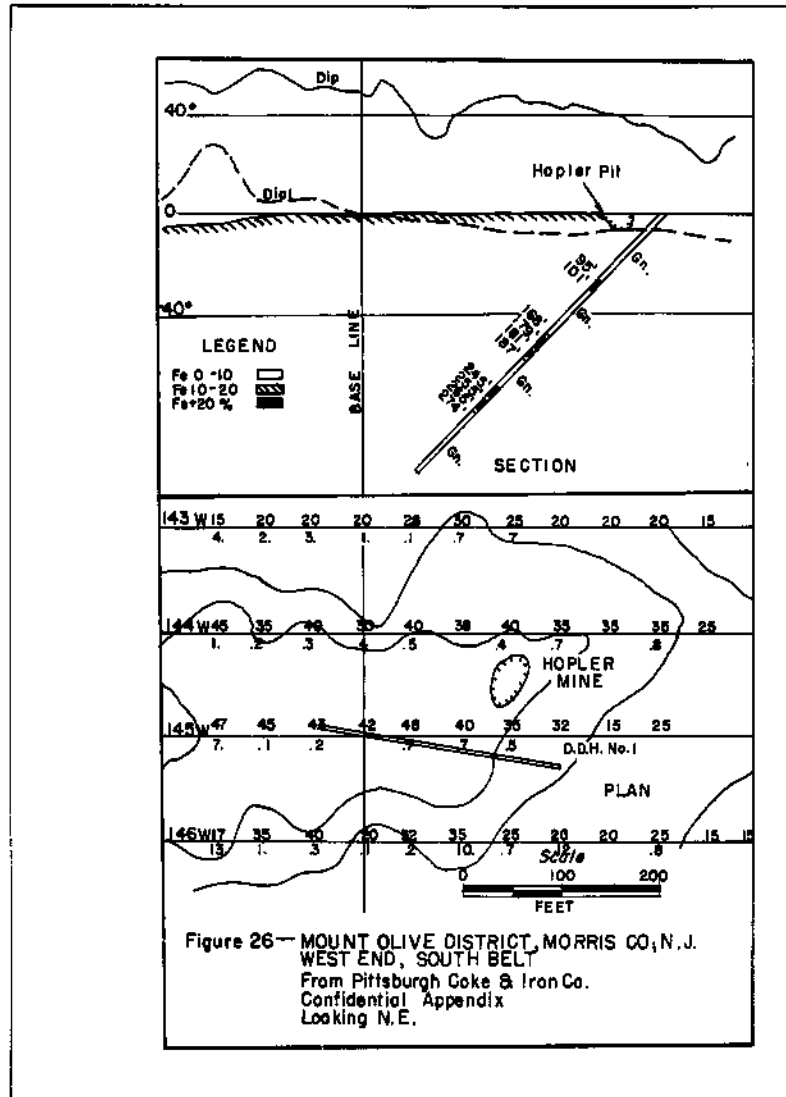

111878

30002

301

14.5.1

300730

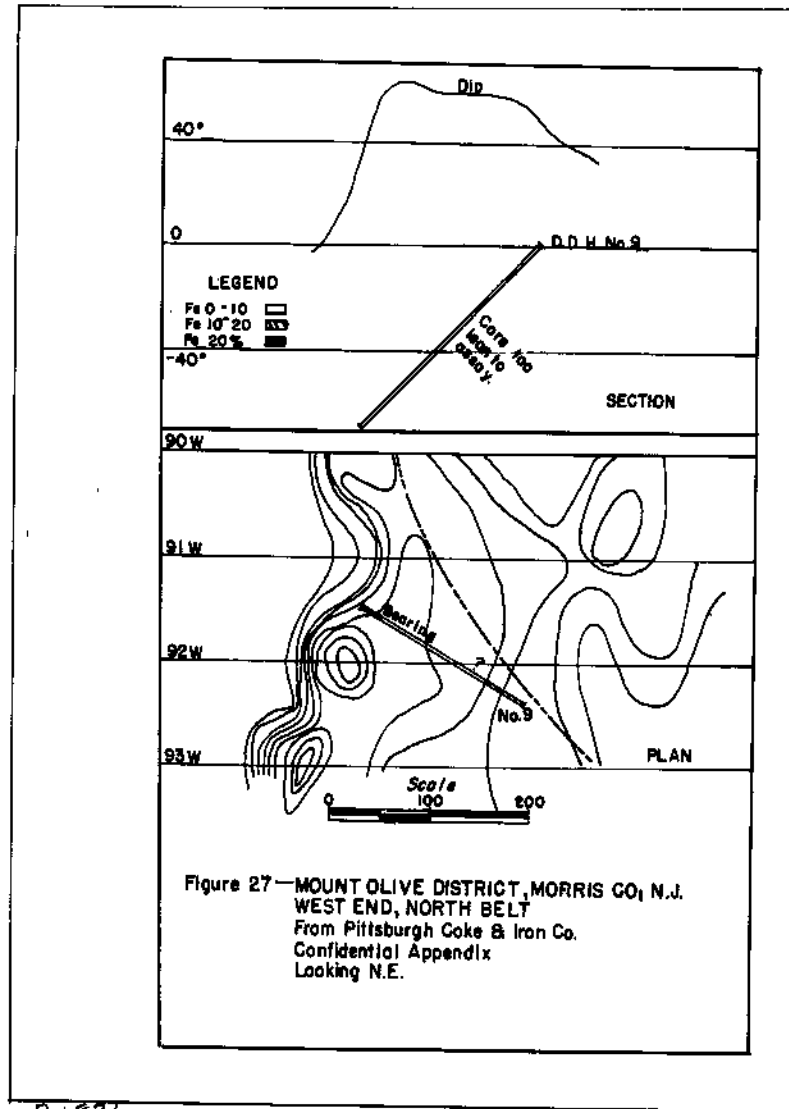

A1871

300021302 | 14.5.1 | 300731

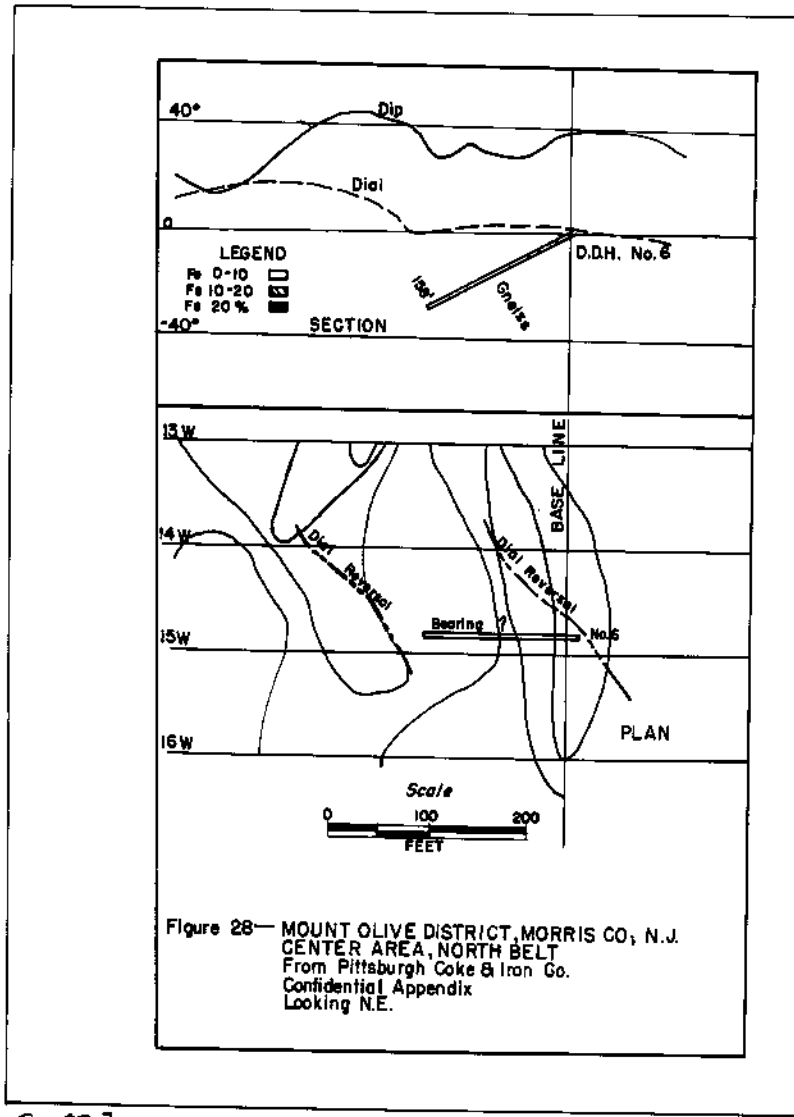
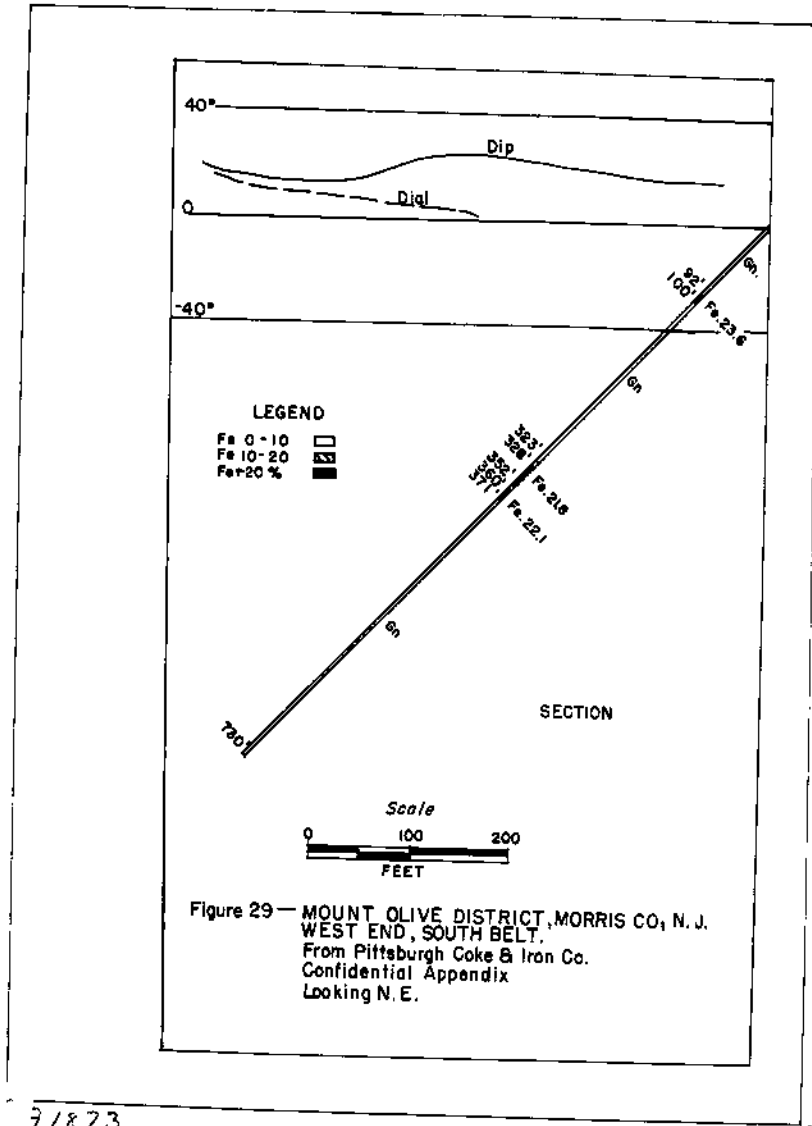

Figure 28— MOUNT OLIVE DISTRICT, MORRIS CO., N.J.
 CENTER AREA, NORTH BELT
 From Pittsburgh Coke & Iron Co.
 Confidential Appendix
 Looking N.E.

191872

30002 | 303 | 14.5:1 | 300732



71873

30002

304

14.5.1

300733

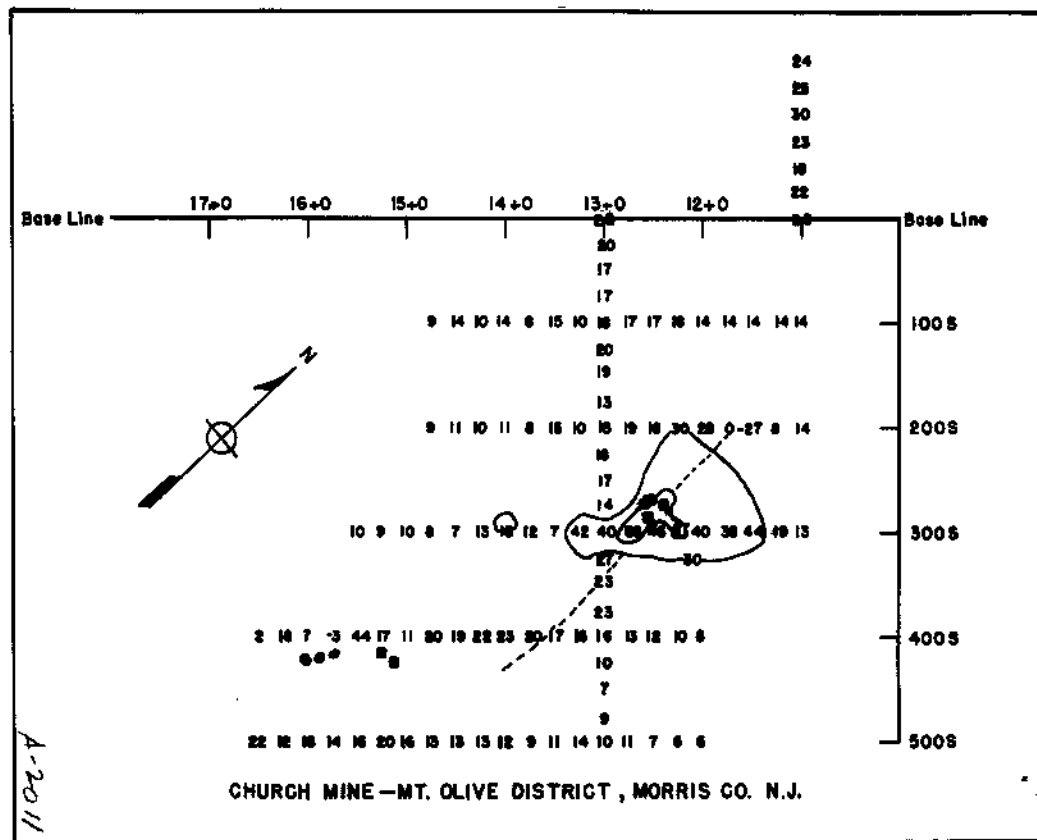

300020307

14.5.1 300736

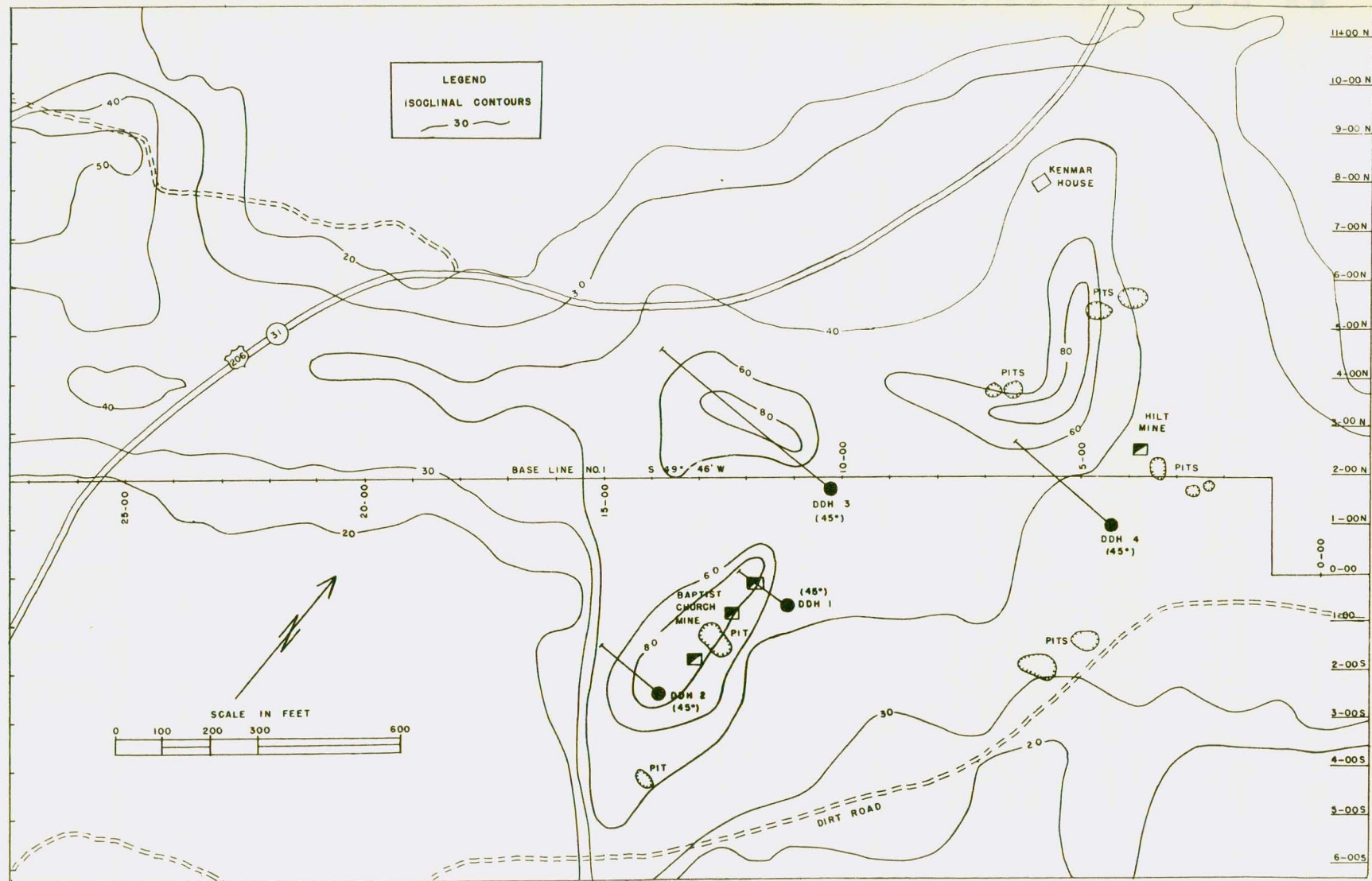

Figure 6. - Mount Olive area.

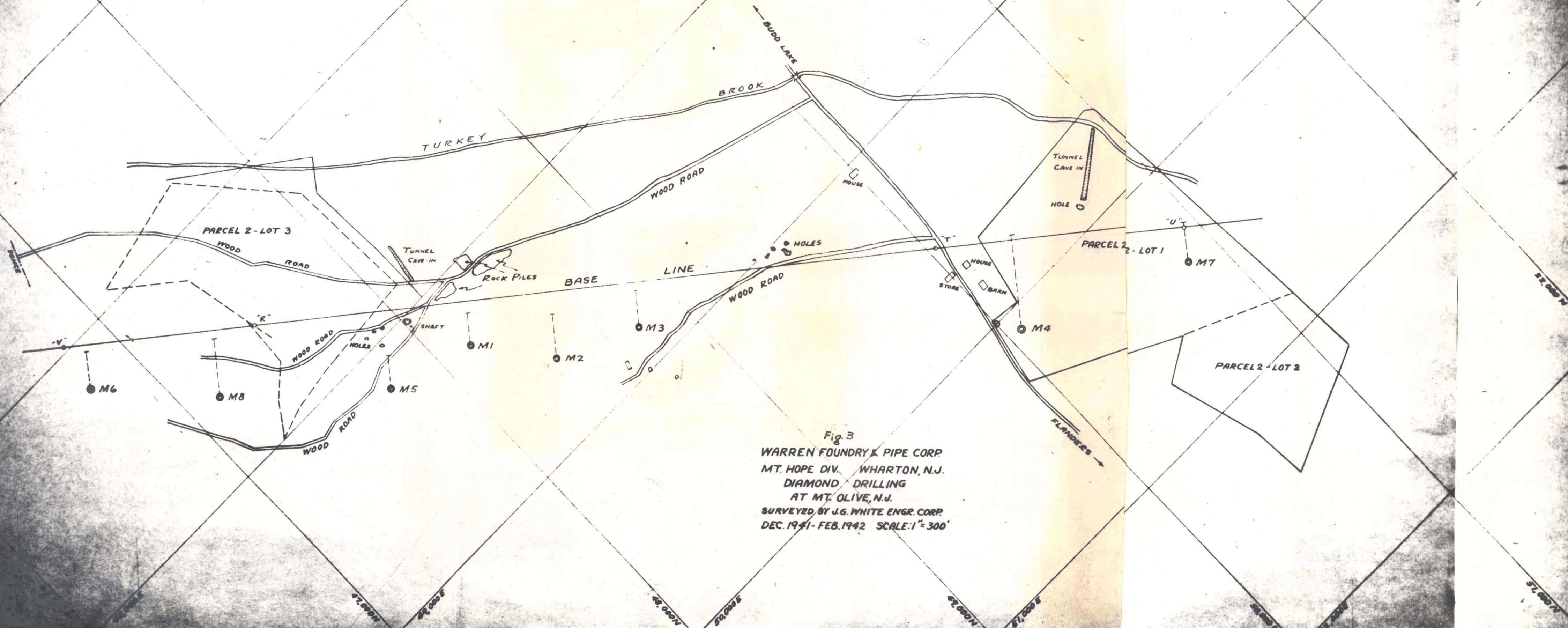

Fig. 3
 WARREN FOUNDRY & PIPE CORP.
 MT. HOPE DIV. WHARTON, N.J.
 DIAMOND DRILLING
 AT MT. OLIVE, N.J.
 SURVEYED BY J.G. WHITE ENGR. CORP.
 DEC. 1941 - FEB. 1942 SCALE: 1" = 300'

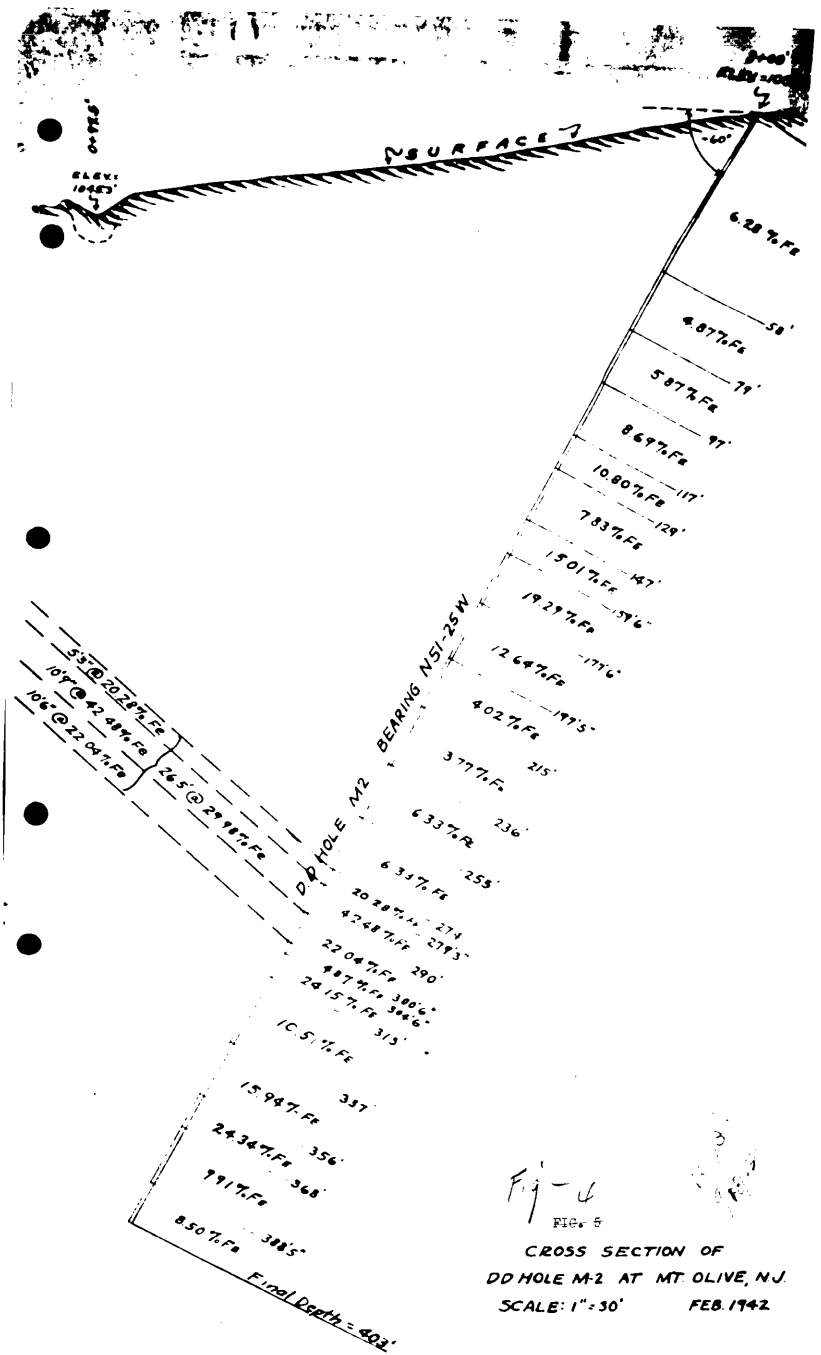
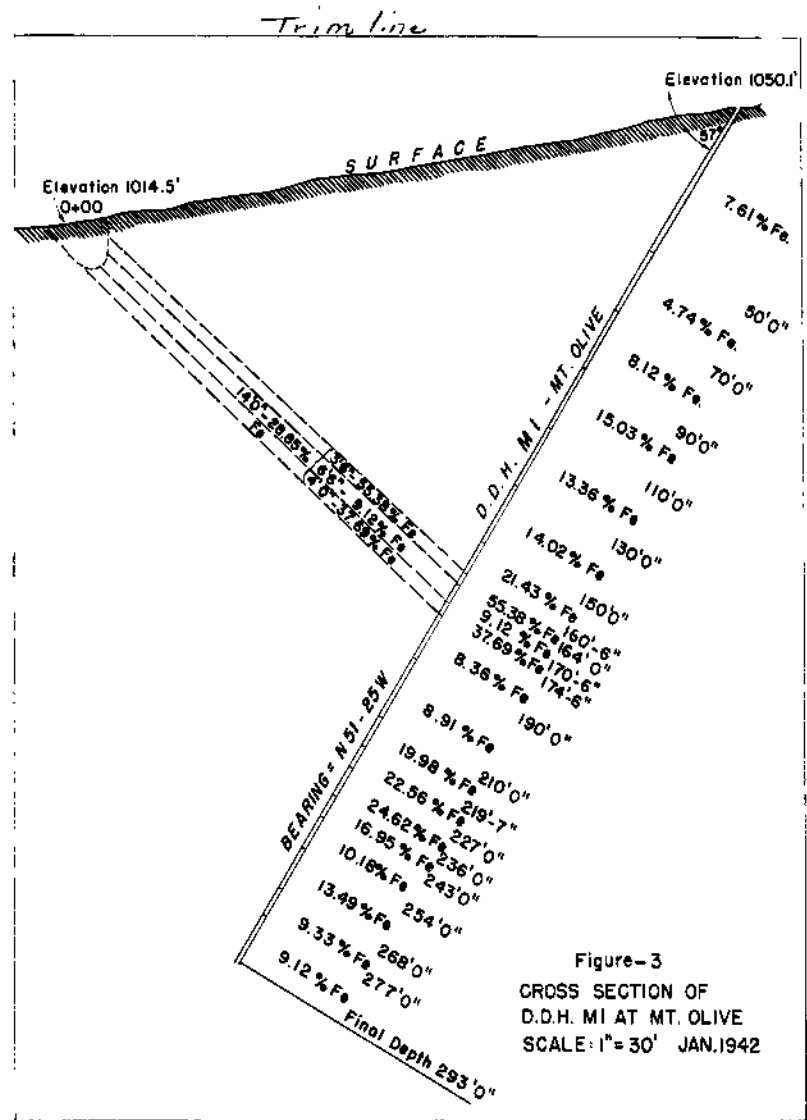

Fig-4
 FIG. 4
 CROSS SECTION OF
 DD HOLE M-2 AT MT. OLIVE, N.J.
 SCALE: 1"=30' FEB. 1942

30002 309 | 14.5:1 300738



30002 310

14.5:1

300739

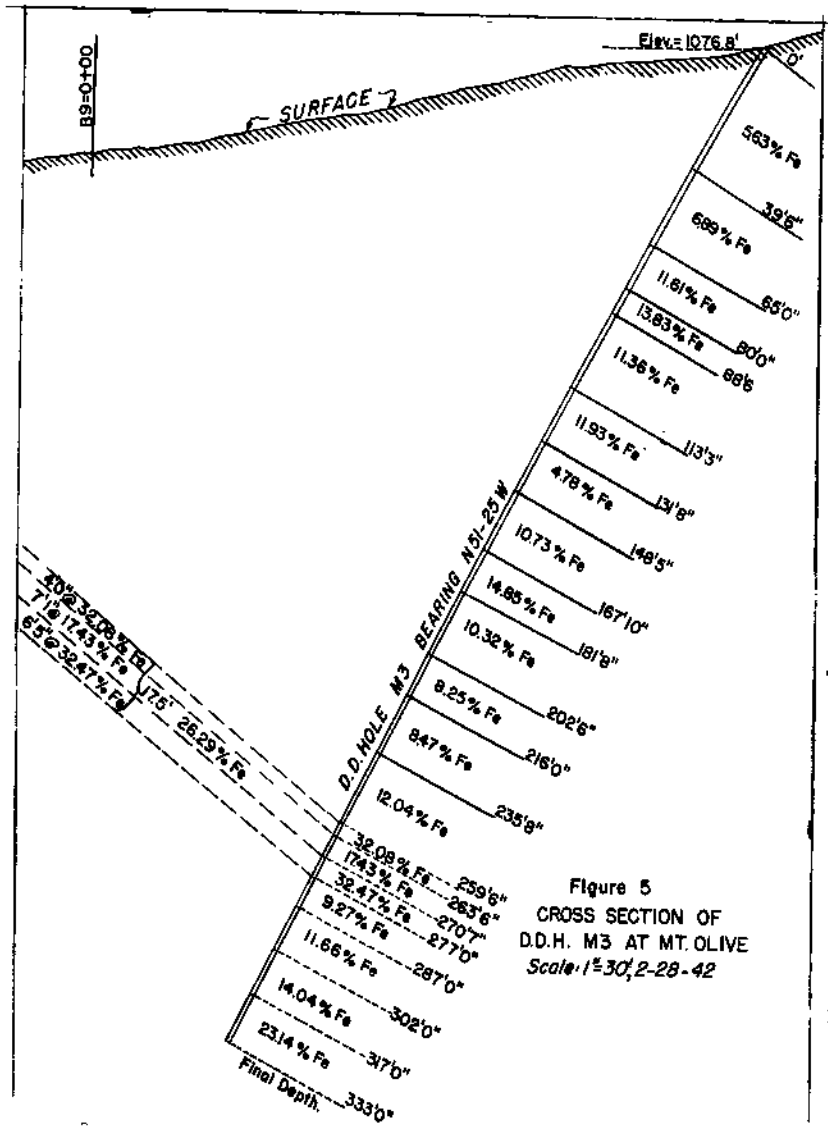

Figure 5
 CROSS SECTION OF
 D.D.H. M3 AT MT. OLIVE
 Scale: 1"=30', 2-28-42

30002

311

14.5.1

300740

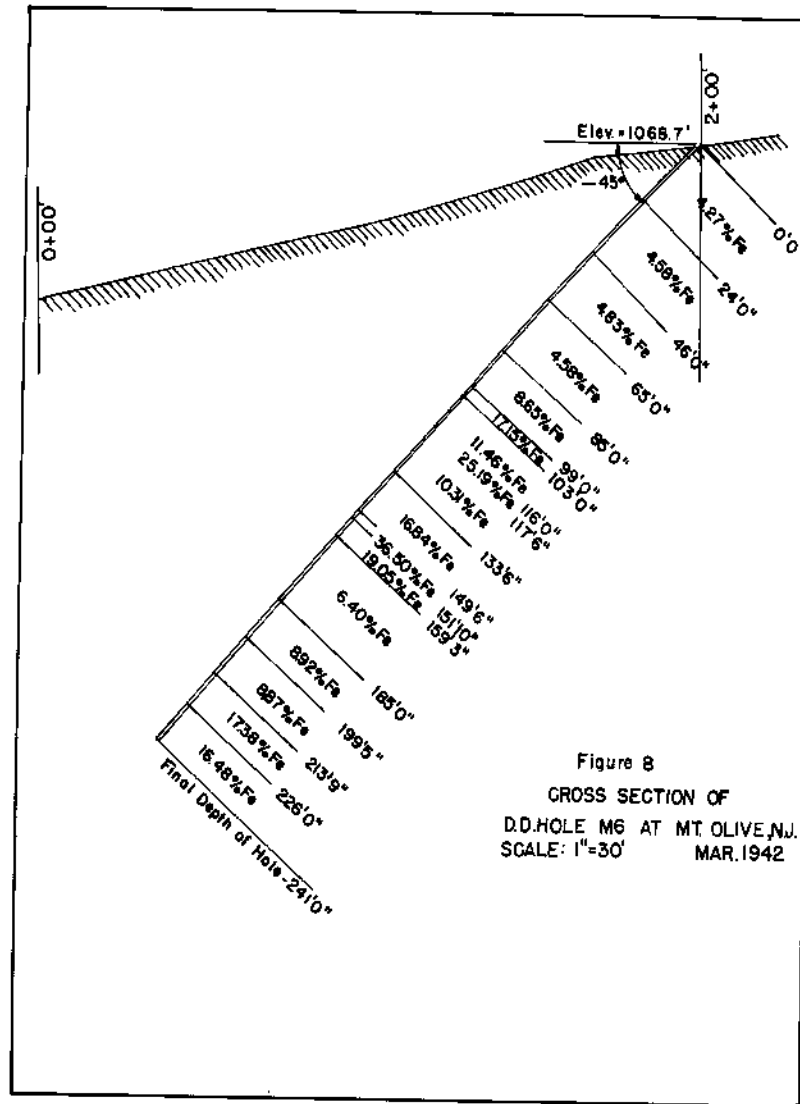

30002

312

14.5.1

300741

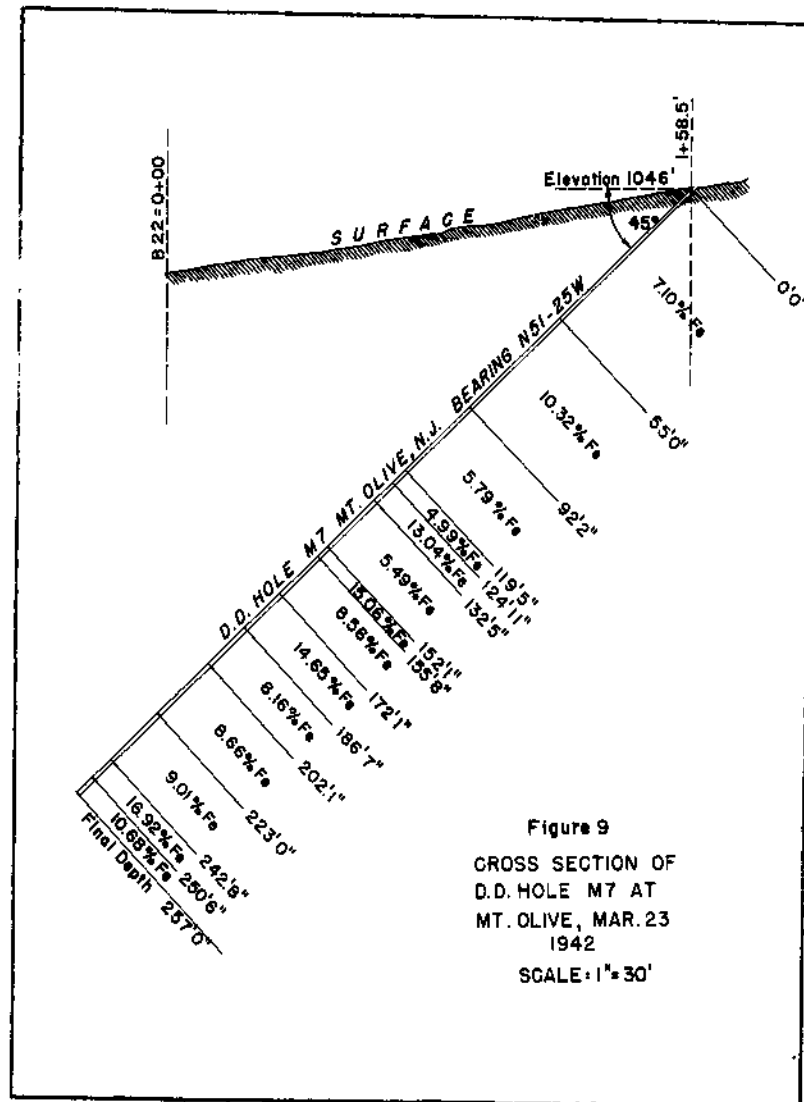

Figure 9
 CROSS SECTION OF
 D.D. HOLE M7 AT
 MT. OLIVE, MAR. 23
 1942
 SCALE: 1" = 30'

30002

313

14.5:1

300742