



State of New Jersey
Department of Environmental Protection
Geological Survey



Information Disclaimer

The State of New Jersey makes great effort to provide secure, accurate and complete information. However, portions of the information contained here may be incorrect or not current.

The State of New Jersey, its officers, employees or agents shall not be liable for damages or losses of any kind arising out of or in connection with the use or performance of information, including but not limited to, damages or losses caused by reliance upon the accuracy or timeliness of any such information, or damages incurred from the viewing, distributing, or copying of those materials.

The materials and information provided here are provided "as is." No warranty of any kind, implied, expressed, or statutory, including but not limited to the warranties of non-infringement of third party rights, title, merchantability, fitness for a particular purpose, and freedom from computer virus, is given with respect to the contents of this document.

LANNING PROP.
Oxford, N.V.

Survey of Lanning Property

October 1898

Scale 1/2500 feet to inch

28.8 for 1898 and 1899

John H. Rogers

1898

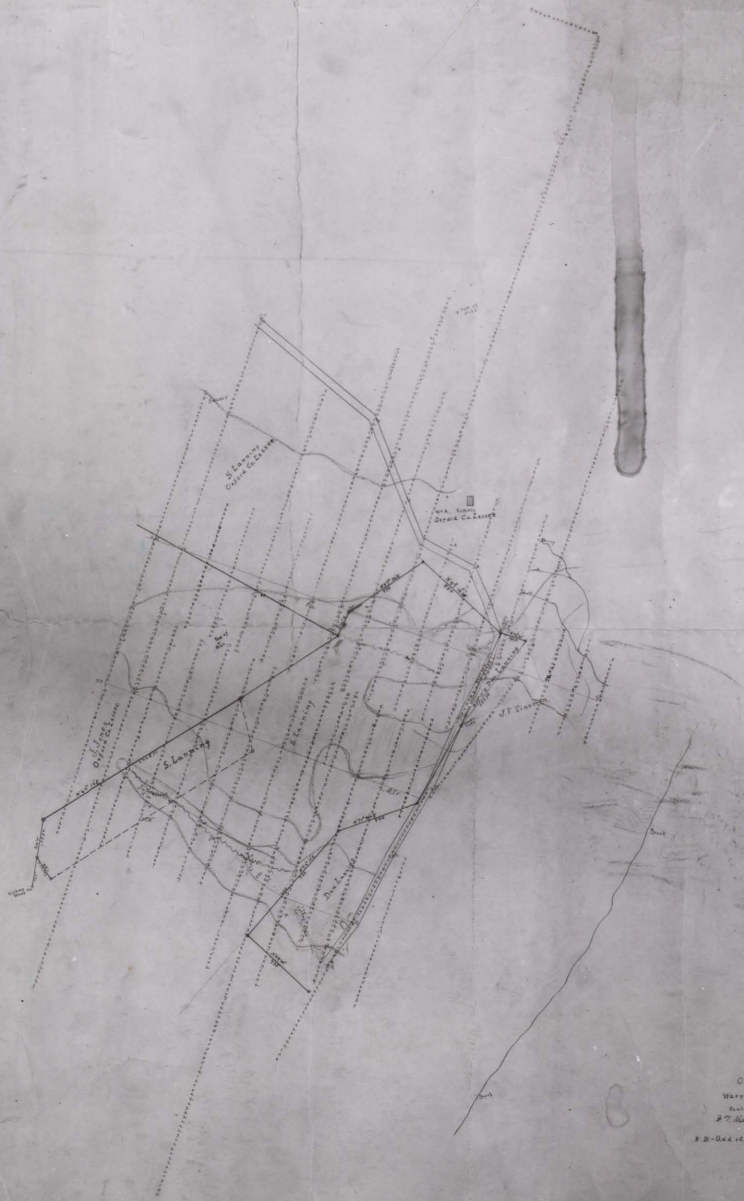
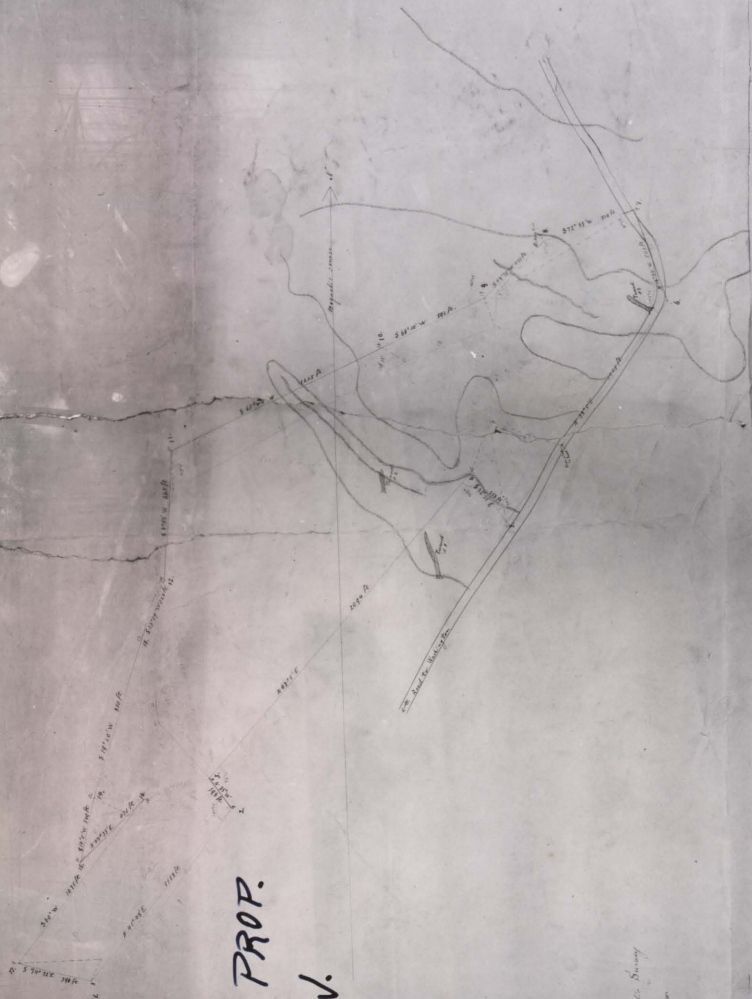

Oxford Town
Warren County, N.V.
Scale 1/2500 feet to inch
J. H. Marshall Aug. 1898
No. 1-2 of 12 all reflections

E219-2

7130

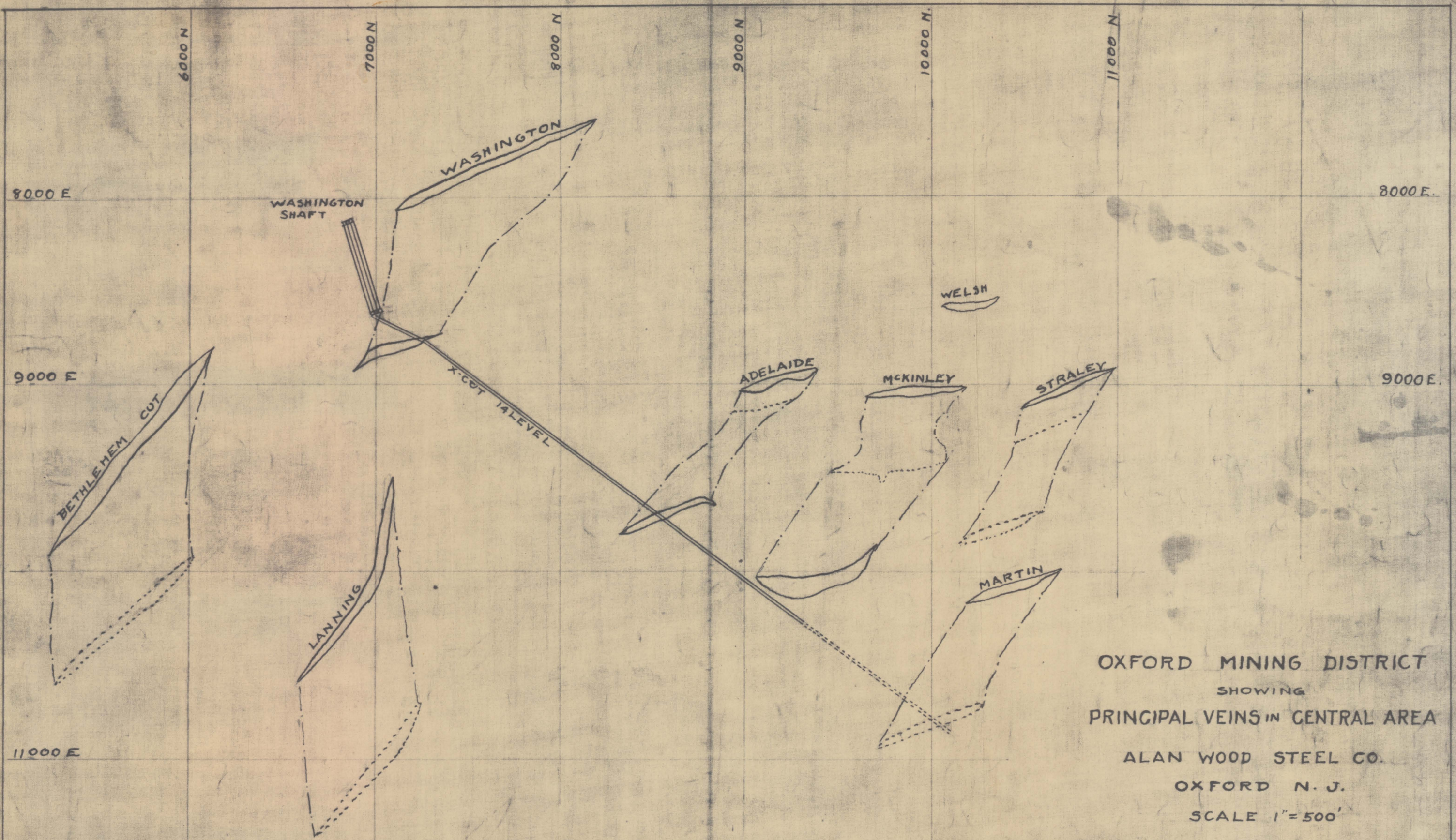

OXFORD MINING DISTRICT
 SHOWING
 PRINCIPAL VEINS IN CENTRAL AREA

ALAN WOOD STEEL CO.
 OXFORD N. J.
 SCALE 1" = 500'

LEGEND

- SURFACE WORKINGS
- HORIZON OF 14th LEVEL

*Praver #4
 4300*

*4008
 3-10-43*



- Fee (Surface and Mineral)
- Mineral only
- Surface only

MAP 3
REPLOGLÉ STEEL CO.
 AND
EMPIRE STEEL AND IRON CO.
IRON ORE LANDS
WASHINGTON AND OTHER MINES
WARREN COUNTY NEW JERSEY

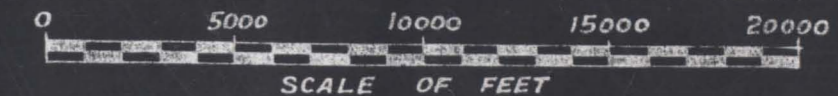

SCALE OF FEET
 REPORT OF W. SPENCER HUTCHINSON
 MINING ENGINEER
 BOSTON, MASS.
 JANUARY 30, 1923.

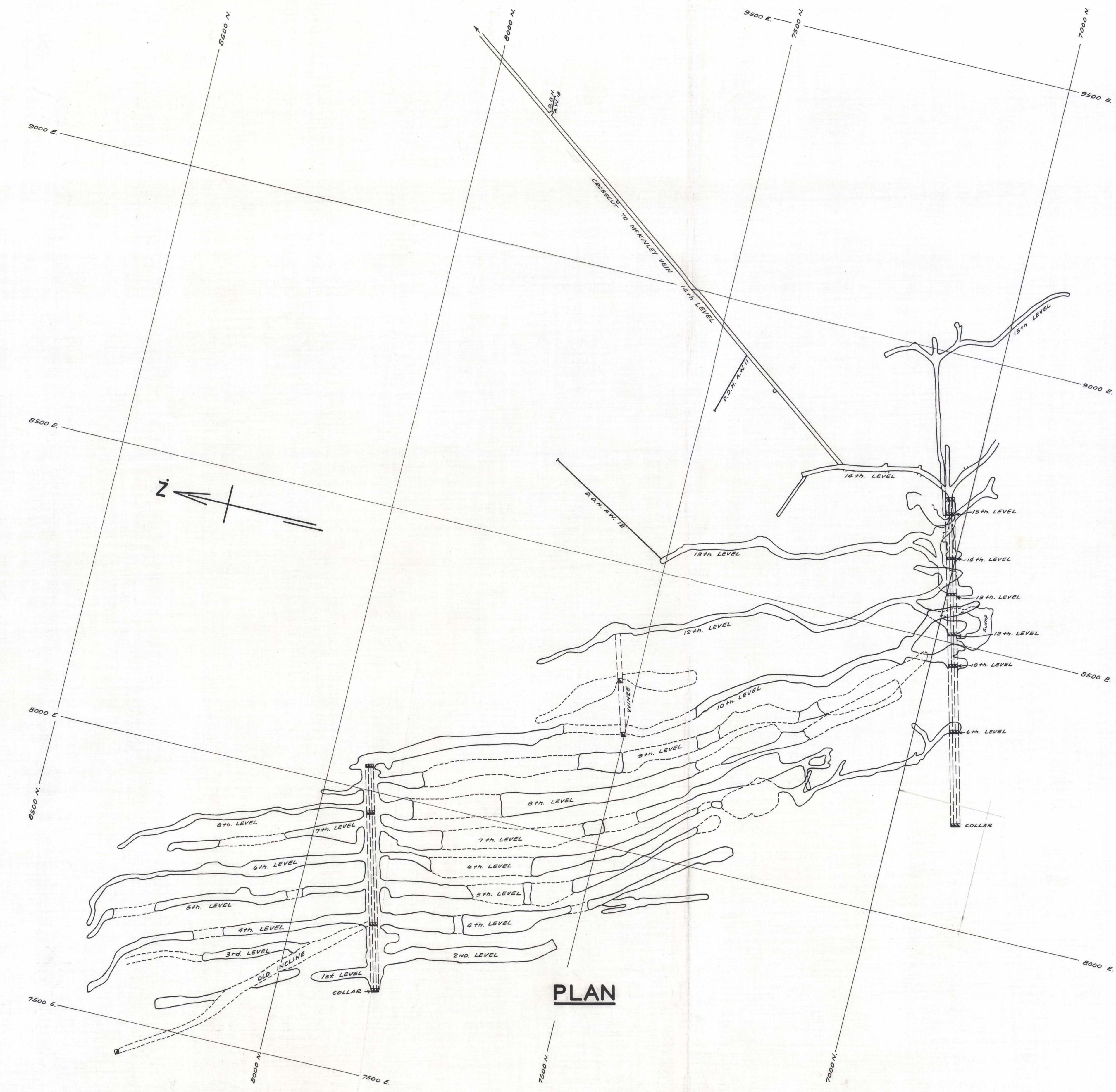

N.W.

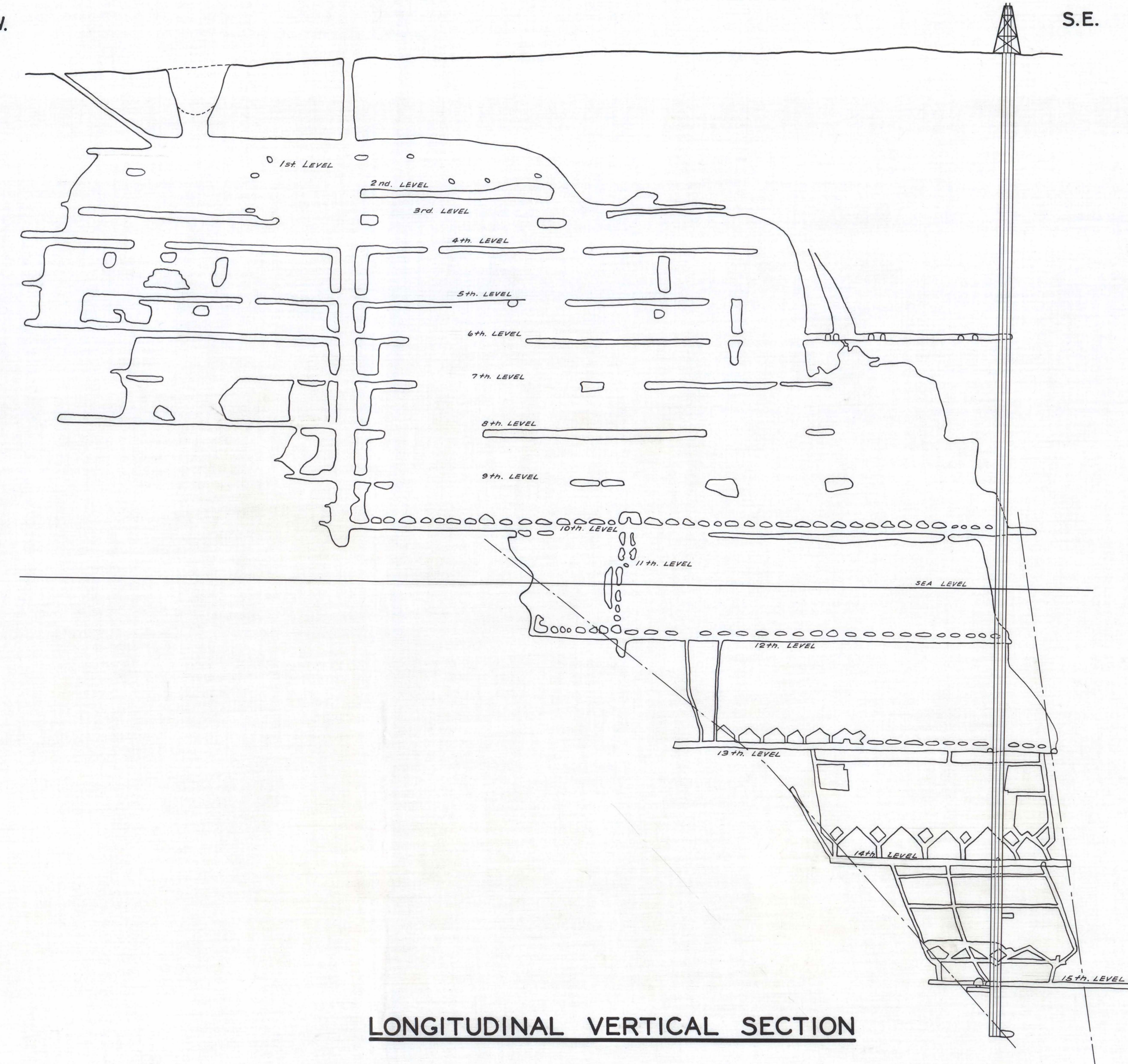

S.E.

S.W.

N.E.

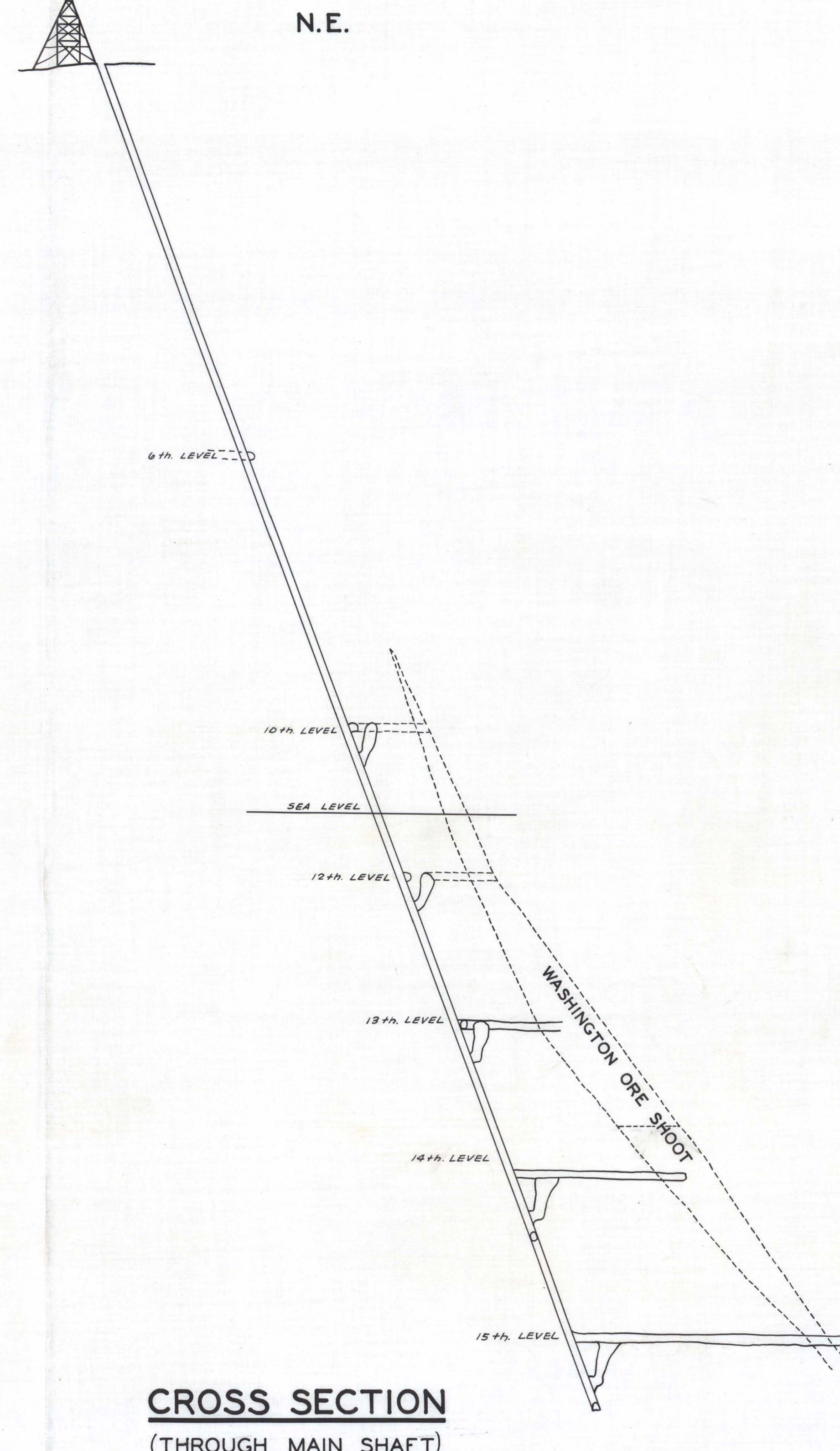

WASHINGTON MINE
ALAN WOOD MINING COMPANY
PLAN AND SECTIONS
SHOWING WORKINGS IN THE
WASHINGTON ORE SHOOT

LEGEND

ROCK
ORE
ORE MINED OUT

SCALE: 1" = 100' NOV. 1935

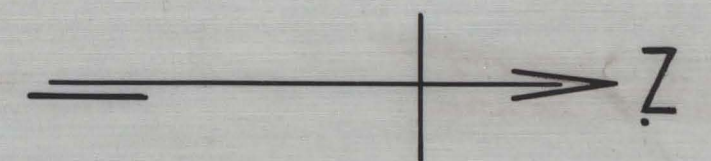

ALAN-WOOD MINING COMPANY

ALAN-WOOD MINING COMPANY

WASHINGTON MINE VEIN

ADELAIDE MINE

MC KINLEY MINE

MARTIN VEIN

OXFORD GROUP OF MINES
ALAN WOOD MINING CO.
SURFACE MAP SHOWING
LOCATIONS OF VEINS AT
OXFORD GROUP OF MINES

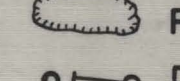
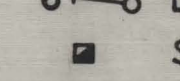
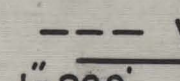
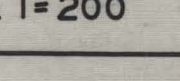
LEGEND
 PITS
 D.D. HOLES
 SHAFTS
 VEINS

SCALE: 1"=200' NOV. 1935



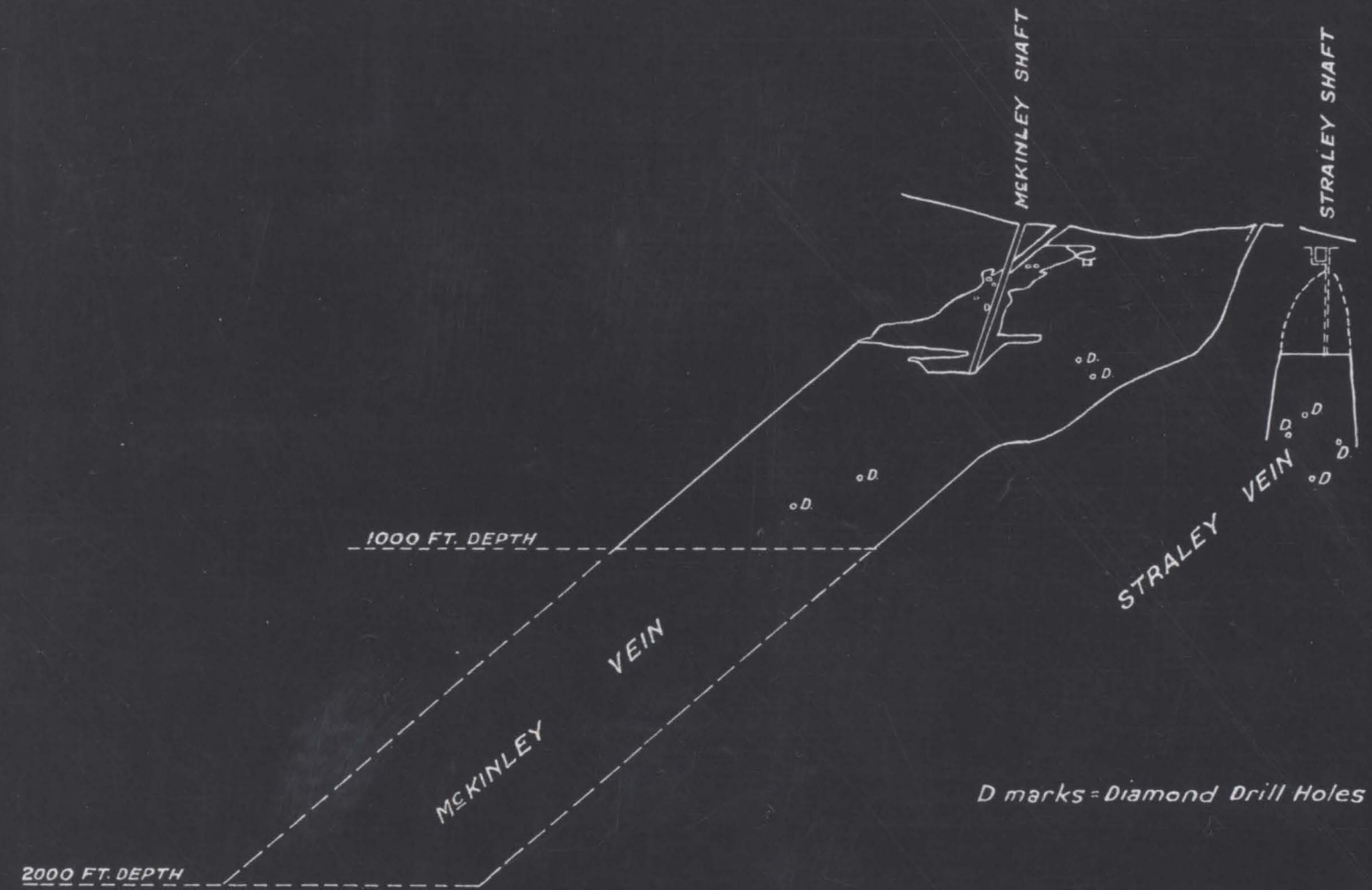

D marks = Diamond Drill Holes



**OXFORD MINE
LONGITUDINAL PROJECTION
MCKINLEY AND STRALEY VEINS**

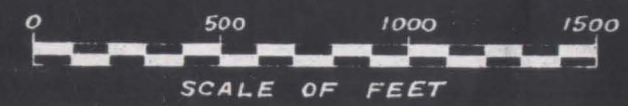

REPORT OF W. SPENCER HUTCHINSON
MINING ENGINEER

BOSTON, MASS.
JANUARY 30, 1923.

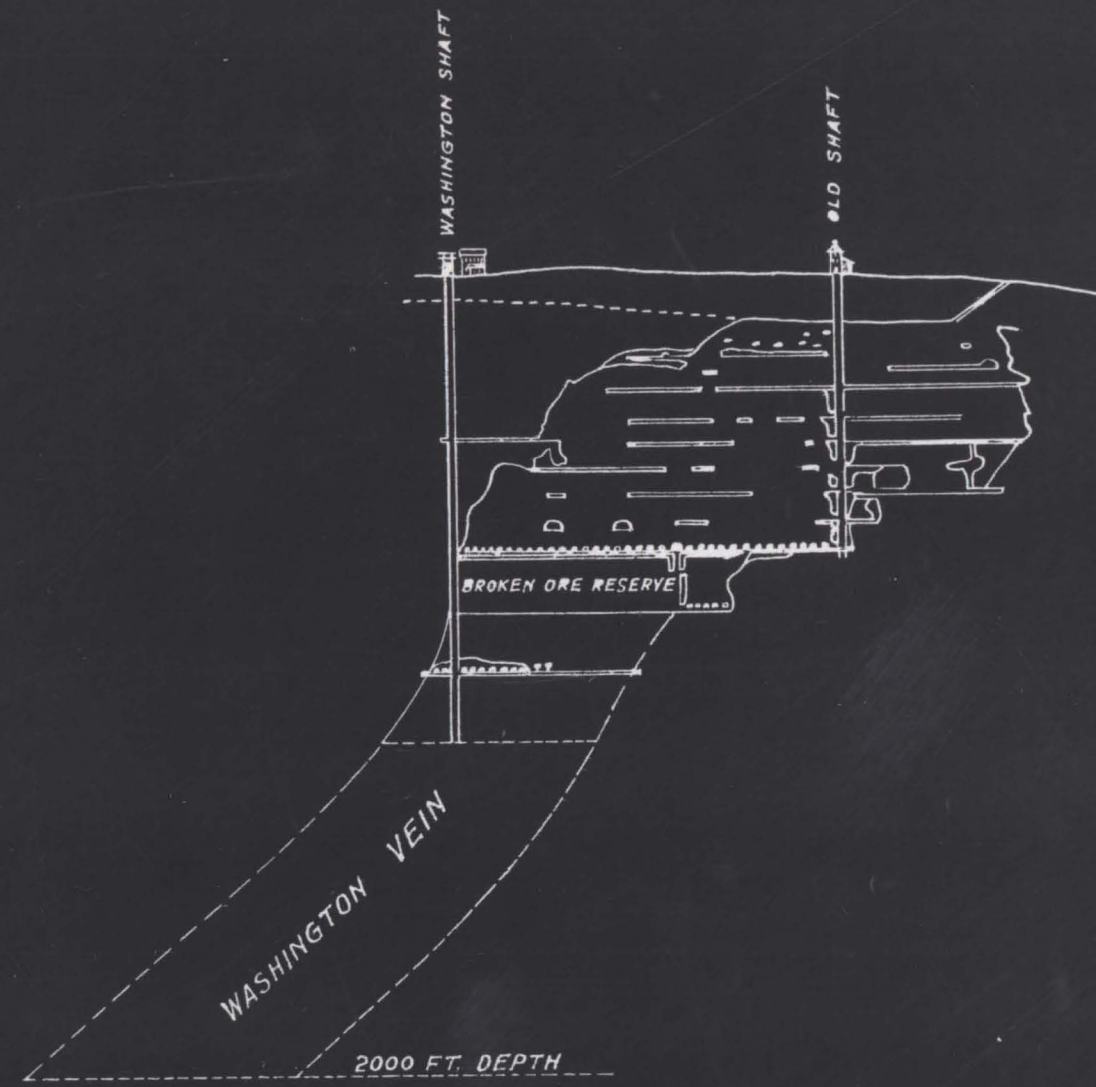

**OXFORD MINE
LONGITUDINAL PROJECTION
WASHINGTON VEIN**

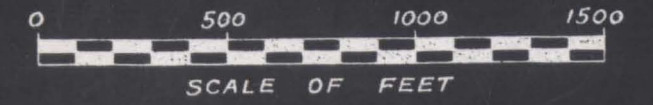

REPORT OF W. SPENCER HUTCHINSON
MINING ENGINEER

BOSTON, MASS.
JANUARY 30, 1923

MATERIAL LIST

ITEM	NO. REQ'D	SIZE OF WGT	MAT. ERIAL	DESCRIPTION

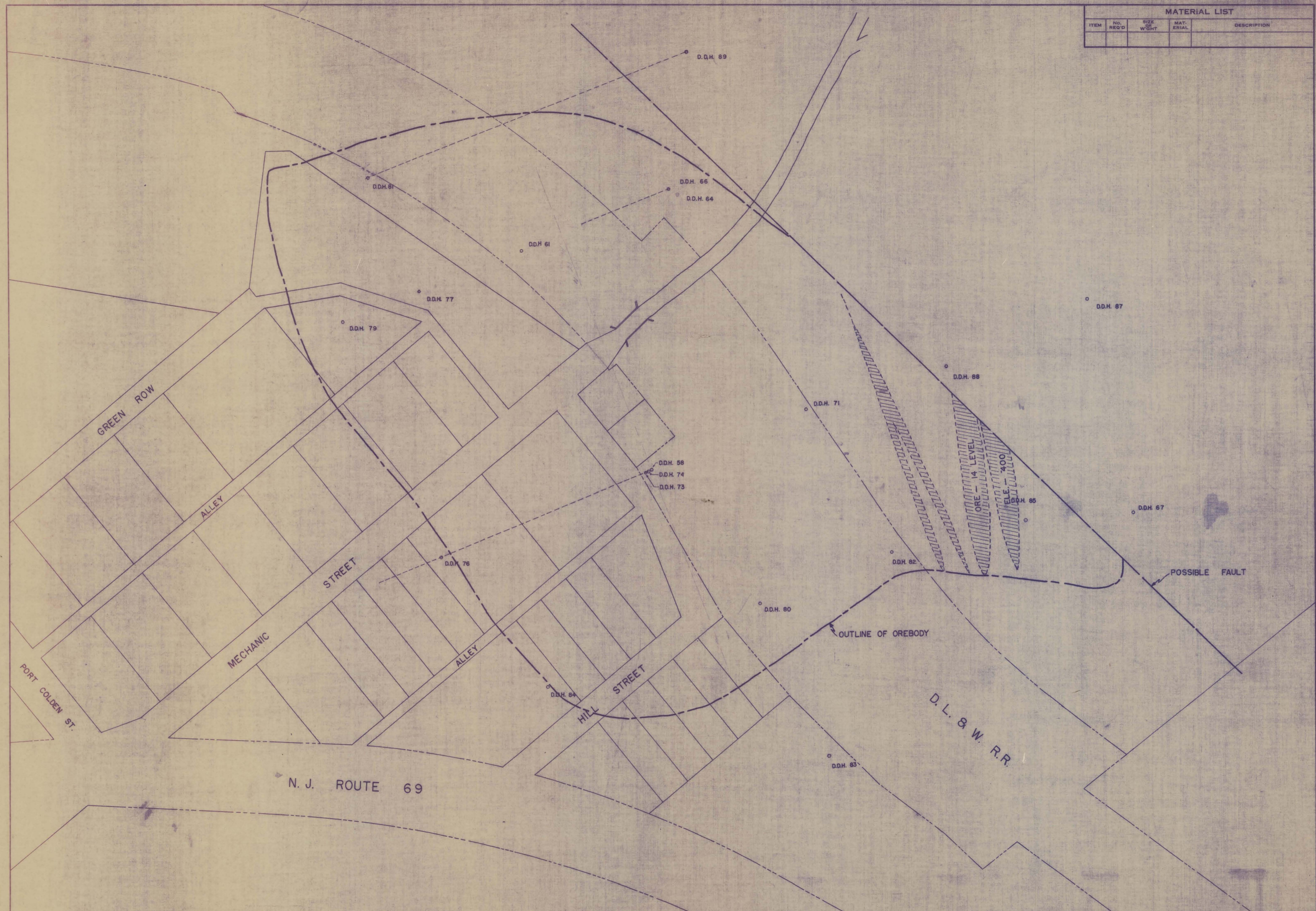

N. J. ROUTE 69

DERIVATIONS		REVISIONS		
A. W. S. CO. NUMBER	NO.	DATE	REMARKS	BY

ALAN WOOD STEEL COMPANY
CONSHOHOCKEN, PENNA.

DATE 11-2-56	ANOMALY 3 RELATION OF PROPERTY, DRILL HOLES AND ORE BODY	SCALE 1" = 50'
DWG. L. V. M.		NUMBER
TR'CD		
CHK'D		
APPROVED		

NOTE: THIS DRAWING IS LOANED AND REMAINS THE PROPERTY OF THE COMPANY AND CANNOT BE REPRODUCED OR USED IN WHOLE OR PART EXCEPT BY ITS PERMISSION.
CH. ENG.

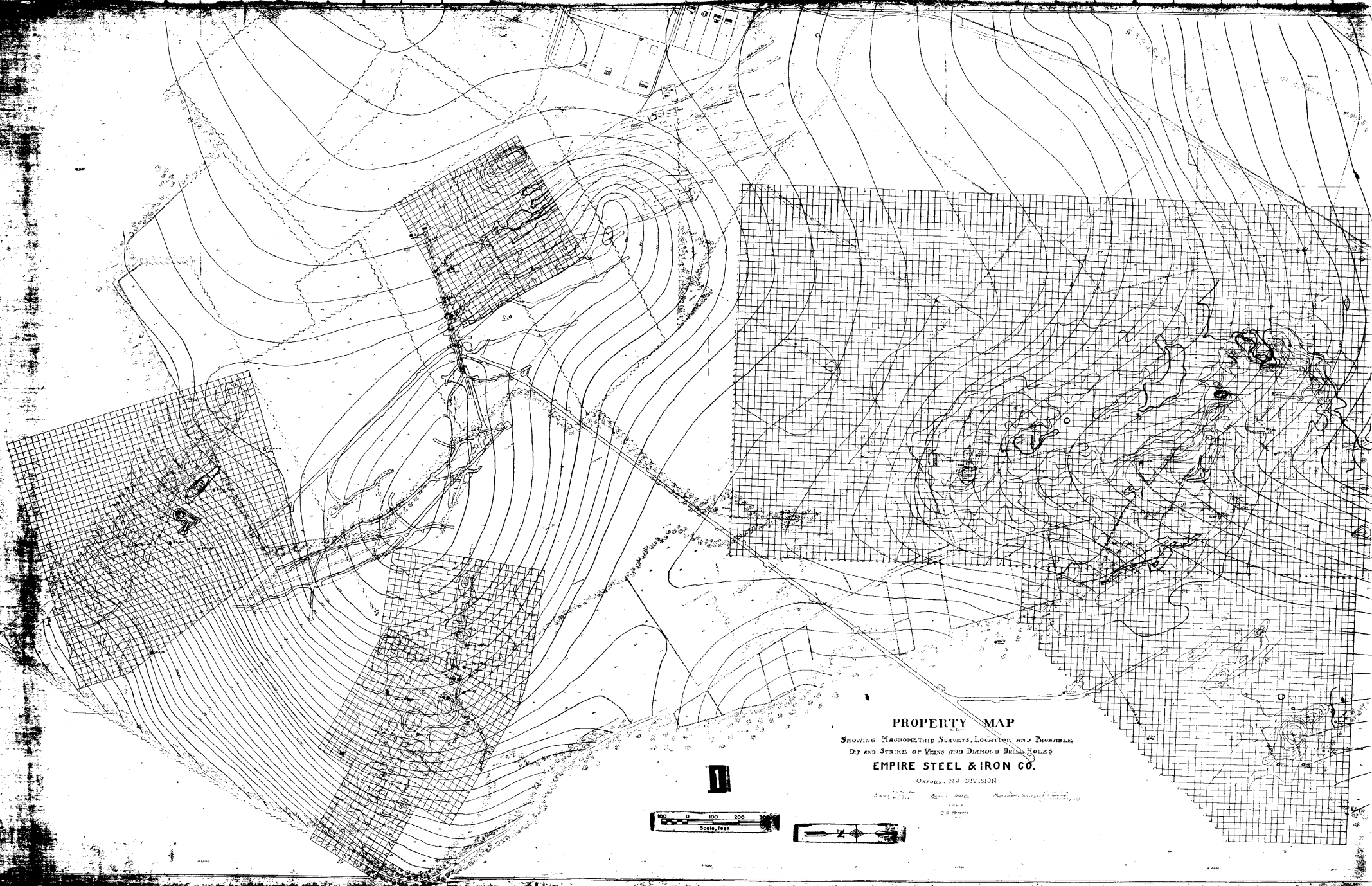

PROPERTY MAP
SHOWING MAGNETIC SURVEYS, LOCATION AND PROBABLE
DIP AND STRIKE OF VEINS AND DIAMOND DRILL HOLES
EMPIRE STEEL & IRON CO.
OXFORD, N.Y. DIVISION

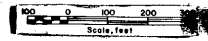

NJGS 03145 39 36X 354144

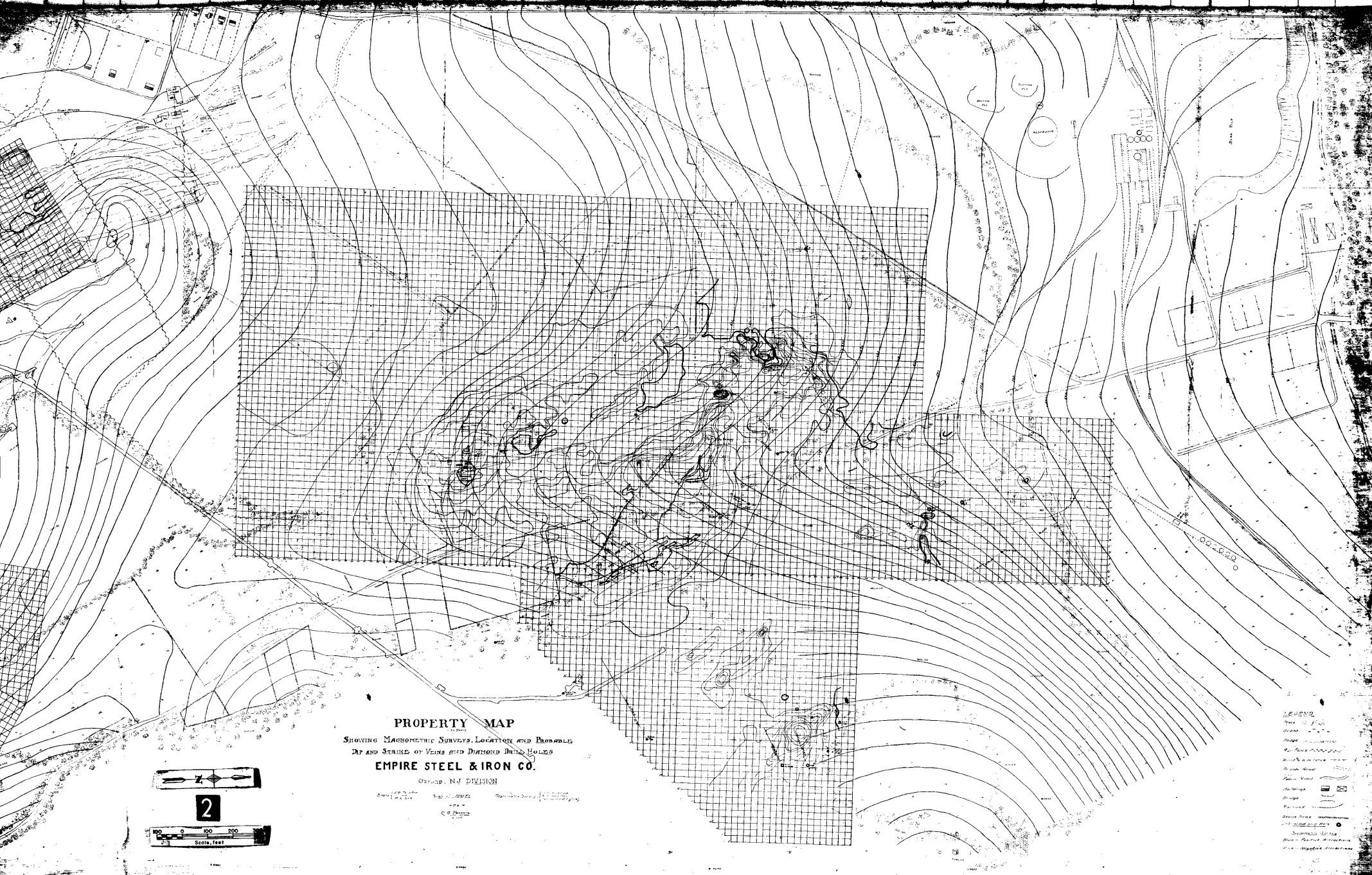

PROPERTY MAP
 SHOWING MAGNETIC SURVEYS, LOCATION AND PROBABLE
 DIP AND STRIKE OF VEINS AND DIAMOND DRILL HOLES
EMPIRE STEEL & IRON CO.
 Oradell, N.J. DIVISION

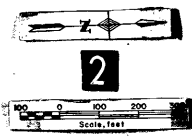

LEGEND
 Stone Walls
 Iron Pipes
 Survey Lines
 Magnetic Survey
 Dip - Percent
 Strike - Degrees

-PLAN-

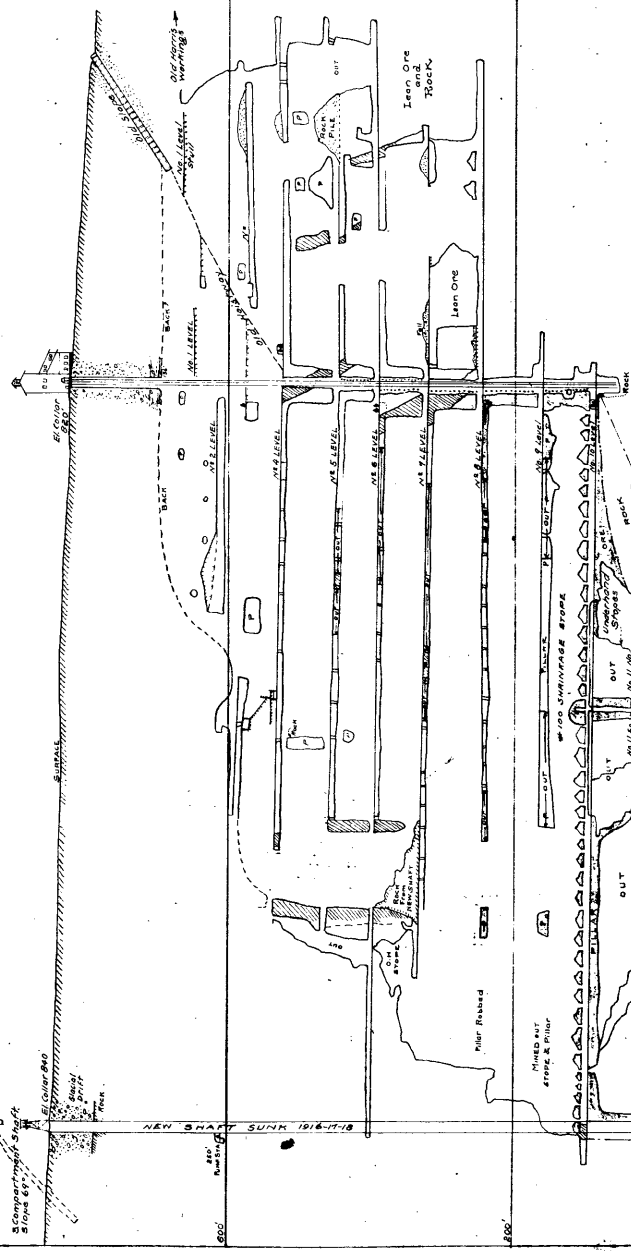
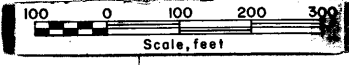
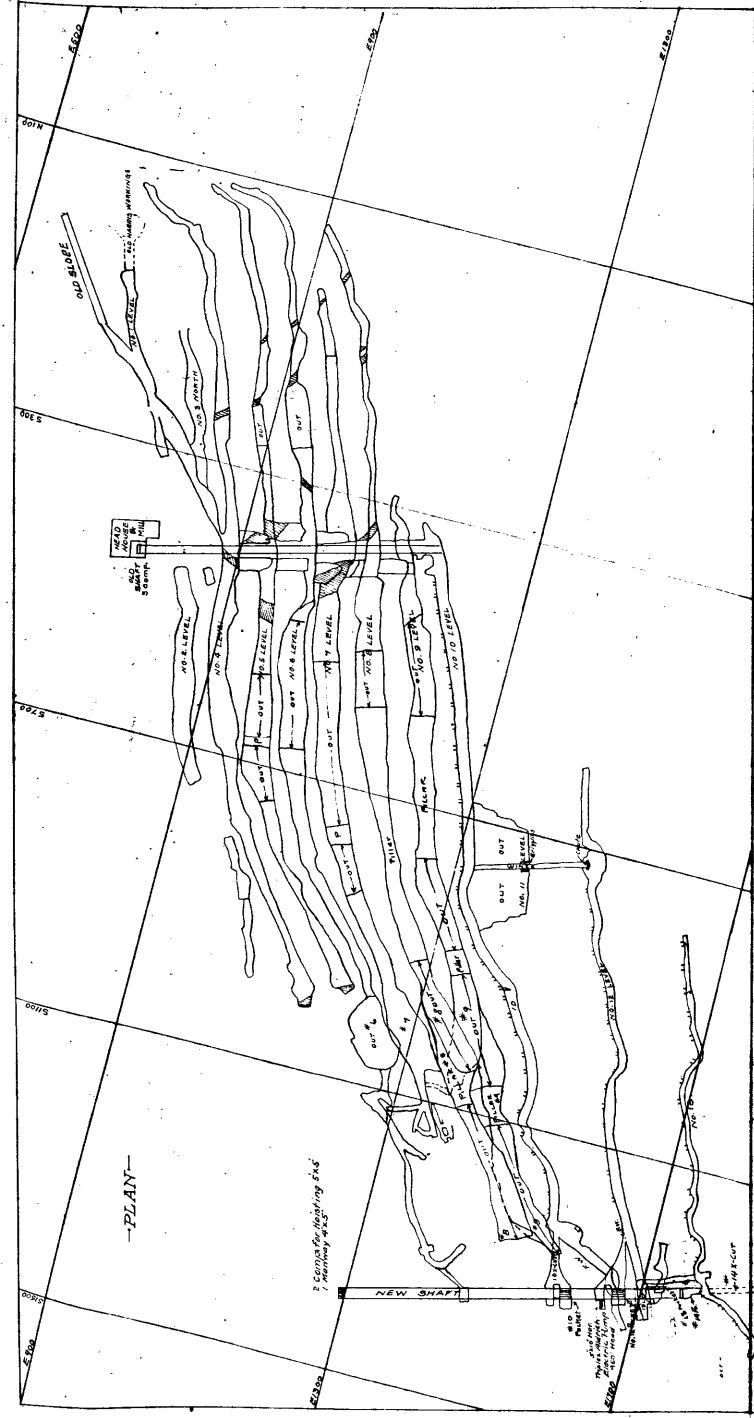

SECTION OF SHAFT AND VEIN
FROM THE 12 LEVEL TO THE 14 LEVEL.

- LEGEND
- ▲ Reymonte Dikes
 - ▲ Pump (Air-driven)
 - Glacial Drift
 - Alluv.
 - Assumed lines
 - Development
 - AD M-Diamond Drill Hole

—Revised—
July 23, 1920

—Revised—
MAP OF WASHINGTON MINE
Plan & Elevation. Min. prepared on the Plan
Empire Steel & Iron Co.
Oxford, New Jersey.
Scale 1" = 100 FT.
G.C.T. 1918
Drawn by G.P.P. & M.K.R.
Approved by G.P.P. & M.K.R.
10/20/1918

7108

NTGS 02145 41 20X 254145

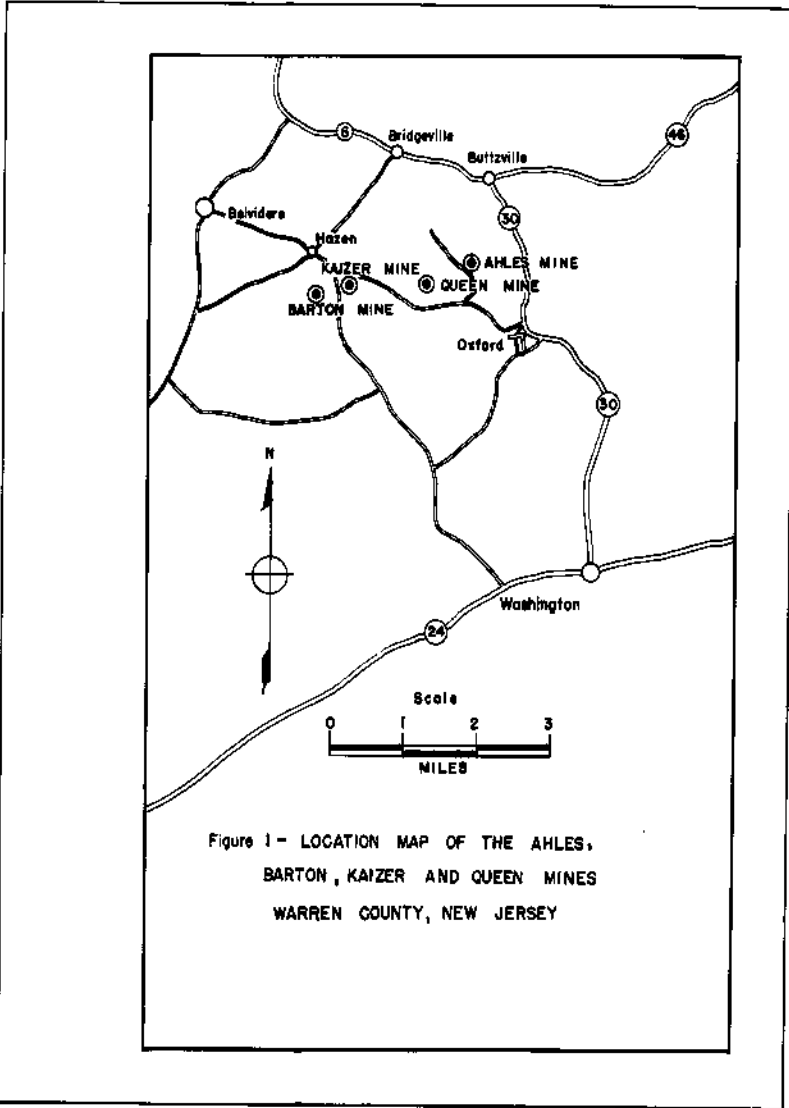

Figure 1- LOCATION MAP OF THE AHLES,
 BARTON, KAIZER AND QUEEN MINES
 WARREN COUNTY, NEW JERSEY

A1547

30002 336 | 14.5.1 300765

*Proposed
Sale*

*Sold by
Women*

Sold by Women

Sold by Women

Sold

Sold

Sold

Sold

Sold

*Sold
at
Auction*





Total Length of New Mine Vein now open 428 Feet.
 Total Cu in present slope to level of present main p. 1100 ft
 22,293 tons



Total surface area of Mine
 Area of Mine
 Car Wheel " 6653
 Area of Mine in depth the whole mine is about the size of
 Car Wheel " 6880 Tons
 " " " 2764 "
 " " " 3816 "

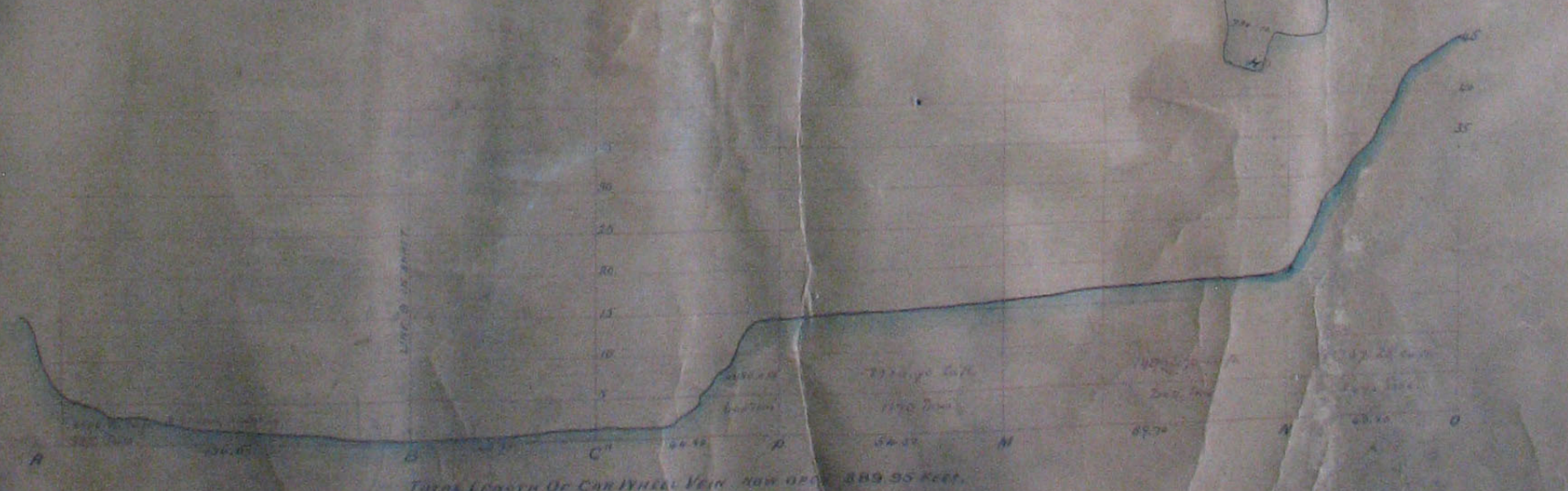

Total Length of Car Wheel Vein now open 389.95 Feet.
 Total Cu in present slope
 22,293 tons



ENLARGED
SECTION OF CENTRAL TRACT

(OXFORD FURNACE TRACT)

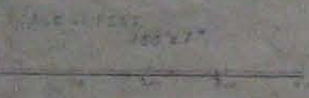

Washington Mine
Real Estate
#1045
ENC 6658

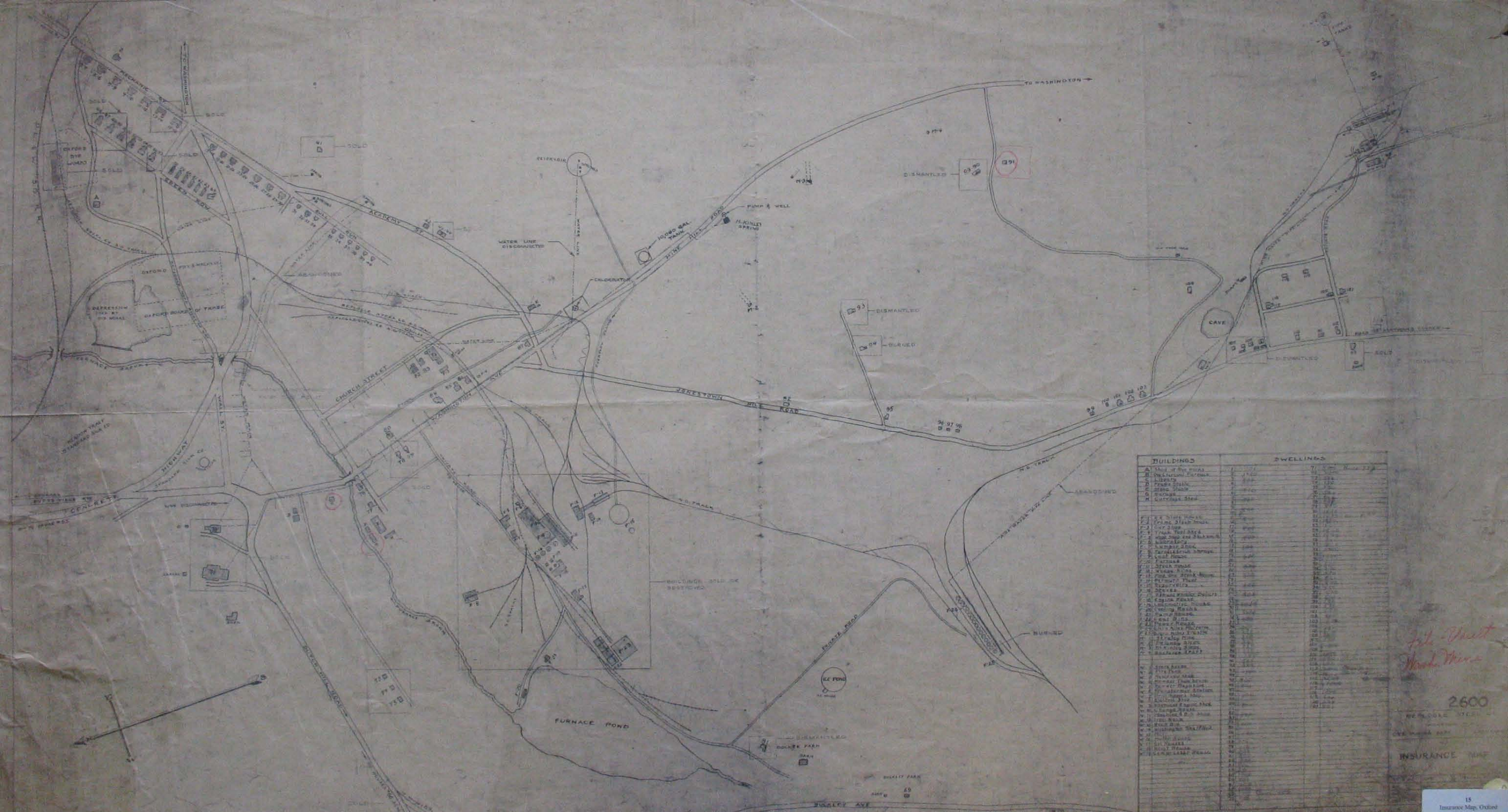

BUILDINGS		DWELLINGS	
A	Shed of the mill	71	100
B	Old Larson's Garage	72	101
C	Shed	73	102
D	Shed	74	103
E	Shed	75	104
F	Shed	76	105
G	Shed	77	106
H	Shed	78	107
I	Shed	79	108
J	Shed	80	109
K	Shed	81	110
L	Shed	82	111
M	Shed	83	112
N	Shed	84	113
O	Shed	85	114
P	Shed	86	115
Q	Shed	87	116
R	Shed	88	117
S	Shed	89	118
T	Shed	90	119
U	Shed	91	120
V	Shed	92	121
W	Shed	93	122
X	Shed	94	123
Y	Shed	95	124
Z	Shed	96	125
AA	Shed	97	126
AB	Shed	98	127
AC	Shed	99	128
AD	Shed	100	129
AE	Shed	101	130
AF	Shed	102	131
AG	Shed	103	132
AH	Shed	104	133
AI	Shed	105	134
AJ	Shed	106	135
AK	Shed	107	136
AL	Shed	108	137
AM	Shed	109	138
AN	Shed	110	139
AO	Shed	111	140
AP	Shed	112	141
AQ	Shed	113	142
AR	Shed	114	143
AS	Shed	115	144
AT	Shed	116	145
AU	Shed	117	146
AV	Shed	118	147
AW	Shed	119	148
AX	Shed	120	149
AY	Shed	121	150
AZ	Shed	122	151
BA	Shed	123	152
BB	Shed	124	153
BC	Shed	125	154
BD	Shed	126	155
BE	Shed	127	156
BF	Shed	128	157
BG	Shed	129	158
BH	Shed	130	159
BI	Shed	131	160
BJ	Shed	132	161
BK	Shed	133	162
BL	Shed	134	163
BM	Shed	135	164
BN	Shed	136	165
BO	Shed	137	166
BP	Shed	138	167
BQ	Shed	139	168
BR	Shed	140	169
BS	Shed	141	170
BT	Shed	142	171
BU	Shed	143	172
BV	Shed	144	173
BW	Shed	145	174
BX	Shed	146	175
BY	Shed	147	176
BZ	Shed	148	177
CA	Shed	149	178
CB	Shed	150	179
CC	Shed	151	180
CD	Shed	152	181
CE	Shed	153	182
CF	Shed	154	183
CG	Shed	155	184
CH	Shed	156	185
CI	Shed	157	186
CJ	Shed	158	187
CK	Shed	159	188
CL	Shed	160	189
CM	Shed	161	190
CN	Shed	162	191
CO	Shed	163	192
CP	Shed	164	193
CQ	Shed	165	194
CR	Shed	166	195
CS	Shed	167	196
CT	Shed	168	197
CU	Shed	169	198
CV	Shed	170	199
CV	Shed	171	200
CV	Shed	172	201
CV	Shed	173	202
CV	Shed	174	203
CV	Shed	175	204
CV	Shed	176	205
CV	Shed	177	206
CV	Shed	178	207
CV	Shed	179	208
CV	Shed	180	209
CV	Shed	181	210
CV	Shed	182	211
CV	Shed	183	212
CV	Shed	184	213
CV	Shed	185	214
CV	Shed	186	215
CV	Shed	187	216
CV	Shed	188	217
CV	Shed	189	218
CV	Shed	190	219
CV	Shed	191	220
CV	Shed	192	221
CV	Shed	193	222
CV	Shed	194	223
CV	Shed	195	224
CV	Shed	196	225
CV	Shed	197	226
CV	Shed	198	227
CV	Shed	199	228
CV	Shed	200	229
CV	Shed	201	230
CV	Shed	202	231
CV	Shed	203	232
CV	Shed	204	233
CV	Shed	205	234
CV	Shed	206	235
CV	Shed	207	236
CV	Shed	208	237
CV	Shed	209	238
CV	Shed	210	239
CV	Shed	211	240
CV	Shed	212	241
CV	Shed	213	242
CV	Shed	214	243
CV	Shed	215	244
CV	Shed	216	245
CV	Shed	217	246
CV	Shed	218	247
CV	Shed	219	248
CV	Shed	220	249
CV	Shed	221	250
CV	Shed	222	251
CV	Shed	223	252
CV	Shed	224	253
CV	Shed	225	254
CV	Shed	226	255
CV	Shed	227	256
CV	Shed	228	257
CV	Shed	229	258
CV	Shed	230	259
CV	Shed	231	260
CV	Shed	232	261
CV	Shed	233	262
CV	Shed	234	263
CV	Shed	235	264
CV	Shed	236	265
CV	Shed	237	266
CV	Shed	238	267
CV	Shed	239	268
CV	Shed	240	269
CV	Shed	241	270
CV	Shed	242	271
CV	Shed	243	272
CV	Shed	244	273
CV	Shed	245	274
CV	Shed	246	275
CV	Shed	247	276
CV	Shed	248	277
CV	Shed	249	278
CV	Shed	250	279
CV	Shed	251	280
CV	Shed	252	281
CV	Shed	253	282
CV	Shed	254	283
CV	Shed	255	284
CV	Shed	256	285
CV	Shed	257	286
CV	Shed	258	287
CV	Shed	259	288
CV	Shed	260	289
CV	Shed	261	290
CV	Shed	262	291
CV	Shed	263	292
CV	Shed	264	293
CV	Shed	265	294
CV	Shed	266	295
CV	Shed	267	296
CV	Shed	268	297
CV	Shed	269	298
CV	Shed	270	299
CV	Shed	271	300

*File - West
Made Mine*

2600

INSURANCE MAP



BUILDINGS		DWELLINGS	
A	Shop at the mill	1	101
B	Blacksmith	2	102
C	Livery	3	103
D	Store	4	104
E	Blacksmith	5	105
F	Blacksmith	6	106
G	Blacksmith	7	107
H	Blacksmith	8	108
I	Blacksmith	9	109
J	Blacksmith	10	110
K	Blacksmith	11	111
L	Blacksmith	12	112
M	Blacksmith	13	113
N	Blacksmith	14	114
O	Blacksmith	15	115
P	Blacksmith	16	116
Q	Blacksmith	17	117
R	Blacksmith	18	118
S	Blacksmith	19	119
T	Blacksmith	20	120
U	Blacksmith	21	121
V	Blacksmith	22	122
W	Blacksmith	23	123
X	Blacksmith	24	124
Y	Blacksmith	25	125
Z	Blacksmith	26	126
AA	Blacksmith	27	127
AB	Blacksmith	28	128
AC	Blacksmith	29	129
AD	Blacksmith	30	130
AE	Blacksmith	31	131
AF	Blacksmith	32	132
AG	Blacksmith	33	133
AH	Blacksmith	34	134
AI	Blacksmith	35	135
AJ	Blacksmith	36	136
AK	Blacksmith	37	137
AL	Blacksmith	38	138
AM	Blacksmith	39	139
AN	Blacksmith	40	140
AO	Blacksmith	41	141
AP	Blacksmith	42	142
AQ	Blacksmith	43	143
AR	Blacksmith	44	144
AS	Blacksmith	45	145
AT	Blacksmith	46	146
AU	Blacksmith	47	147
AV	Blacksmith	48	148
AW	Blacksmith	49	149
AX	Blacksmith	50	150
AY	Blacksmith	51	151
AZ	Blacksmith	52	152
BA	Blacksmith	53	153
BB	Blacksmith	54	154
BC	Blacksmith	55	155
BD	Blacksmith	56	156
BE	Blacksmith	57	157
BF	Blacksmith	58	158
BG	Blacksmith	59	159
BH	Blacksmith	60	160
BI	Blacksmith	61	161
BJ	Blacksmith	62	162
BK	Blacksmith	63	163
BL	Blacksmith	64	164
BM	Blacksmith	65	165
BN	Blacksmith	66	166
BO	Blacksmith	67	167
BP	Blacksmith	68	168
BQ	Blacksmith	69	169
BR	Blacksmith	70	170
BS	Blacksmith	71	171
BT	Blacksmith	72	172
BU	Blacksmith	73	173
BV	Blacksmith	74	174
BW	Blacksmith	75	175
BX	Blacksmith	76	176
BY	Blacksmith	77	177
BZ	Blacksmith	78	178
CA	Blacksmith	79	179
CB	Blacksmith	80	180
CC	Blacksmith	81	181
CD	Blacksmith	82	182
CE	Blacksmith	83	183
CF	Blacksmith	84	184
CG	Blacksmith	85	185
CH	Blacksmith	86	186
CI	Blacksmith	87	187
CJ	Blacksmith	88	188
CK	Blacksmith	89	189
CL	Blacksmith	90	190
CM	Blacksmith	91	191
CN	Blacksmith	92	192
CO	Blacksmith	93	193
CP	Blacksmith	94	194
CQ	Blacksmith	95	195
CR	Blacksmith	96	196
CS	Blacksmith	97	197
CT	Blacksmith	98	198
CU	Blacksmith	99	199
CV	Blacksmith	100	200
CV	Blacksmith	101	201
CV	Blacksmith	102	202
CV	Blacksmith	103	203
CV	Blacksmith	104	204
CV	Blacksmith	105	205
CV	Blacksmith	106	206
CV	Blacksmith	107	207
CV	Blacksmith	108	208
CV	Blacksmith	109	209
CV	Blacksmith	110	210
CV	Blacksmith	111	211
CV	Blacksmith	112	212
CV	Blacksmith	113	213
CV	Blacksmith	114	214
CV	Blacksmith	115	215
CV	Blacksmith	116	216
CV	Blacksmith	117	217
CV	Blacksmith	118	218
CV	Blacksmith	119	219
CV	Blacksmith	120	220
CV	Blacksmith	121	221
CV	Blacksmith	122	222
CV	Blacksmith	123	223
CV	Blacksmith	124	224
CV	Blacksmith	125	225
CV	Blacksmith	126	226
CV	Blacksmith	127	227
CV	Blacksmith	128	228
CV	Blacksmith	129	229
CV	Blacksmith	130	230
CV	Blacksmith	131	231
CV	Blacksmith	132	232
CV	Blacksmith	133	233
CV	Blacksmith	134	234
CV	Blacksmith	135	235
CV	Blacksmith	136	236
CV	Blacksmith	137	237
CV	Blacksmith	138	238
CV	Blacksmith	139	239
CV	Blacksmith	140	240
CV	Blacksmith	141	241
CV	Blacksmith	142	242
CV	Blacksmith	143	243
CV	Blacksmith	144	244
CV	Blacksmith	145	245
CV	Blacksmith	146	246
CV	Blacksmith	147	247
CV	Blacksmith	148	248
CV	Blacksmith	149	249
CV	Blacksmith	150	250
CV	Blacksmith	151	251
CV	Blacksmith	152	252
CV	Blacksmith	153	253
CV	Blacksmith	154	254
CV	Blacksmith	155	255
CV	Blacksmith	156	256
CV	Blacksmith	157	257
CV	Blacksmith	158	258
CV	Blacksmith	159	259
CV	Blacksmith	160	260
CV	Blacksmith	161	261
CV	Blacksmith	162	262
CV	Blacksmith	163	263
CV	Blacksmith	164	264
CV	Blacksmith	165	265
CV	Blacksmith	166	266
CV	Blacksmith	167	267
CV	Blacksmith	168	268
CV	Blacksmith	169	269
CV	Blacksmith	170	270
CV	Blacksmith	171	271
CV	Blacksmith	172	272
CV	Blacksmith	173	273
CV	Blacksmith	174	274
CV	Blacksmith	175	275
CV	Blacksmith	176	276
CV	Blacksmith	177	277
CV	Blacksmith	178	278
CV	Blacksmith	179	279
CV	Blacksmith	180	280
CV	Blacksmith	181	281
CV	Blacksmith	182	282
CV	Blacksmith	183	283
CV	Blacksmith	184	284
CV	Blacksmith	185	285
CV	Blacksmith	186	286
CV	Blacksmith	187	287
CV	Blacksmith	188	288
CV	Blacksmith	189	289
CV	Blacksmith	190	290
CV	Blacksmith	191	291
CV	Blacksmith	192	292
CV	Blacksmith	193	293
CV	Blacksmith	194	294
CV	Blacksmith	195	295
CV	Blacksmith	196	296
CV	Blacksmith	197	297
CV	Blacksmith	198	298
CV	Blacksmith	199	299
CV	Blacksmith	200	300

2600

INSURANCE

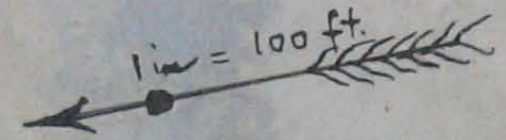

OXFORD FURNACE.

(Jas. Clark Map.) 1908.

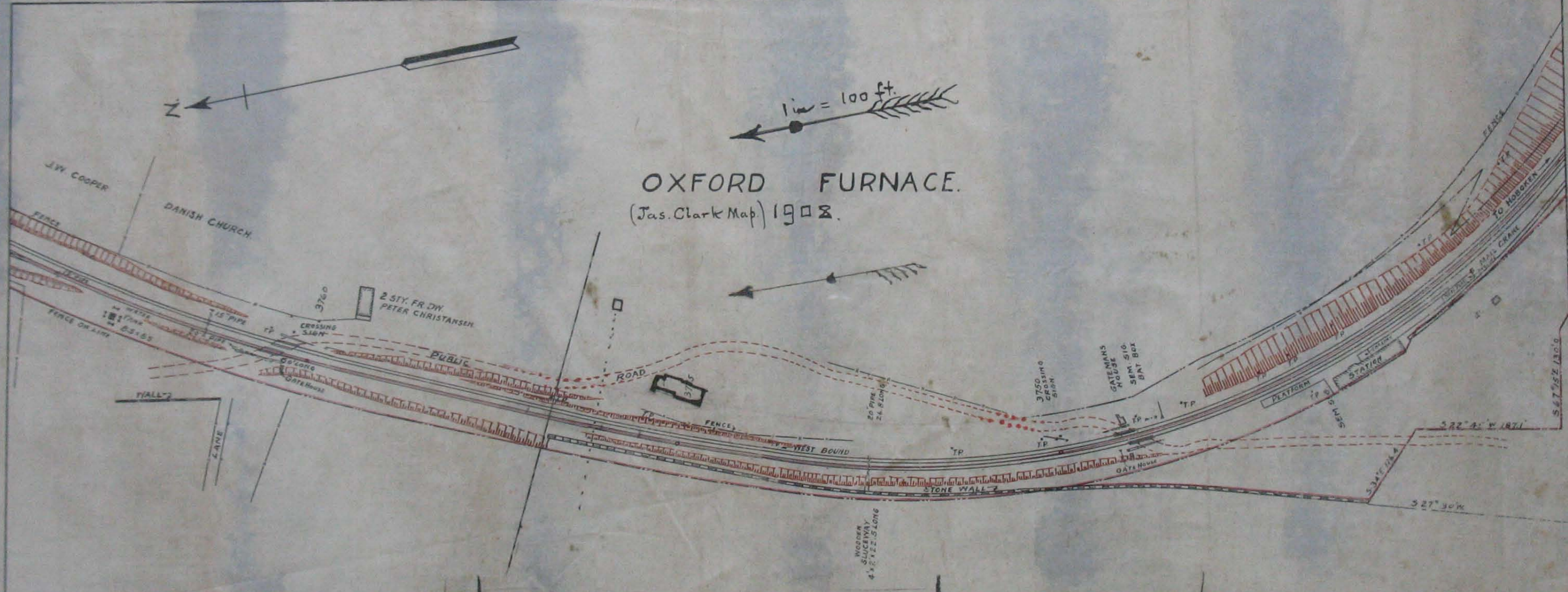

MAP
 OF A PORTION OF THE
OXFORD FURNACE ESTATE
EMBRACING THE VILLAGE
IRON WORKS &
MINES

Surveyed October 1863.
 206.48 A.

Scale 220 feet to 1 inch
 Drawn by B. S. Hall 1863

TABLE OF DISTANCES FROM
OXFORD FURNACE
TO

The Morris Canal	3 Miles
Junction of Central R.R. of N.J.	8 "
Elizabeth Port	26 "
Junction Elizabeth & D.R.R.	56 "
Franklin	74 "
Morris & Essex proposed Extension	136 "

- REFERENCES**
- A. Wheelwright Shop
 - B. Blacksmith Shop
 - C. Coal and Slack House
 - D. Bridge House
 - E. Furnace House
 - F. Engine House
 - G. Stone Reef Mill
 - H. Tin and Leadman Shop
 - I. Machine House S.T.S.
 - J. Black Shop
 - K. Steel Foundry Building
 - L. Machine Shop
 - M. Ore Yard
 - N. Stables
 - O. Presbyterian Church
 - P. Wesleyan Room
 - Q. German Reformed Church
 - R. Catholic Church

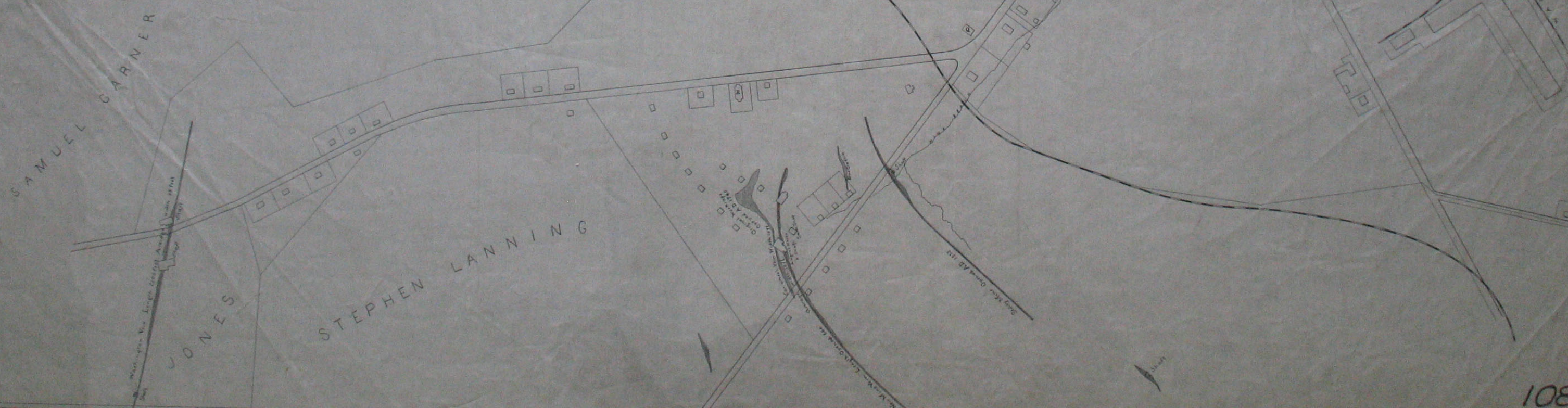

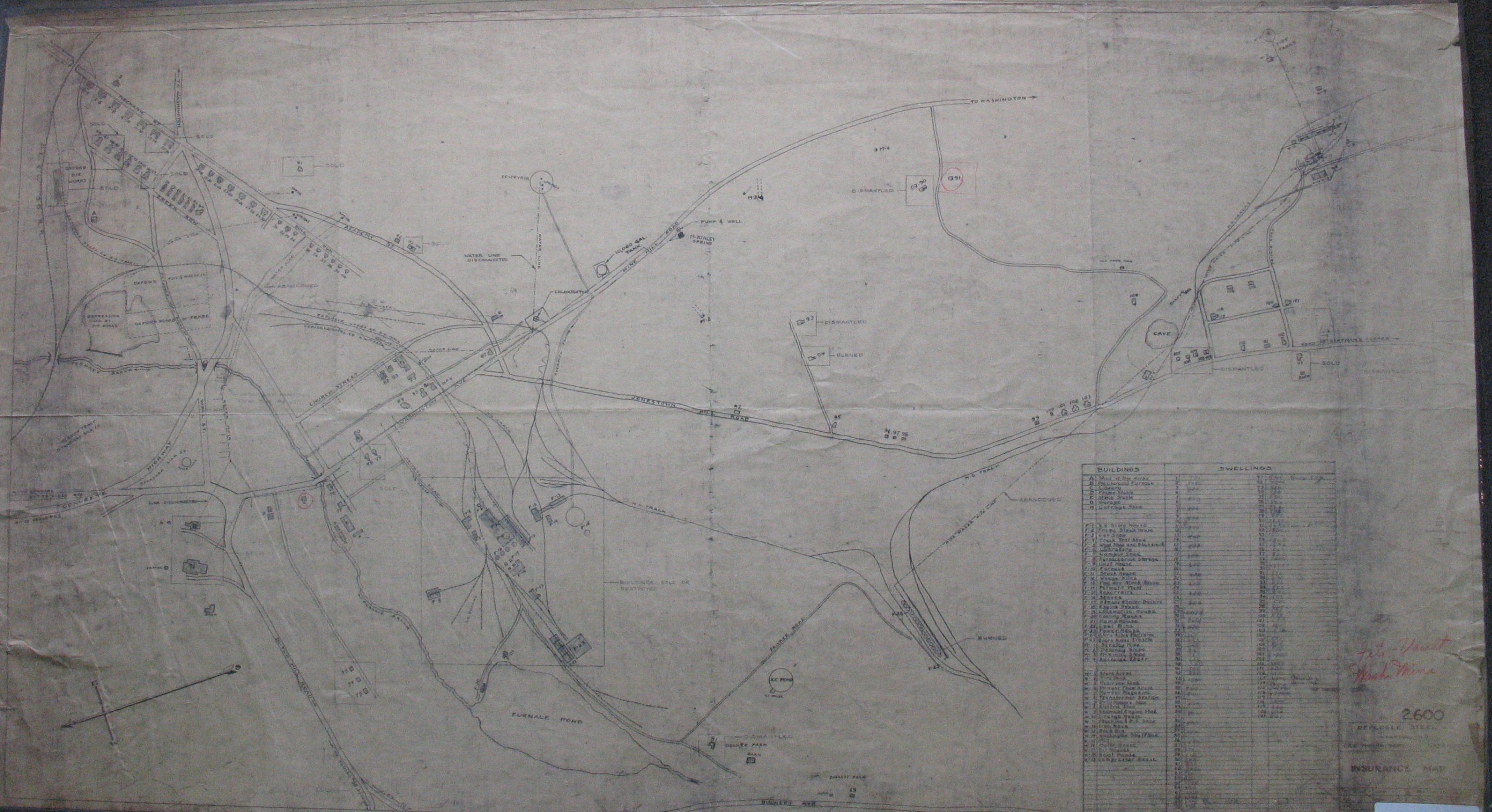

BUILDINGS		DWELLINGS	
A	Shed at the mill	1	200
B	Shed at the mill	2	150
C	Shed at the mill	3	150
D	Shed at the mill	4	150
E	Shed at the mill	5	150
F	Shed at the mill	6	150
G	Shed at the mill	7	150
H	Shed at the mill	8	150
I	Shed at the mill	9	150
J	Shed at the mill	10	150
K	Shed at the mill	11	150
L	Shed at the mill	12	150
M	Shed at the mill	13	150
N	Shed at the mill	14	150
O	Shed at the mill	15	150
P	Shed at the mill	16	150
Q	Shed at the mill	17	150
R	Shed at the mill	18	150
S	Shed at the mill	19	150
T	Shed at the mill	20	150
U	Shed at the mill	21	150
V	Shed at the mill	22	150
W	Shed at the mill	23	150
X	Shed at the mill	24	150
Y	Shed at the mill	25	150
Z	Shed at the mill	26	150
AA	Shed at the mill	27	150
AB	Shed at the mill	28	150
AC	Shed at the mill	29	150
AD	Shed at the mill	30	150
AE	Shed at the mill	31	150
AF	Shed at the mill	32	150
AG	Shed at the mill	33	150
AH	Shed at the mill	34	150
AI	Shed at the mill	35	150
AJ	Shed at the mill	36	150
AK	Shed at the mill	37	150
AL	Shed at the mill	38	150
AM	Shed at the mill	39	150
AN	Shed at the mill	40	150
AO	Shed at the mill	41	150
AP	Shed at the mill	42	150
AQ	Shed at the mill	43	150
AR	Shed at the mill	44	150
AS	Shed at the mill	45	150
AT	Shed at the mill	46	150
AU	Shed at the mill	47	150
AV	Shed at the mill	48	150
AW	Shed at the mill	49	150
AX	Shed at the mill	50	150
AY	Shed at the mill	51	150
AZ	Shed at the mill	52	150
BA	Shed at the mill	53	150
BB	Shed at the mill	54	150
BC	Shed at the mill	55	150
BD	Shed at the mill	56	150
BE	Shed at the mill	57	150
BF	Shed at the mill	58	150
BG	Shed at the mill	59	150
BH	Shed at the mill	60	150
BI	Shed at the mill	61	150
BJ	Shed at the mill	62	150
BK	Shed at the mill	63	150
BL	Shed at the mill	64	150
BM	Shed at the mill	65	150
BN	Shed at the mill	66	150
BO	Shed at the mill	67	150
BP	Shed at the mill	68	150
BQ	Shed at the mill	69	150
BR	Shed at the mill	70	150
BS	Shed at the mill	71	150
BT	Shed at the mill	72	150
BU	Shed at the mill	73	150
BV	Shed at the mill	74	150
BW	Shed at the mill	75	150
BX	Shed at the mill	76	150
BY	Shed at the mill	77	150
BZ	Shed at the mill	78	150
CA	Shed at the mill	79	150
CB	Shed at the mill	80	150
CC	Shed at the mill	81	150
CD	Shed at the mill	82	150
CE	Shed at the mill	83	150
CF	Shed at the mill	84	150
CG	Shed at the mill	85	150
CH	Shed at the mill	86	150
CI	Shed at the mill	87	150
CJ	Shed at the mill	88	150
CK	Shed at the mill	89	150
CL	Shed at the mill	90	150
CM	Shed at the mill	91	150
CN	Shed at the mill	92	150
CO	Shed at the mill	93	150
CP	Shed at the mill	94	150
CQ	Shed at the mill	95	150
CR	Shed at the mill	96	150
CS	Shed at the mill	97	150
CT	Shed at the mill	98	150
CU	Shed at the mill	99	150
CV	Shed at the mill	100	150
CV	Shed at the mill	101	150
CV	Shed at the mill	102	150
CV	Shed at the mill	103	150
CV	Shed at the mill	104	150
CV	Shed at the mill	105	150
CV	Shed at the mill	106	150
CV	Shed at the mill	107	150
CV	Shed at the mill	108	150
CV	Shed at the mill	109	150
CV	Shed at the mill	110	150
CV	Shed at the mill	111	150
CV	Shed at the mill	112	150
CV	Shed at the mill	113	150
CV	Shed at the mill	114	150
CV	Shed at the mill	115	150
CV	Shed at the mill	116	150
CV	Shed at the mill	117	150
CV	Shed at the mill	118	150
CV	Shed at the mill	119	150
CV	Shed at the mill	120	150
CV	Shed at the mill	121	150
CV	Shed at the mill	122	150
CV	Shed at the mill	123	150
CV	Shed at the mill	124	150
CV	Shed at the mill	125	150
CV	Shed at the mill	126	150
CV	Shed at the mill	127	150
CV	Shed at the mill	128	150
CV	Shed at the mill	129	150
CV	Shed at the mill	130	150
CV	Shed at the mill	131	150
CV	Shed at the mill	132	150
CV	Shed at the mill	133	150
CV	Shed at the mill	134	150
CV	Shed at the mill	135	150
CV	Shed at the mill	136	150
CV	Shed at the mill	137	150
CV	Shed at the mill	138	150
CV	Shed at the mill	139	150
CV	Shed at the mill	140	150
CV	Shed at the mill	141	150
CV	Shed at the mill	142	150
CV	Shed at the mill	143	150
CV	Shed at the mill	144	150
CV	Shed at the mill	145	150
CV	Shed at the mill	146	150
CV	Shed at the mill	147	150
CV	Shed at the mill	148	150
CV	Shed at the mill	149	150
CV	Shed at the mill	150	150

*John Vanst
March 1866*

2600

INSURANCE MAP

3-149

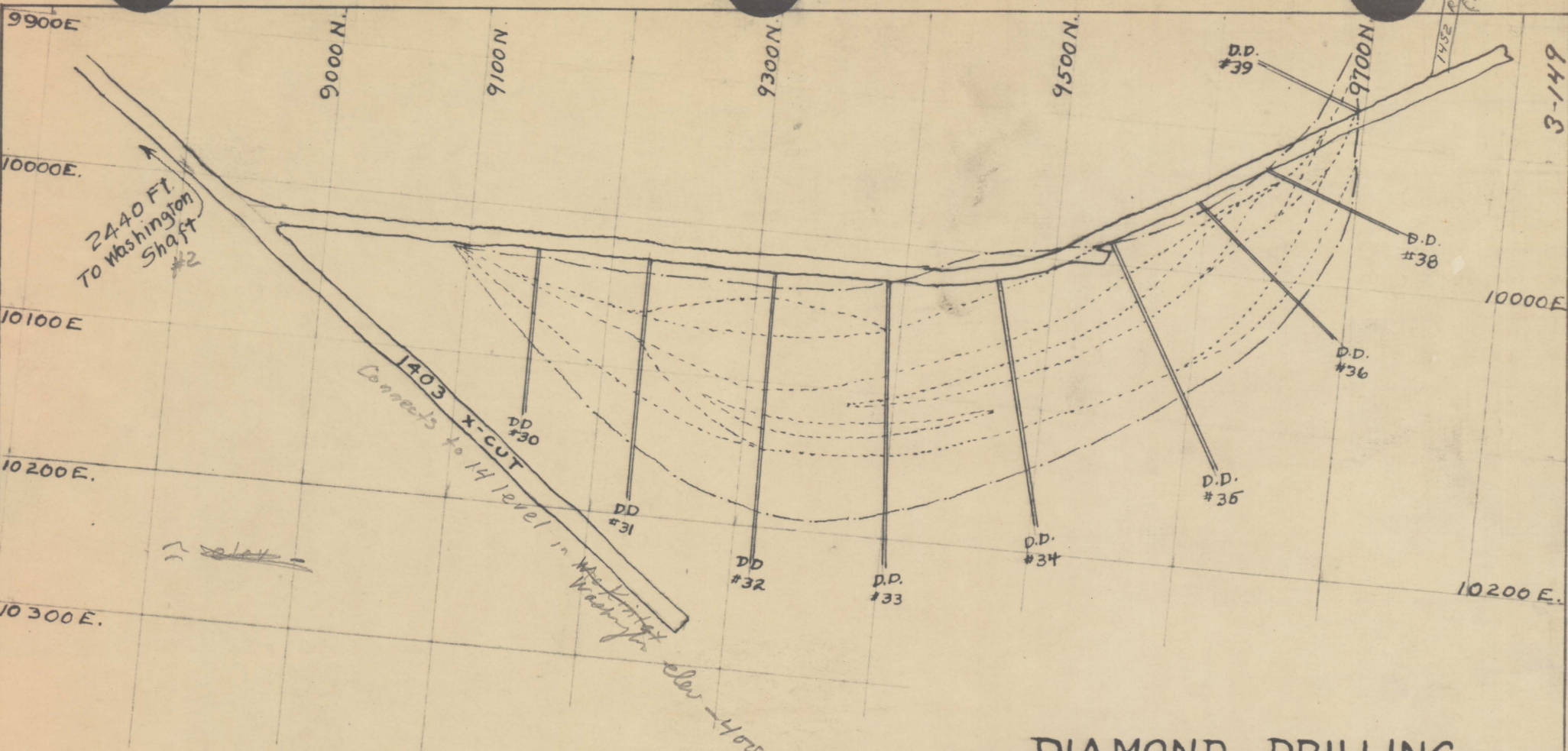

LEGEND

- ORE OVER 30% TOTAL FE.
- ORE 25 TO 30% " "
- ORE 20 TO 25% " "
- VEIN MATERIAL UNDER 20%
- COUNTRY ROCK

DIAMOND DRILLING
 MCKINLEY VEIN AT 14 LEVEL

ALAN WOOD STEEL CO.

OXFORD N. J.

SCALE 1" = 100'

4006
~~3-149~~



MATERIAL LIST				
ITEM	NO. REQ'D	SIZE OR W'GHT	MAT. ERIAL	DESCRIPTION

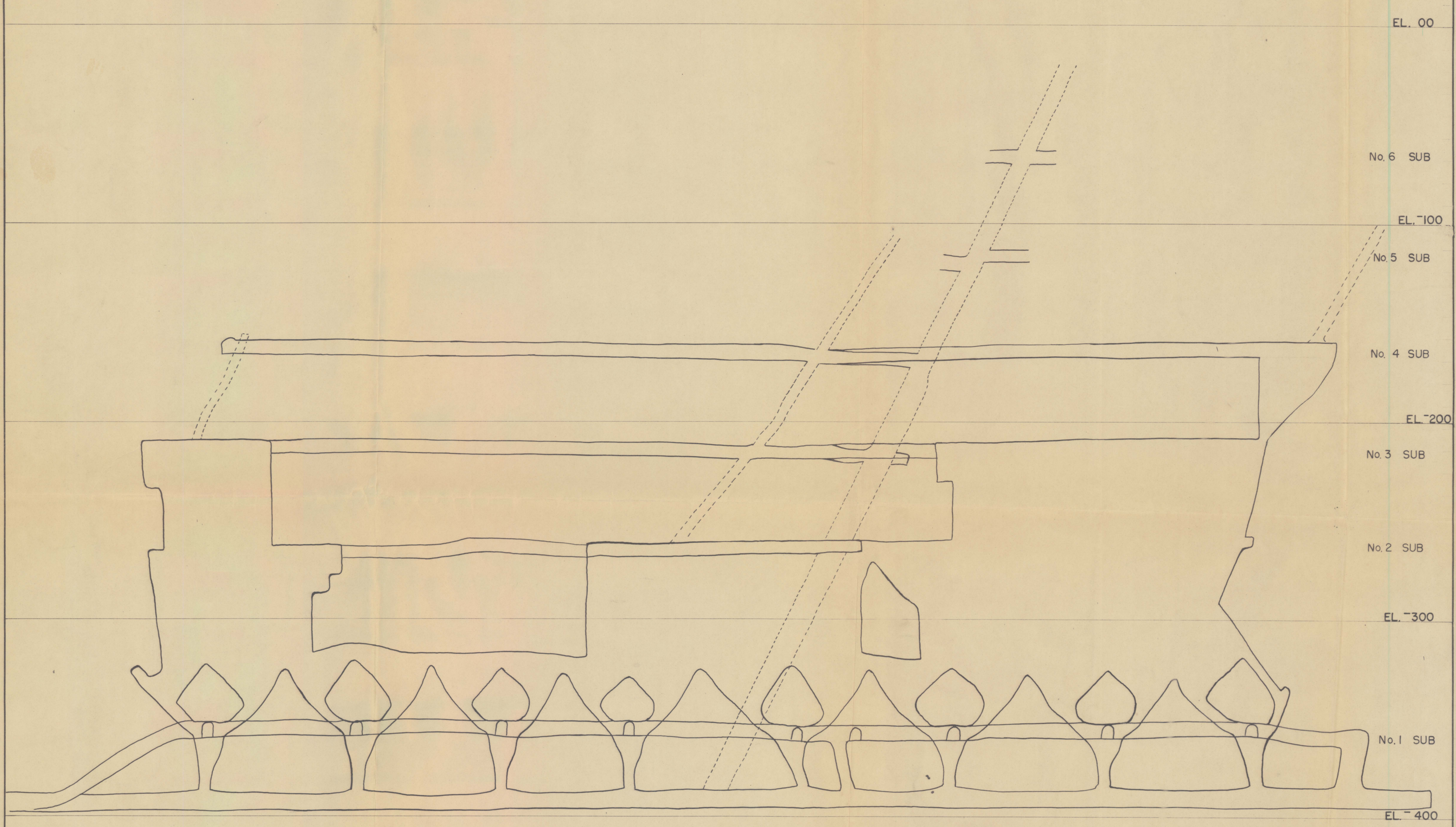

DERIVATIONS		REVISIONS		
A. W. S. CO. NUMBER	NO.	DATE	REMARKS	BY

ALAN WOOD STEEL COMPANY
CONSHOHOCKEN, PENNA.

DATE	PROFILE OF MCKINLEY VEIN	SCALE	1" = 30'
DWG.		NUMBER	9011 9010
TR'CD		NOTE: THIS DRAWING IS LOANED AND REMAINS THE PROPERTY OF THE COMPANY, AND CANNOT BE REPRODUCED OR USED IN WHOLE OR PART EXCEPT BY ITS PERMISSION.	
C'K'D			
APPROVED	CH. ENG.		

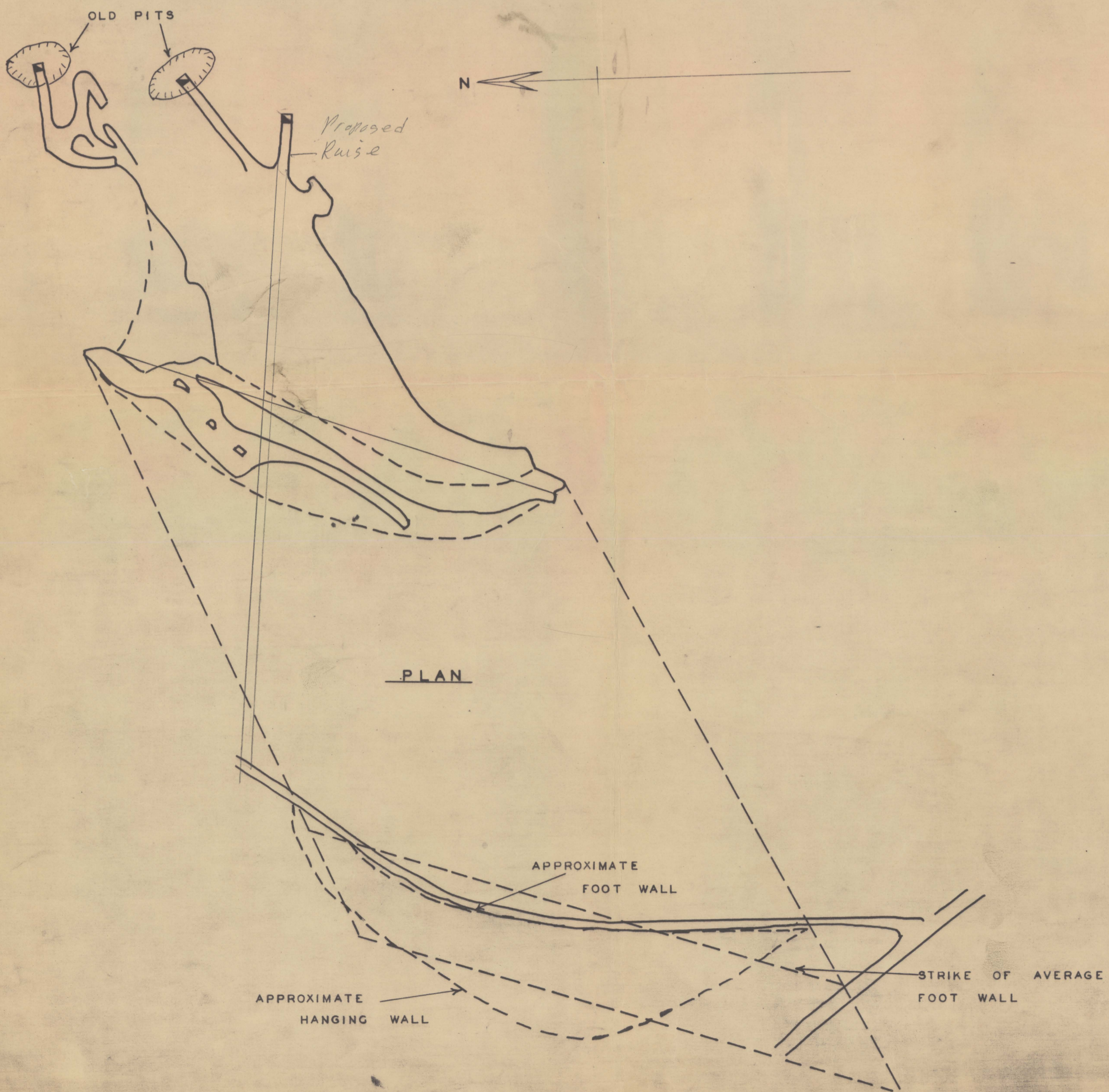
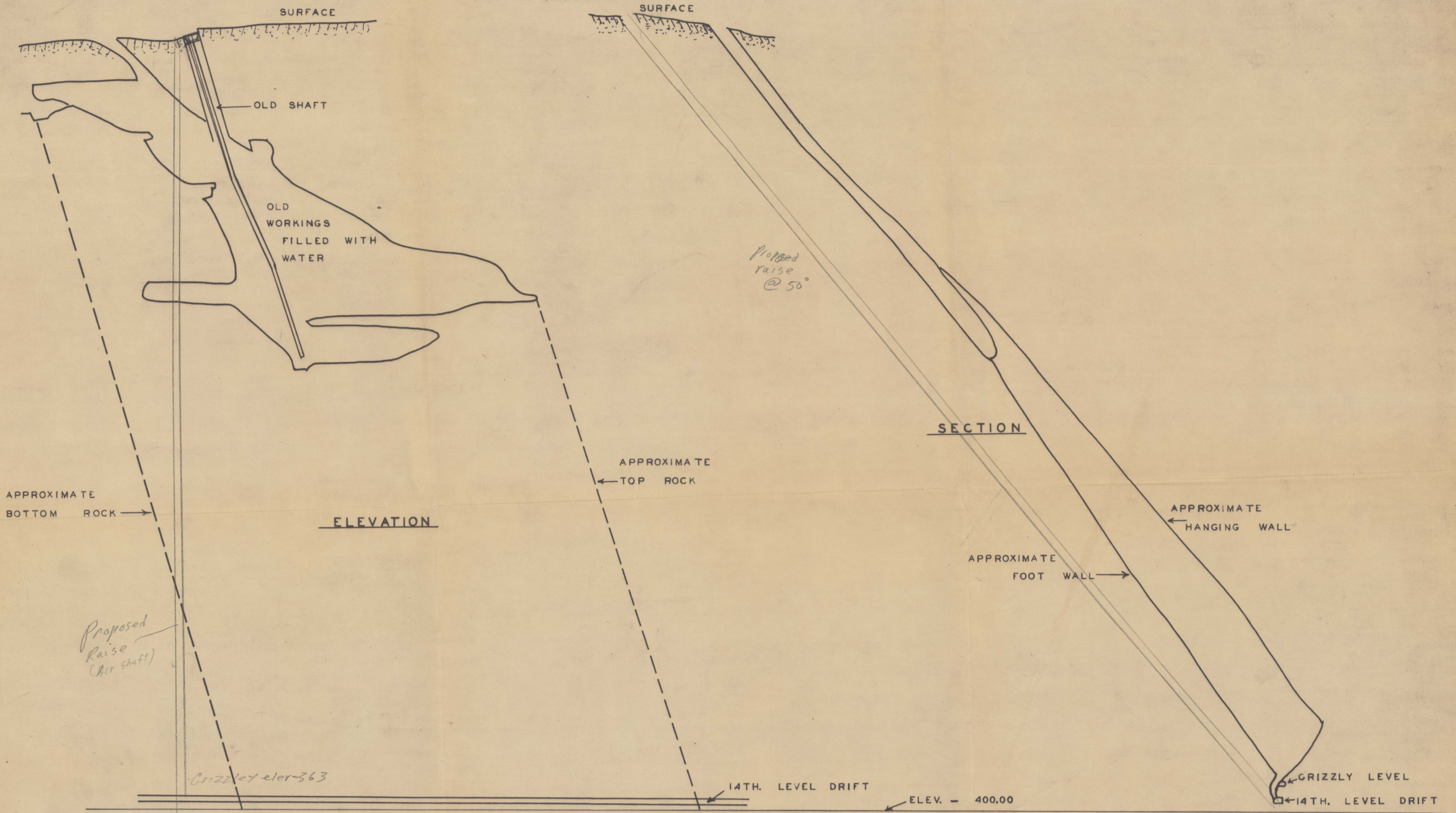

MAP OF M^KKINLEY ORE BODY
 OXFORD, N.J.
 SCALE:- 1"=100'
 MARCH 24, 1941.

ALAN WOOD STEEL CO.
 DOVER, N.J.
 MINING DEPT. DOVER DIV.
 9009

BY	APP	DATE:- 3-24-1941
DR.	REV.	SCALE:- 1"= 100'
TR.	REV.	NO. 4066
CKD.	REV.	

3-148

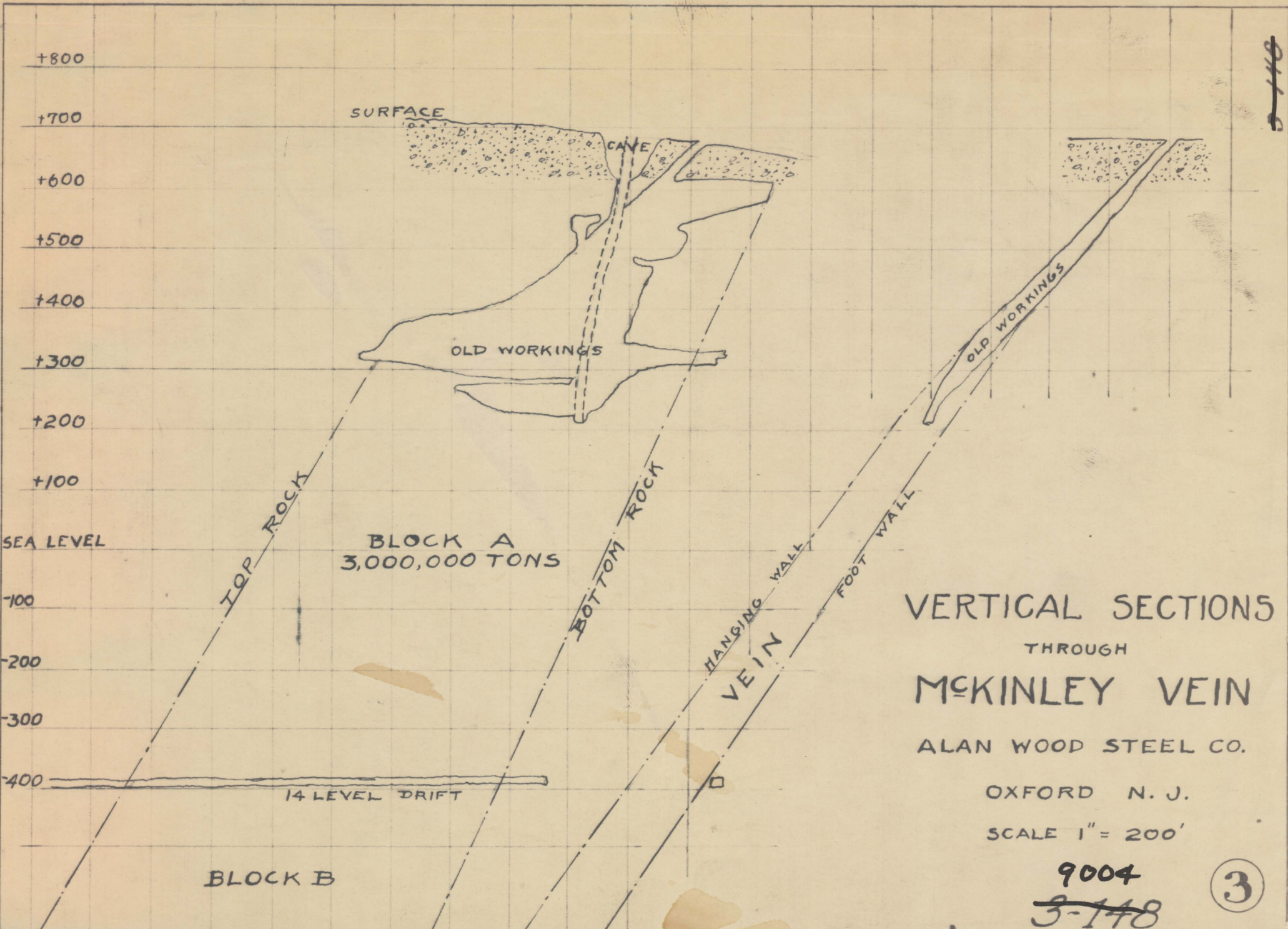

VERTICAL SECTIONS
THROUGH
MCKINLEY VEIN

ALAN WOOD STEEL CO.

OXFORD N. J.

SCALE 1" = 200'

9004

~~3-148~~

3

PART OF
OXFORD FURNACE

OXFORD TWP
Scale 24 Rods to the inch

1874



Washington Mine
Oxford, N.D.

Info. from Carl Loux, Supt.
1-11-43

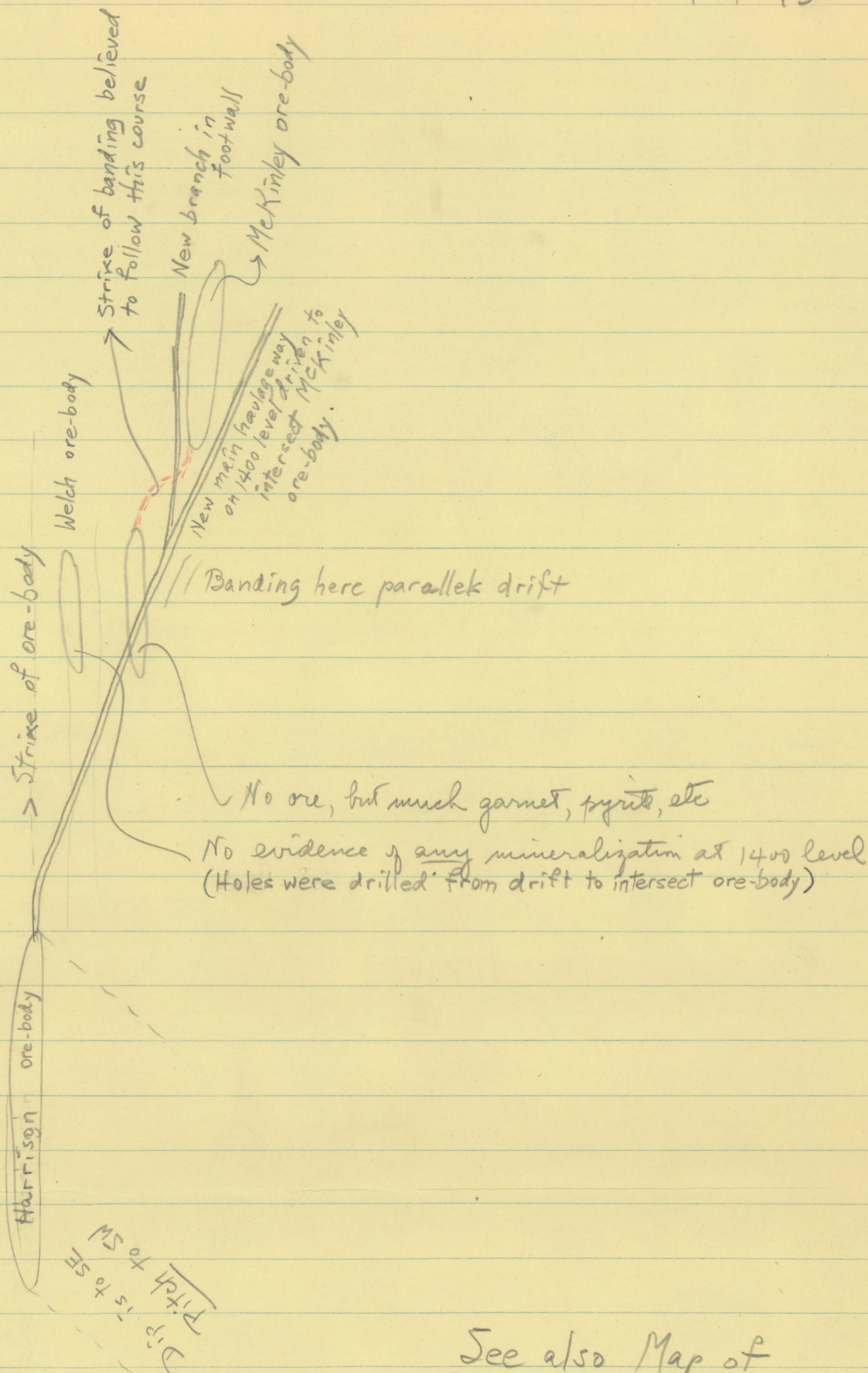

See also Map of
Oxford Iron-Ore Veins
accompanying Cook's 1868 report