

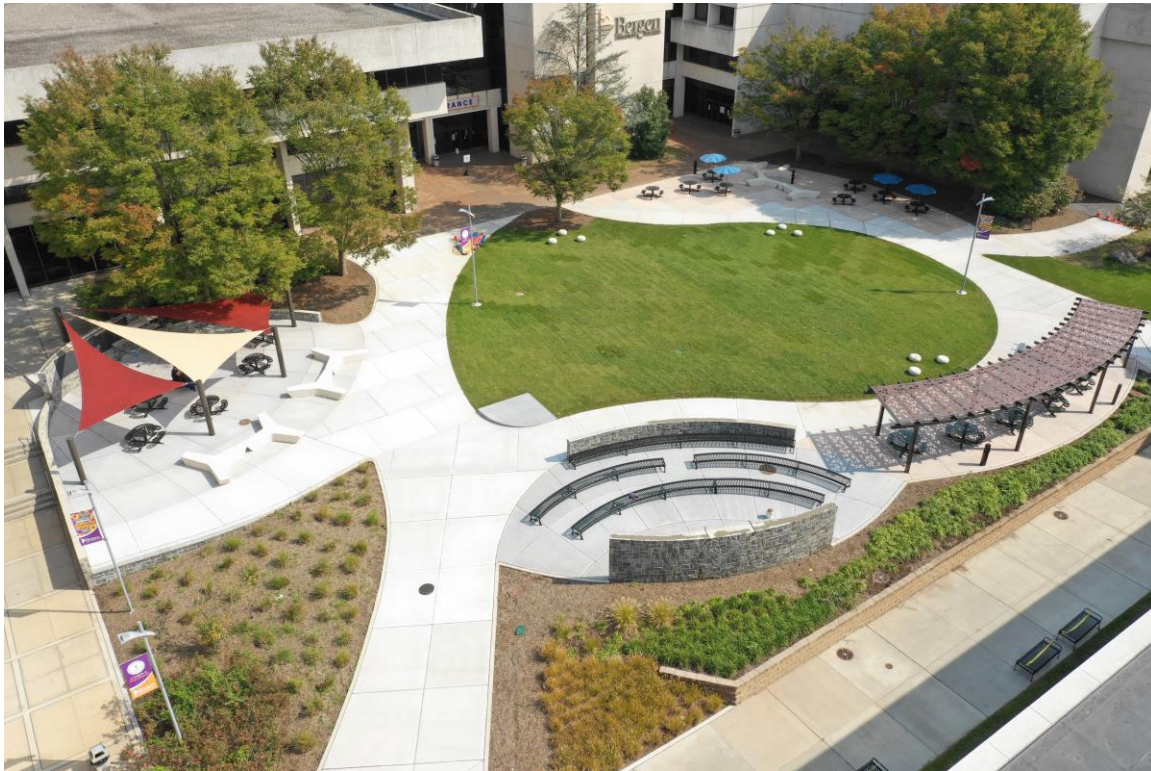

Annual Institutional Profile Report 2021



September 2021

Preface

I am pleased to submit the 2021 Annual Institutional Profile (AIP) for Bergen Community College.

Submission of the attached report fulfills the 1994 Higher Education Restructuring Act mandate to “prepare and make available to the public an annual report on the condition of the institution.” The form and content of the report is established by the Office of the Secretary of Higher Education, and the performance indicators and institutional information in the AIP have been compiled and arranged by the Center for Institutional Effectiveness at Bergen Community College. The Annual Institutional Profile provides a summary of the relevant institutional data, as well as the College’s accomplishments and contributions to our community.

College Overview

Bergen Community College was founded in 1965 to provide accessible, affordable, and comprehensive community education services for the Bergen County region. Construction of the permanent campus began in 1969 in Paramus. Over the past half-century, the college has expanded its main campus to include an expansive library, theater, student center, and new buildings housing additional classroom space, and state-of-the-art technology, art, music, communications facilities, a Health Professions Integrated Teaching Center, and a STEM Student Research Center featuring state-of-the-art equipment for student research. More recent construction projects include the campus quad and outdoor classroom as well as the renovation of the One-Stop Center at the main campus. As of Fall 2020, Bergen Community College enrolled more than 11,000 students in degree programs, as well as more than 5,000 additional students in continuing and adult education programs. In 2021, Bergen Community College welcomed the leadership of a new President, Dr. Eric M. Friedman. Responding to the challenges introduced by a worldwide pandemic, the College has positioned itself as a recognized hub-site for post-COVID economic recovery, leveraging its many strengths and partnerships.

Vision

Bergen Community College will be a dynamic partner by bridging potential with opportunities for educational, professional and personal growth.

Mission

To inspire our community to realize a better future.

Values

To fulfill the vision and mission of Bergen Community College, these core values will guide our daily endeavors:

- Learning
- Excellence
- Integrity
- Respect
- Creativity

All information supplied in the following Institutional Profile, prepared by the Center for Institutional Effectiveness at Bergen Community College, is accurate and complete to the best of my knowledge.



Dr. Eric M. Friedman
President
Bergen Community College

Table of Contents

Table of Contents	III
Section A. Accreditation Status	1
1. Institutional Accreditation	1
2. Professional Accreditation	1
Section B. Number of Students Served	2
1. Number of Undergraduate Students by Attendance Status	2
2. Number of Graduate Students by Attendance Status	2
3. Number of Non-Credit Students Served	2
4. Unduplicated Number of Students for Entire Academic Year	2
Section C. Characteristics of Undergraduate Students	3
1. Mean Math, Reading, and Writing SAT Scores	3
2. Enrollment in Remediation Courses by Subject Area	3
3. Race/Ethnicity, Sex, and Age	4
4. Numbers of Students Receiving Financial Assistance Under Each Federal-Funded, State-Funded, and Institution-Funded Aid Program [AY 2019-20 data]	5
5. Percentage of Students who are New Jersey Residents.....	5
Section D. Student Outcomes	6
1. Graduation Rates	6
2. Third-Semester Retention of First-Time Undergraduates, Fall 2019 to Fall 2020.....	6
Section E. Faculty Characteristics	7
1. Full-Time Faculty by Race/Ethnicity, Sex, Tenure Status and Academic Rank, Fall 2020.....	7
2. Percentage of Course Sections Taught by Full-Time Faculty, Fall 2020	7
3. Ratio of Full- to Part-Time Faculty, Fall 2020.....	7
Section F. Characteristics of the Board of Trustees	8
1. Race/Ethnicity and Sex	8
2. List of Trustees with Titles/Affiliations	8
3. Additional Information about Trustees.....	8
Section G. Profile of the Institution	9
Section H. Major Research and Public Service Activities	12
1. Selected Faculty Scholarship, Service Learning, and Community Outreach	12
2. Grants Administration	16
Section I. Major Capital Projects Underway in Fiscal Year 2021	17
Section J. Strategic Planning Goals	18

Section A. Accreditation Status

1. Institutional Accreditation

Bergen Community College is accredited by the Middle States Commission on Higher Education. Accreditation was last reaffirmed by Middle States in June 2016.

2. Professional Accreditation

The following professional programs are individually accredited:

Program	Accrediting Agency
Dental Hygiene	Commission on Dental Accreditation
Diagnostic Medical Sonography	Commission on Accreditation of Allied Health Education Programs Joint Review Committee on Education in Diagnostic Medical Sonography
Legal Nurse Consultant	American Bar Association
Medical Office Assistant	Commission on Accreditation of Allied Health Education Programs Medical Assisting Education Review Board
Nursing	New Jersey Board of Nursing Accreditation Commission for Education in Nursing
Paralegal Studies	American Bar Association
Paramedic Science	Committee on Accreditation of Educational Programs for the Emergency Medical Services Professions
Radiation Therapy	Joint Review Committee on Education in Radiologic Technology New Jersey Department of Environmental Protection Bureau of X-ray Compliance
Radiography	Joint Review Committee on Education in Radiologic Technology New Jersey Radiologic Technology Board of Examiners
Respiratory Care	Commission on Accreditation for Respiratory Care
Surgical Technology	Commission on Accreditation of Allied Health Education Programs Accreditation Review Council on Education in Surgical Technology and Surgical Assisting
Veterinary Technology	American Veterinary Medical Association Committee on Veterinary Technician Education and Activities

Section B. Number of Students Served

1. Number of Undergraduate Students by Attendance Status

Undergraduate Enrollment by Attendance Status, Fall 2020

Full-time		Part-time		Total
N	%	N	%	
5,994	52.5%	5,415	47.5%	11,409

Source: IPEDS Fall Enrollment Survey

Five-Year Unduplicated Enrollment Comparison, Fall 2016 - Fall 2020

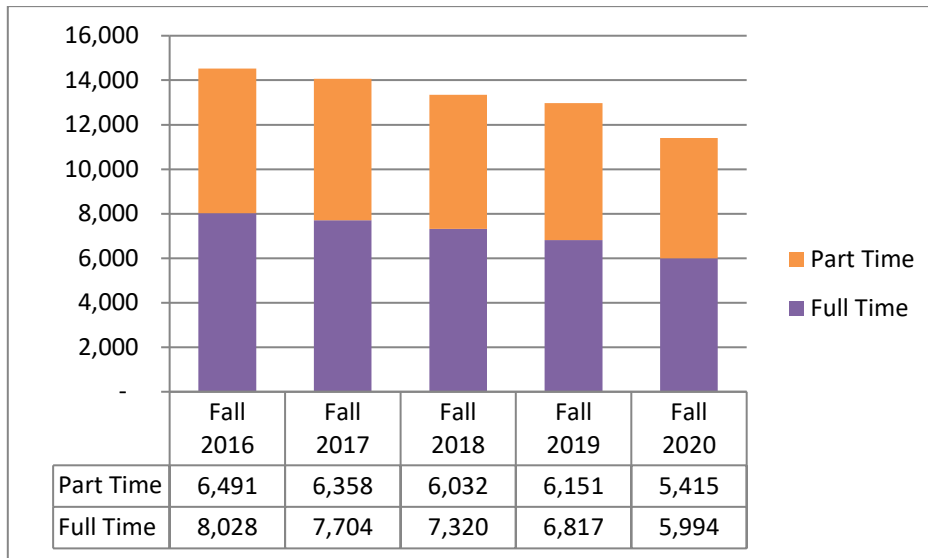

Source: IPEDS Fall Enrollment Survey

2. Number of Graduate Students by Attendance Status

Not applicable to community colleges.

3. Number of Non-Credit Students Served

	Total # of Registrations ¹	Unduplicated Headcount	Total Clock Hours (One Clock Hour = 60 minutes)	Total FTEs ²
Open Enrollment	10,837	5,281	373,460	830
Customized Training	793	-	9,347	21

¹Includes all registrations in any course that started on July 1, 2019 through June 30, 2020.

²FTEs were computed by converting clock hours to credit hours (by dividing by 15), then converting credit hours to FTEs (dividing by 30).

Source: SURE Non-credit Open Enrollment file and NJ IPEDS Form #31, Customized Training.

4. Unduplicated Number of Students for Entire Academic Year

Headcount Enrollment	Credit Hours	FTE
17,685	282,818	9,427

Source: IPEDS 12-Month Enrollment Survey

Section C. Characteristics of Undergraduate Students

1. Mean Math, Reading, and Writing SAT Scores

Not applicable to community colleges.

2. Enrollment in Remediation Courses by Subject Area

Basic skills placement test administered and criteria for selecting test takers in Fall 2020:

Who must take a Basic Skills Placement Test:

- All full-time and part-time students in a degree or certificate program, before registering for all courses.
- All full-time and part-time non-degree seeking students who wish to enroll in English or mathematics courses
- All full-time and part-time non-degree seeking students who have accumulated eleven (11) attempted credits (based on completed courses earning one of the following grades: A, B, C, D, R, E, F, W, AU, Q, N, or INC)

How to be waived from the Basic Skills Placement Test:

- If you hold a Bachelor’s, Master’s, or Doctoral degree from an accredited college or university in the United States.
- If you have passed a college-level English or Mathematics course (other than accounting) in the United States, with a grade of C or higher in English or a grade of D or higher in Mathematics. If you have passed such a course from a country other than the US, please submit a “course by course” evaluation from a current member at NACES (<http://www.naces.org/members.html>). You may be required to take the Accuplacer ESL test.
- If you have taken the SAT examination since March 2016 with a score of 530 or above in math and/or 500 or above in Evidence-Based Reading & Writing (within five years).
- If you have previously taken an Accuplacer exam at another college (within five years), your exam scores can be evaluated for a possible placement test waiver.
- If you have a CLEP exam score of 50 or higher (within five years).
- If you have taken the AP exam in English or mathematics and have a score of 3 or higher.
- If you have a math ACT score of 22 or higher and/or an English ACT score of 20 or higher (within five years).
- If you have TOEFL test scores of 550 or above (paper/pencil version), 213 or above (computerized version) or 80 or above (internet based version) (within two years).
- If you have taken the IELTS examination (academic version) and have a score of 6.5 or above (within two years).
- If you have a PSAT exam score of 480 or higher in Evidence-Based Reading & Writing (within five years).
- If you have a qualifying English PARCC/NJSLA/Regents exam score within five years (PARCC ELA 10 or ELA 11 Exam with 4 or higher, NJSLA ELA 10 Exam with 5 or higher, NJSLA ELA 11 Exam score with 4 or higher, or Regents English with 75 or higher).
- If you have a qualifying Math PARCC/Regents exam score within five years (PARCC Math with 4 or higher, Regents Algebra 2 with 85 or higher).
- If you have a GED Test with a score of 170 or higher on the Math portion.
- If you have graduated High School in the U.S. within the last two years with a GPA of at least 3.0 (and have taken three years of High School English), you may be eligible for a placement test waiver with the submission of your transcript.

Total Number of Undergraduate Students Enrolled in Remediation in Fall 2020:

Total Undergraduate Enrollment	# of Students Enrolled in One or More Remedial Courses	% of Total
11,409	2,017	17.7%

Source: SURE Fall Enrollment file

Total Number of First-Time, Full-Time (FTFT) Students Enrolled in Remediation in Fall 2020:

Total # of FTFT Students	# of FTFT Students Enrolled in One or More Remedial Courses	% of FTFT Enrolled in One or More Remedial Courses
1,608	735	45.7%

Source: SURE Fall Enrollment file

Section C. Characteristics of Undergraduate Students (Continued)

Total Number of First-Time, Full-Time (FTFT) Students Enrolled in Remediation in Fall 2020 by Subject Area:

Subject Area	# of FTFT Enrolled In:	% of all FTFT Enrolled In:
Computation	404	25.1%
Algebra	136	8.5%
Reading	0	0.0%
Writing	0	0.0%
English	565	35.1%

Source: SURE Fall Enrollment file

3. Race/Ethnicity, Sex, and Age

Undergraduate Enrollment by Race/Ethnicity*, Fall 2020

	White		Black		Hispanic		Asian*	
	N	%	N	%	N	%	N	%
Full-time	2,005	33.5%	374	6.2%	2,273	37.9%	560	9.3%
Part-time	1,987	36.7%	377	7.0%	1,594	29.4%	634	11.7%
Total	3,992	35.0%	751	6.6%	3,867	33.9%	1,194	10.5%

	American Ind.		Alien		Race Unknown*		Total	
	N	%	N	%	N	%	N	%
Full-time	17	0.3%	344	5.7%	421	7.0%	5,994	100.0%
Part-time	5	0.1%	156	2.9%	662	12.2%	5,415	100.0%
Total	22	0.2%	500	4.4%	1,083	9.5%	11,409	100.0%

* Note: Asian includes Pacific Islanders and Unknown includes 2 or More Races.

Source: IPEDS Fall Enrollment Survey

Undergraduate Enrollment by Sex, Fall 2020

	Male		Female		Total
	N	%	N	%	N
Full-Time	2,884	48.1%	3,110	51.9%	5,994
Part-Time	2,276	42.0%	3,139	58.0%	5,415
Total	5,160	45.2%	6,249	54.8%	11,409

Source: IPEDS Fall Enrollment Survey

Undergraduate Enrollment by Age, Fall 2020

		LT 18	18-19	20-21	22-24	25-29	30-34	35-39	40-49	50-64	65+	Unk.	Total
Full-time	N	133	2,321	1,711	803	550	220	124	91	31	2	8	5,994
	%	2.2%	38.7%	28.5%	13.4%	9.2%	3.7%	2.1%	1.5%	0.5%	0.0%	0.1%	100.0%
Part-time	N	293	609	1,136	1,156	991	443	292	321	140	23	11	5,415
	%	5.4%	11.2%	21.0%	21.3%	18.3%	8.2%	5.4%	5.9%	2.6%	0.4%	0.2%	100.0%
Total	N	426	2,930	2,847	1,959	1,541	663	416	412	171	25	19	11,409
	%	3.7%	25.7%	25.0%	17.2%	13.5%	5.8%	3.6%	3.6%	1.5%	0.2%	0.2%	100.0%

Source: IPEDS Fall Enrollment Survey

Section C. Characteristics of Undergraduate Students (Continued)

4. Numbers of Students Receiving Financial Assistance Under Each Federal-Funded, State-Funded, and Institution-Funded Aid Program [AY 2019-20 data]

Financial Aid from Federal-Funded Programs, AY 2019-20

	Recipients	Dollars (\$)	\$/Recipient
Pell Grants	5,188	20,147,000	3,883.38
College Work Study	174	435,000	2,500.00
Perkins Loans	0	0	-
SEOG	850	316,000	371.76
PLUS Loans	38	233,000	6,131.58
Stafford Loans - Subsidized	2,107	6,572,000	3,119.13
Stafford Loans - Unsubsidized	2,079	8,088,000	3,890.33
SMART & ACG or other	0	0	-
CARES ACT- HEERF Student Aid	3,321	3,321,000	1,000

Source: NJIPEDS Form #41 Student Financial Aid Report

Financial Aid from State-Funded Programs, AY 2019-20

	Recipients	Dollars (\$)	\$/Recipient
Tuition Aid Grants (TAG)	2,256	4,478,000	1,984.93
Educational Opportunity Fund	252	234,000	928.57
Other State Programs (OSRP & others)	1	1,000	1,000.00
Distinguished Scholars	0	0	-
Urban Scholars	0	0	-
NJSTARS	114	384,000	3,368.42
CCOG	878	1,723,000	1,962.41
NJCLASS	6	66,000	11,000.00

Source: NJIPEDS Form #41 Student Financial Aid Report

Financial Aid from Institutional-Funded Programs, AY 2019-20

	Recipients	Dollars (\$)	\$/Recipient
Grants & Scholarships	311	347,000	1,115.76
Institutional Loans	0	0	-

Source: NJIPEDS Form #41 Student Financial Aid Report

5. Percentage of Students who are New Jersey Residents

Fall 2020 First-Time Undergraduate Enrollment by State Residence

NJ Residents	Non-State Residents	Total	% state Residents
1,908	46	1,954	97.6%

Source: IPEDS Fall Enrollment Survey

Section D. Student Outcomes

1. Graduation Rates

a. Four-, Five- and Six-Year Graduation Rate by Race/Ethnicity

Not applicable to community colleges.

b. Two-Year Graduation Rate of Fall 2017 Full-Time, First-Time, Degree/Certificate-Seeking Students

Fall 2017 Cohort	Graduated after 2 Years	Graduation Rate
2,312	171	7.4%

Source: IPEDS Graduation Rate Survey

c. Three-Year Graduation and Transfer Rate of Fall 2017 Full-Time, First-Time, Degree/Certificate-Seeking Students by Race/Ethnicity

	White		Black		Hispanic	
	N	%	N	%	N	%
Fall 2017 Cohort	831		174		562	
Graduated in 3 years	222	26.7%	28	16.1%	84	14.9%
Transfers	123	14.8%	22	12.6%	87	15.5%

	Asian		Alien		Other *		Total	
	N	%	N	%	N	%	N	%
Fall 2017 Cohort	199		110		436		2,312	
Graduated in 3 years	54	27.1%	26	23.6%	96	22.0%	510	22.1%
Transfers	33	16.6%	9	8.2%	58	13.3%	332	14.4%

*Other includes American Indians, Native Hawaiian & Pacific Islanders, 2 or More Races and Unknown.

Source: IPEDS Graduation Rate Survey

2. Third-Semester Retention of First-Time Undergraduates, Fall 2019 to Fall 2020

a. By Attendance Status

	Fall 2019 First-Time Undergraduates	Retained in Fall 2020	Retention Rate
Full-Time	1,963	1,237	63.0%
Part-Time	581	259	44.6%

Source: IPEDS Fall Enrollment Survey, Part E

	Fall 2019 First-Time Undergraduates	Retained in Fall 2020	Retention Rate
Full-Time	1,963	1,237	63.0%
Part-Time	581	259	44.6%

Source: IPEDS Fall Enrollment Survey, Part E

Section E. Faculty Characteristics

1. Full-Time Faculty by Race/Ethnicity, Sex, Tenure Status and Academic Rank, Fall 2020

		White		Black		Hispanic		Asian*		American Ind.		Alien		Race Unknown*		Total	
		M	F	M	F	M	F	M	F	M	F	M	F	M	F	M	F
Tenured	Professors	37	19	1	2	1	1	1	2	1	0	0	0	1	0	42	24
	Associate Prof.	20	26	1	1	0	1	2	4	0	0	1	0	0	0	24	32
	Assistant Prof.	11	24	0	0	0	3	0	2	0	0	0	0	0	0	11	29
	All Others	1	3	0	0	0	0	0	0	0	0	0	0	0	0	1	3
	TOTAL	69	72	2	3	1	5	3	8	1	0	1	0	1	0	78	88
Without Tenure	Professors	0	0	0	0	0	0	0	0	0	0	0	0	0	0	0	0
	Associate Prof.	1	1	0	0	0	0	0	0	0	0	0	0	0	0	1	1
	Assistant Prof.	4	4	1	0	1	0	2	0	0	0	0	0	0	0	8	4
	All Others	3	16	2	2	1	0	0	0	0	0	0	0	1	0	7	18
	TOTAL	8	21	3	2	2	0	2	0	0	0	0	0	1	0	16	23
Total	Professors	37	19	1	2	1	1	1	2	1	0	0	0	1	0	42	24
	Associate Prof.	21	27	1	1	0	1	2	4	0	0	1	0	0	0	25	33
	Assistant Prof.	15	28	1	0	1	3	2	2	0	0	0	0	0	0	19	33
	All Others	4	19	2	2	1	0	0	0	0	0	0	0	1	0	8	21
	TOTAL	77	93	5	5	3	5	5	8	1	0	1	0	2	0	94	111

* Note: Asian includes Pacific Islanders and Unknown includes 2 or More Races.

Source: IPEDS Human Resources Survey

2. Percentage of Course Sections Taught by Full-Time Faculty, Fall 2020

Course Sections	Taught by FT Faculty		Taught by PT Faculty		Taught by Others*	
	N	%	N	%	N	%
1,814	957	52.8%	802	44.2%	55	3.0%

*Others includes Full-time Administrators and Teaching Assistants

Source: BCC Student Information System

3. Ratio of Full- to Part-Time Faculty, Fall 2020

Full-time		Part-time		Total	
N	%	N	%	N	%
205	26.7%	564	73.3%	769	100.0%

Source: IPEDS Human Resources Survey

Section F. Characteristics of the Board of Trustees

1. Race/Ethnicity and Sex

Sex	White	Black	Hispanic	Asian	American Indian	Non-Res Alien	Unknown	Total
Male	6	1	1	0	0	0	0	8
Female	1	0	1	2	0	0	0	4
Total	7	1	2	2	0	0	0	12

2. List of Trustees with Titles/Affiliations

Name	Title	Affiliation
Dorothy L. Blakeslee, Chair	Chief Operating Officer	Browncoats Consulting LLC
Adam Silverstein, Vice Chair	President	Silver Strategies and Communications Group
Gerald L. Carroll, Secretary	Retired	
Joseph Barreto, Treasurer	High School Guidance Counselor	NYC Department of Education
Louis DeLisio, Trustee	Interim Executive County Superintendent	Bergen County Office of Education
Ritzy Morales-Diaz, Trustee	District Director	Representative Bill Pascrell
Patrick Fletcher, Trustee	Superintendent of Schools	River Dell Regional School District
Krista Flinn, Trustee	Accounts Payable	Old Tappan School District
Mark Longo, Trustee	Director	Engineers Labor-Employer Cooperative
Stephen F. Pellino, Trustee	Partner	Basile Birchwale and Pellino, LLC
Sheetal Ranjan, Trustee	Professor	William Paterson University
Robert Krasowski, Alumni Trustee	Student Alumni	

3. Additional Information about Trustees

Additional information about the BCC Board of Trustees will be available at the Board's page on the Bergen website: <http://bergen.edu/about-us/board-of-trustees/>

Section G. Profile of the Institution

CREDIT PROGRAMS: Transfer (A.A., A.F.A., A.S.)

Associate in Arts (A.A.) Degrees

LIBERAL ARTS

General Curriculum
Cinema Studies
Communication
Economics
History
Literature
Philosophy

Political Science
Psychology
Religion
Sociology
Women's and Gender Studies
World Languages and Cultures

FINE AND PERFORMING ARTS

General Curriculum

Associate in Fine Arts (A.F.A.) Degrees

Music
Theatre

Associate in Science (A.S.) Degrees

NATURAL SCIENCE AND MATHEMATICS

General Science
Aviation Operations
Biology
Biotechnology
Chemistry

Computer Science
Mathematics
Physics

ENGINEERING SCIENCE

Engineering Science

PROFESSIONAL STUDIES

General Curriculum
Athletic Training
Aviation Administration
Broadcasting
Business Administration
Criminal Justice
Education

Exercise Science
Health Science
Information Technology
Journalism
Social Work
Sports Management

Note: The credit program options listed are those programs that were offered in the 2020-2021 Catalog.

Section G. Profile of the Institution (Continued)

CREDIT PROGRAMS: Career (A.A.S. and Cert./COA)

Associate in Applied Science (A.A.S.) Degrees

ART

Computer Animation

Graphic Design

BUSINESS ADMINISTRATION

Accounting

Banking and Finance

BUSINESS TECHNOLOGIES

Hospitality Management

Management Information Systems

Office Technology

FASHION APPAREL DESIGN

Fashion Apparel Design

HEALTH PROFESSIONS

Dental Hygiene

Diagnostic Medical Sonography

Health Science

Medical Informatics

Medical Office Assistant

Paramedic Science

Radiography

Respiratory Care

Veterinary Technology

HUMAN SERVICES

Correctional Studies

Law Enforcement

Paralegal

INDUSTRIAL AND DESIGN TECHNOLOGIES

Drafting and Design Technology

Electronics Technology

Engineering Technology

Manufacturing Technology

INFORMATION TECHNOLOGY

Database Programming & Administration

Networking Administration

Web Development & Management

MUSIC

Music Business

Recording Technology

NURSING

Day

Evening

SCIENCE TECHNOLOGY

Ornamental/Horticulture

Landscape/Design/Build

SOFTWARE DEVELOPMENT

Game Programming

Section G. Profile of the Institution (Continued)

One-Year Certificates

Computer Aided Drafting (CAD)	Hospitality Management
Computer Animation	Landscaping
Computer Graphics	Legal Nurse Consulting
Computer Technical Support	Medical Office Administrative Assistant
Bakery and Pastry Arts	Office Technology
Culinary Arts	Radiation Therapy Technology
Database Programming & Administration	Surgical Technology: Day and Evening
Event Planning and Management	Transfer Studies: Science, Technology, Professional Studies
Exercise Science	
Floral Design	
Grounds Management	

Certificates of Achievement

Baking	Medicinal and Industrial Cannabis
Biotechnology	Network Security
CNC Programming	Non-Profit Management
Fashion Design Fundamentals	Private Security
Fashion Product Development	Professional Cooking
Fire Science	Real Estate
Forensic Science	Sports Management
Homeland Security	Sports Merchandising
Machine Tooling	Welding Technology
Manufacturing Design using Pro/Engineer®	

NON-CREDIT PROGRAMS: Continuing Education

Continuing Education Offerings

Continuing Education (non-credit) course offerings vary from year to year, but are generally offered in the following areas:

Alcohol and Drug Counseling	Law & Public Safety
Baking	Manufacturing & Logistics
Childcare Development Certificate	Marketing
Construction & Project Management Certificate	Online Self-Paced Courses
Construction Administration and Licensing/UCC	Patient Care Technician/Associate Certificate
Construction Management Certificate	Pharmacy Tech
ESL – English as a Second Language	Phlebotomy
Event Planning and Management	Professional Cooking
Fashion Design Programs	Professional Development and Leadership
High School Equivalency for Adults	Project Management
Human Resources	Real Estate
Information Technology	Sustainability and Renewable Energies
Institute for Learning in Retirement	Teacher Education
Interior Design	Workplace Software
Kids and Teens Programs	Workplace Wellness and Safety
Languages & Multicultural Learning	

Section H. Major Research and Public Service Activities

1. Selected Faculty Scholarship, Service Learning, and Community Outreach

Brian Altano presented "Storytelling Show" at Dinner's Ready Live in November 2020 and at Hudson Catholic High School in February 2021.

Mark Altschuler exhibited "Tris and Lefty: An Unlikely Pair" at the Baseball Hall of Fame in Cooperstown, New York in June 2021, and presented it at the Symposium on Baseball and American Culture.

Mark Altschuler has been a member of the Straus Historical Society since 2010. He also volunteered as the Coordinator of Discussions for the Friends of Chautauqua Theater in Summer 2021.

Denise D. Avrutik has been a member of the American Dental Hygienists' Association as well as the New Jersey Dental Hygienists' Association since 1974, and of the American Dental Education Association since 2004. She also volunteered as a Foundation Board Member with Zufall - Smiles for Our Heroes, as well as volunteered as a school coordinator for the Special Olympics Give Kids A Smile Program.

John Bandman presented "The effects of task repetition and feedback on written performance on an integrated listening-to-write task by English as a Second Language ESL college students" at the Bergen Community College Day of Development in April 2021, and presented multiple workshops at the college's Center for Innovation in Teaching and Learning, including on the use of the GroupMe app for text messaging and on the use of Calendly. He also presented a spotlight program on "Champagne, Sparkling Wines, and Cocktails" in May 2021 to the college.

John Bandman has been a member of TESOL.ORG since 2012 and Chaine des Rotisseurs since 2021. This year, he served as Faculty Advisor for the Hospitality Club.

Susan Barnard has been a member of the American Dental Hygienists Association since 1982.

Jacqueline Behn has been a member of the National Association of Social Workers since 1993.

Gregg Biermann's work "New York Gradual" was exhibited at the National Gallery of Art, Washington D.C. in August 2020. Gregg Biermann was also interviewed for "Retracted Cinema" published by Found Footage Magazine in March 2021.

Gregg Biermann serves as the co-President of the Board of Directors of the Film-makers' Cooperative/New American Cinema Group, and has been a member of Film-makers' Cooperative since 2013 and Canyon Cinema since 1999.

Charles Bordogna designed the installation and signage for the ongoing "Permanent Exhibition of African Art" at The African Art Museum of the SMA Fathers in Tenafly, NJ, and presented "Men at Work" at the Men's Conference at Rockpoint Church in North Haledon, New Jersey in June 2021.

Charles Bordogna volunteered as an ESL Instructor with New Hope Community Ministries in Prospect Park during Spring 2021.

Denise Budd published "Charles Mather Ffoulke and Larz Anderson: Dealing and Collecting Tapestries in the Gilded Age" in *Collecting Early Modern Art (1400-1800) in the U.S. South*, ed. Lisandra Estevez in 2021.

Denise Budd presented "Charles Mather Ffoulke and the Emerging Tapestry Market" at *Beyond Borders: The Key for Art Market Power* (University of Lisbon and Ecole Normale Superieure) in November 2020 and "Buying and Selling Tapestries in the Gilded Age: Phoebe Elizabeth Apperson Hearst and Charles Mather Ffoulke" at the College Art Association Annual Conference in February 2021.

Denise Budd has been a member of the College Art Association (CAA) since 2002, of the International Council of Museums (ICOM) since 2019, and of The International Art Market Studies Association (TIAMSA) since 2018. She also volunteered as a lecturer in Bergen Community College's Institute for Learning in Retirement in Fall 2020.

Section H. Major Research and Public Service Activities (Continued)

1. Selected Faculty Scholarship, Service Learning, & Community Outreach (Continued)

James Bumgardner has put together 48 episodes of the Bergenstages Radio Theatre from September 2020 to August 2021. He also put together "Social Distancing: A Musical Revue," "Social Distancing, Too: The Music Continues," and "'Moulin Rouge...and then 2020 Happened," all available on YouTube, WebEx, and at the Bergen Community College Library.

James Bumgardner volunteered as a Team Organizer with the AFSP Out of Darkness Walk in October 2020 and at the New Jersey AIDS Walk in May 2021. He also served as an Adjudicator for the Classical Music/Musical Theatre Scholarship semi-final and final competitions in May 2021.

Mary Chmielewski has been a member of the Association of Surgical Technology since 2010.

Geralyn Collins Eisler served as Reviewer for "Curry/Tempkin Sonography: Introduction to Normal Structure and Function" in 2020.

Geralyn Collins Eisler has been a member of the Society of Diagnostic Medical Sonography since 2012.

Deborah A. Cook has been a member of the American Dental Hygienists' Association as well as the New Jersey Dental Hygienists' Association since 1981. She also volunteered as the Coordinator for Give Kids A Smile Day in February 2021.

Gina Costa presented a panel session "Pivoting Overnight to Virtual Learning as a Result of the Pandemic" at the March 2021 New Jersey Communication Association conference.

Gina Costa has been a member of the Delta Kappa Gamma International Society for Key Women Educators since 2012.

Mary Crosby published both "Augury" and "To Sarah" in the Paterson Literary Review in June 2021, and exhibited "Augury" at The Poetry Center at Passaic County Community College in February 2021.

Mary Crosby served as an essay judge for "Women (re)Writing History" at Bergen Community College in March 2021.

Mary Crosby has been a member of the Academy of American Poets since 2013 and TYCA Northeast since 2011.

Carmen Cruz-Torres presented "Careers in Nursing" at the Perth Amboy School District in June 2021.

Carmen Cruz-Torres has been a member of the National Association of Hispanic Nurses since 2016 and of Certified Nursing Educator since 2014.

Claire Cyriax published "Developing and Implementing an Ambulatory Postanesthesia Care Unit Hand-Off Tool" in the online publication of the Journal of Perianesthesia Nursing in April 2021.

Claire Cyriax has been a member of the American Society of PeriAnesthesia Nurses since 2012. She also volunteered with vaccinations with the New Jersey Medical Reserve Corps (NJMRC) in Spring 2021.

Amy Diaz has been a member of both the American Registry of Radiologic Technologists and the American Society of Radiologic Technologists since 2009.

Ellen Feig has volunteered as a Case Investigator with the NY State Department of Health since October 2020. She has been a member of the Rockland County Democratic Committee since 2019 and a member of the Midwest Modern Language Association since 2012.

Section H. Major Research and Public Service Activities (Continued)

1. Selected Faculty Scholarship, Service Learning, & Community Outreach (Continued)

Gemma Figaro presented "African American Males Can Succeed in Community College" at the New Jersey City University Community College Showcase in June 2021.

Gemma Figaro has been a member of the New Jersey TEFOL since 2021. She also volunteered as the Recording Secretary/Historian for the Early Childhood "Read to Succeed" events in Bergen County as well as volunteered at the College Community Coalition for Student Success College Prospect Night at Teaneck High School.

Eileen Fitzgerald volunteered as the Events Chair for the New York City St. Patrick's Day Parade in March 2021 and volunteered as a Parent Advocate in initial CPSE and ongoing IEP meetings on an ongoing basis. **Aurora Genova** has been a member of the American Council on the Teaching of Foreign Language since 2010 and the National Language Service Corps (NLSC) since 2019. Aurora Genova also volunteered as a translator with the NLSC for a Department of Defense translation project in Winter 2021.

Behdad Ghazaei has been a member of the Phi-Alpha Honor Society since 2005.

Martha Goodwin presented "What Was Learned From Teaching Online During Covid" at the Faculty Development conference in January 2021.

Martha Goodwin has been a member of the New Jersey Educational Association since 2001 and the Mid-Atlantic College Reading Association since 2007.

Linda B. Hall volunteered with Give Kids A Smile Day in February 2021.

Jeffrey Hering published "Central Processing Technician Review Course" with the National Online Academy in February 2021.

Jeffrey Hering has been a member of the American Federation of Teachers since 2014. He also volunteered with the

Peter Iachetti has volunteered with the Knights of Columbus since April 2020.

Thomas Jewell has been a member of the American Forensic Association since 1982.

Leigh Jonaitis served as the National Secretary for the Two-Year College English Association as well as served on the Executive Committee of the Conference on College Composition and Communication.

Melissa Krieger presented "Seeking Equity for Community College Early Childhood Education Students" at the National Association of Early Childhood Teacher Educators (NAECTE) Conference in June 2021.

Melissa Krieger has been a member of the National Association of Early Childhood Teacher Educators (NAECTE) since 2015. She also volunteered as a yoga teacher with the Yoga Alliance.

Jimena Ladino has served on the Board of Directors of the Immigration and American Citizenship Organization (IACO) since 2019, and has been a member since 2008.

Richard Laird has been a member of the American Political Science Association since 2011.

Sharon Mancini has been a member of the American Psychiatric Nurses Association since 2008.

Lisa Mayer, a member of the New Jersey Bar Association since 2019, served as an Appellate Advocacy Judge in the Eugene Gressman Moot Courts Competition at Seton Hall Law School in April 2021.

Section H. Major Research and Public Service Activities (Continued)

1. Selected Faculty Scholarship, Service Learning, & Community Outreach (Continued)

Paul Mindell has exhibited several oil and mixed media paintings at Scott Daniel's Auction and Gallery in High Falls, New York since September 2020, and at SFW Gallery in Rhinebeck, New York since June 2021.

Christina Nemec presented both "Healthy Foods" and "Mental Health and the Return to Campus" at the Faculty Development Conference in April 2021.

Christina Nemec has been a member of the Physicians Committee for Responsible Medicine Food For Life since 2020 and the American Heart Association since 2016. She also volunteered as a Board Member of the Thousand Island Park Foundation and as a Friend of the Thousand Island Park Library.

Danielle Oliveri has been a member of the Board of Certification Athletic Training, the New Jersey State Board Of Medical Licensure - Athletic Training, the National Athletic Trainers Association, and the BLS National Safety Council since 2004.

Jaclyn Park has been a member of the North Jersey Vascular Association since 2015 and the Society of Diagnostic Medical Sonography since 2012.

Joanne Piccininni has been a member of the National Association of Emergency Medical Technicians since 2000.

Lisa Picht has been a member of the New Jersey Veterinary Technician Association since 1997 and the American Veterinary Technician Association since 2007. She also volunteered as a veterinary technician at the Spay/Neuter Clinic in April 2021, and as an advisor at the job fair in May 2021.

Bonnie Fox Platter served as the Board Vice President for SeaWatch Long Branch and as a Trustee for Temple Beth Shalom.

Cynthia Rockafellow has been a member of the American Veterinary Medical Association since 1992 and is also a member of the New Jersey Veterinary Medical Association.

Tomira Rozar presented "Are we in the same boat?" to Bergen Community College Dental Hygiene Alumni in June 2021.

Tomira Rozar has been a member of the American Dental Hygienists Association since 2001.

Mary Ryan has served as an on-call volunteer with the National Multiple Sclerosis Society.

Mazooz Sehwal has volunteered as an interpreter with the Friday Weekly Ceremony since 2015.

Dan Sheehan presented "Tales from Earth Incorporated" at the Galway Fringe Festival in September 2020. He volunteered as a performer at the Elephants for Autism Music Festival in March 2021 and at Make Music Englewood in June 2021.

Joanne Varratos Diamantidis has been a member of the National League for Nursing since 2001. She also volunteered with vaccinations administration with Bergen Community College nursing students in May 2021.

Robert Wiater has been a member of the American Psychological Association since 1972 and the National Education Association since 1971.

Section H. Major Research and Public Service Activities (Continued)

2. Grants Administration

The Office of Grants Administration facilitates development, acquisition, and implementation of grant-funded projects that further the vision, goals, and strategic priorities of Bergen Community College. During FY21, the College won fourteen new and continuing grants, totaling \$6,721,096. The Office also managed/operated eighteen projects totaling \$9,556,010 in grant and matching funds, and submitted 17 new proposals for funding consideration. A few of the more significant projects, either continually funded or newly awarded in FY21 include:

- **American Cancer Society Tobacco Free Campus Project.** This initiative was designed to reduce the amount of smoking and vaping among students. While cigarette smoking has been essentially eliminated on campus, there was a need to reduce vaping and the use of smokeless tobacco and nicotine products by students.
- **State of New Jersey Department of Labor and Workforce Development's Growing Apprenticeship in Nontraditional Sectors (GAINS).** The grant award supports New Jersey employers participating in existing federal and state approved apprenticeships in health care and advanced manufacturing occupations through employer and BCC-sponsored training programs. Up to 500 participants are expected to be served.
- **Scaling Apprenticeships through Sector Based Strategies** is a \$12, million US Department of Labor grant designed to expand the use of health professions apprenticeships across the state of New Jersey, the region, and nationally. Bergen is the lead agency for the NJ Health Professions Consortium comprised of nearly all NJ community colleges, as well as employer, the workforce development system, and other partners.
- **US Department of Education's Child Care Access Means Parents in School (CCAMPIS) Program** grant. The grant supports a 4-year program through Bergen's Child Development Center to serve the child care needs of low-income students enrolled at the Bergen and the broader community served by the College.
- **National Endowment for Humanities Campus Connections** is a two-year planning grant for developing and strengthening Criminal Justice curricula by integrating humanities concepts and issues. Planning and pilot testing allowed for determining the extent to which phase-2 implementation efforts can integrate humanities across the curriculum.
- The **Hispanic-Serving Institutions Science, Technology, Engineering, and Mathematics (HSI STEM) Grant** is a five-year project designed to fulfill the urgent and growing need for STEM professionals in a competitive and global workforce. The project has three goals: (a) to strengthen the learning engagement of STEM students; (b) to broaden the role of 20 partners from four-year colleges, industry, and government agencies to become joint stewards of student success; and (c) to equip STEM students with the financial tools necessary to persist through degree completion.
- The **Title V Developing Hispanic-Serving Institutions Grant** is a five-year award designed to improve the academic success of high-need Hispanic and low-income students, especially during their transition from developmental into college-level courses. The project has three goals: (a) to strengthen the learning engagement of students transitioning from developmental into college-level courses; (b) to energize the overall experience of students transitioning to college-level coursework; and (c) to broaden the role of staff and faculty, with a special attention to 50 gateway course instructors, to become joint stewards of student success.
- The **Transition Program for Students with Intellectual Disabilities 2 (TPSID2) Grant** is a model comprehensive transition and postsecondary education program conducted in collaboration with The College of New Jersey. This second phase will attain four key goals: 1) provide students with LD a strong foundation of essential skills and competencies needed to secure and retain jobs; 2) assist LD students in earning meaningful credentials to help advancement along a career Pathway towards higher-skill, higher-wage opportunities; 3) engage employer partners, supportive services and families; and 4) develop a formal network of post-secondary programs within the region.

Section I. Major Capital Projects Underway in Fiscal Year 2021

Projects Under Design:

- Pool spalling concrete repair
- Lyndhurst rooftop chiller replacement
- Replacement elevator #2 hydraulic piston

Construction Projects Ready to Bid:

- Culinary Building/Parking Deck at CLC
- Soccer Field Bleachers - Phase II
- Softball Field Dugouts/Bleachers - Phase III
- Bi-polar Ionization Hackensack/Lyndhurst

Under Construction:

- Theatre Roof Levels 1 through 3
- Gym Floor Refinishing
- Baseball Field Dugouts/Bleachers (pending Board of Trustees Approval)

Completed Construction:

- One-Stop Renovation/Expansion
- Health Profession Student Quad
- Ender Hall Phase V - Window Replacement
- Bi-polar Ionization - Paramus Campus

Section J. Strategic Planning Goals

Strategic Theme 1: Reimagine Student Experiences

Bergen Community College offers a comprehensive learning environment with individualized services dedicated to guiding students and developing them as independent learners on their unique paths to success.

- Goal: Promote practices that support students in accomplishing their educational goals.
- Goal: Enable students to take ownership of their learning and personal growth.
- Goal: Evaluate emerging curricular practices that promote equity, deep learning, student engagement and personal growth.

Strategic Theme 2: Reimagine Human Talent and Internal Culture

Bergen Community College will invest in its employees through enhanced professional engagement and development opportunities that will prepare them to fulfill the College's vision, mission, values, and strategic initiatives.

- Goal: Foster a collaborative culture that values and respects all Bergen members.
- Goal: Develop internal talent to lead and serve the College community.
- Goal: Delineate and communicate College policies and procedures to promote transparency and cohesion.

Strategic Theme 3: Reimagine Technology

Bergen Community College will invest in and support technology that is secure and reliable. Information technology will continue to enhance efficiency and access while ensuring a user-friendly experience.

- Goal: Enhance information technology to support student learning and the educational experience.
- Goal: Anticipate, plan and support long-term changes in information technology.
- Goal: Implement integrated information technology solutions to improve efficiency of core business processes.

Strategic Theme 4: Reimagine Financial Resources

Bergen Community College will secure robust resources to deliver excellent academic and co-curricular programming. The College will continue to foster a culture of transparency where all stakeholders are responsible for the financial viability of the College.

- Goal: Support student success initiatives and the Completion Agenda.
- Goal: Foster a culture where faculty and staff are responsible for the financial viability of the College.
- Goal: Develop a cohesive alternative revenue stream to supplement the existing funding structure.

Strategic Theme 5: Reimagine Relationships and Partnerships

Bergen Community College will strengthen and expand relationships with education, industry and community partners to support a continuum of lifelong and global learning.

- Goal: Strengthen and broaden relationships with PreK-12 schools and four-year institutions.
- Goal: Partner with community leaders and alumni to advocate for the College.
- Goal: Strengthen connections with regional industries.